

**VIEW A**

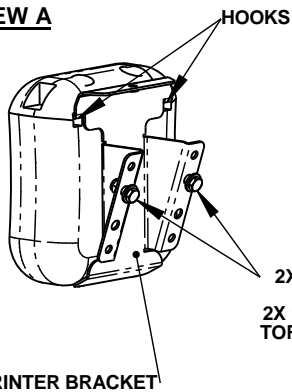

2X 1/4-20 X 3/4 HEX BOLT  
4X 1/4-20 WASHER  
2X 1/4-20 NYLON LOCK NUT  
TORQUE TO 12 FT-LBS ±10%

**VIEW B**

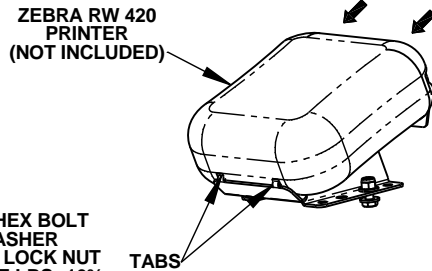

**INSTALLATION INSTRUCTIONS:**

1. USE (2X) 1/4-20 X 3/4 HEX BOLTS, (4X) 1/4-20 WASHERS AND 4X 1/4-20 NYLON LOCK NUTS TO FASTEN DOWN THE PRINTER MOUNT TO THE DESIRED MOUNTING SURFACE. TORQUE FASTENERS, AS SHOWN IN VIEW A.
2. ALIGN PRINTER TO PRINTER MOUNT BY SLIDING PRINTER MOUNT HOOKS INTO THE SLOTS OF PRINTER, AS SHOWN IN VIEW A.
3. WITH THE PRINTER MOUNT HOOKS FULLY ALIGNED IN THE PRINTER SLOTS, SLIDE THE PRINTER FORWARD SO THAT THE TABS OF THE MOUNT ENGAGE THE TAB SLOTS IN THE PRINTER, AS SHOWN IN VIEW B.
4. TO LOCK PRINTER IN PLACE, ALIGN THUMB SCREW IN THE LOCKING PLATE WITH THREADED PEM INSERT IN THE MOUNTING BRACKET, AS SHOWN IN VIEW C. FASTEN THE THUMB SCREWS FINGER TIGHT.
5. PRINTER MOUNT CAN ALSO BE MOUNTED ONTO A C-HDM-200 SERIES USING THE C-HDM-416. IT CAN BE PLACED EITHER VERTICALLY OR HORIZONTALLY, AS SHOWN IN VIEW D AND VIEW E.
6. WHEN C-HDM-416 IS USED, SEE C-HDM-416 INSTALLATION INSTRUCTION SHEET FOR DIRECTIONS.

**VIEW C**

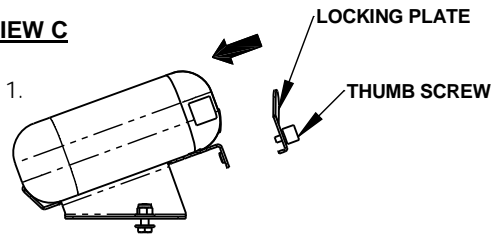

**VIEW D**

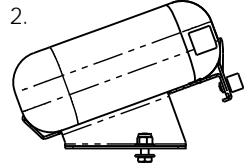
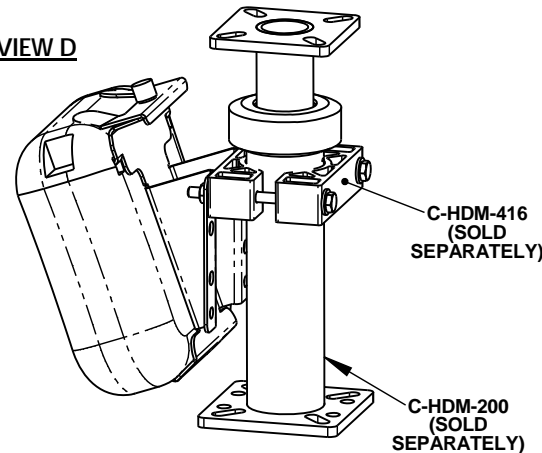

**VIEW E**

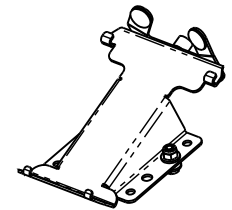
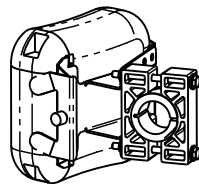

**HARDWARE KIT CONTENTS:**

| DESCRIPTION   | QTY. |
|---|------|
| HEX BOLT - 1/4-20 X 3/4"                              | 2    |
| NUT - NYLON-INSERT - 1/4-20 - 7/16" W - 5/16" H       | 2    |
| WASHER, 1/4" SAE FLAT, 9/32"ID, 5/8"OD, .051-.080"THK | 4    |

|                                 |                         |
|---------------------------------|-------------------------|
| PRODUCT I.D.<br><b>C-PM-106</b> | DATE<br><b>07-20-10</b> |
|---------------------------------|-------------------------|

|  |
|--|
| PRODUCT NAME<br><b>ZEBRA PRINTER MOUNT</b> |
|--|

**DRAWING NUMBER:  
C-PM-106\_INST**

WARNING: ALL HAVIS PRODUCTS ARE DESIGNED WITH SAFETY OF USE AND INSTALLATION IN MIND. HOWEVER, IT IS THE SOLE RESPONSIBILITY OF THE OWNER/OPERATOR OF A VEHICLE USING HAVIS MOUNTING AND DOCKING EQUIPMENT, TO INSURE THAT THE EQUIPMENT IS INSTALLED SO THAT IT WILL NOT INTERFERE WITH VEHICLE OPERATION, INTERFERE WITH SAFETY DEVICES, OBSTRUCT VIEW OF DRIVING CONDITIONS, OR IN ANY WAY DEGRADE OCCUPANT SAFETY. IMPROPER INSTALLATION CAN CAUSE SERIOUS INJURY IN THE EVENT OF AN ACCIDENT. INSTALLATION SHOULD ONLY BE PERFORMED BY QUALIFIED PROFESSIONALS. COMPUTERS AND MOTION DEVICES MUST BE MOVED TO AND STOWED/SECURED IN THEIR SAFE DRIVING POSITIONS BEFORE OPERATING VEHICLE.

**PRODUCT DESCRIPTION**

**PRINTER MOUNT FOR THE ZEBRA RW 420 PRINTER. CAN BE MOUNTED TO C-HDM-200 SERIES WITH A C-HDM-416, OR DIRECTLY ONTO C-TMW.**

|              |                              |
|--------------|------------------------------|
| <b>HAVIS</b> | WEIGHT: (LBS)<br><b>0.96</b> |
|              | REV. DATE<br><b>07-21-10</b> |