

INSTALL INSTRUCTIONS

C-DMM-2016 Dash Monitor Mount

2013-2019 Ram 1500 Special Services Police & 1500 Tradesman Pickup Truck

2013-2019 Ram 1500, 2500, 3500 Retail Pickup Truck with "Classic" Body style

****Compatible with 3-Inch and 5-Inch Radio Display ONLY (Sales codes RA1, UA1, RA2, UAA)****

TOOLS REQUIRED:

- Ratchet Wrench
- Socket Set
- 7/16", 13mm Open End Wrenchs
- T-20 Torx bit
- Phillips Screwdriver (short)
- Dash panel removal tool
- Wire strippers/cutters

MOUNT BRACKET PARTS and HARDWARE: *(Some parts will come preassembled to frame assembly)*

QTY:	DESCRIPTION:	PART #:
1	Main Frame	CM009631
1	Driver side mount	CM009612
1	Passenger side mount	CM009613
2	Side support bracket	CM009614
2	1/4" x 3/4" Carriage bolts	GSM32000
2	Nylon 1/16" spacer washer	CM86600
2	1/4" Nylock nut	GSM30016
2	1/4" Steel flat washer	GSM31005
4	1/4" Star washer	GSM31035
4	1/4"x 1/2" Phillips pan head bolt	GSM33123
4	1/4"x 1/2" Flat head bolt	GSM34057
2	1/4"x 3/4" Hex head bolt	GSM33001
4	8-32 Keps nut	GSM30027
1	Pivot / display mount bracket	MT-0320-SA
1	Tilt swivel hinge	GSM22005
1	VESA rotator plate	CM010471
1	PVC washer	CM010648
1	Vinyl cap (.50" high x .312 - .375 id)	GSM41127
1	M8 hex nut SS	GSM30113
1	M8 lock washer SS	GSM31217
2	M5 x 10mm Thread forming screw	GSM33774
2	Pull through bumper (3mm head)	GSM21109
2	Push in bumper (10mm head)	GSM21108
1	Loctite (removable medium strength)	GSM20075

Notes:

1. The C-DMM-2000 series Dash Monitor Mount brackets are specifically designed to work with Havis, Inc, model # TSD-101 Touch Screen Display.
2. The display mount bracket includes a VESA 75 hole pattern that can also be used for some light weight tablet docking station applications under 5 lbs. . Acceptable positioning must be determined by end user.
3. Does NOT work with 8.4", 12" radio displays with the following Sales codes:
UAS, UAM, UAQ, UAV and UAX

ALWAYS!

- Read all instructions before installing any Havis, Inc products.
- Use hardware provided with install kit

C-DMM-2016 assembly

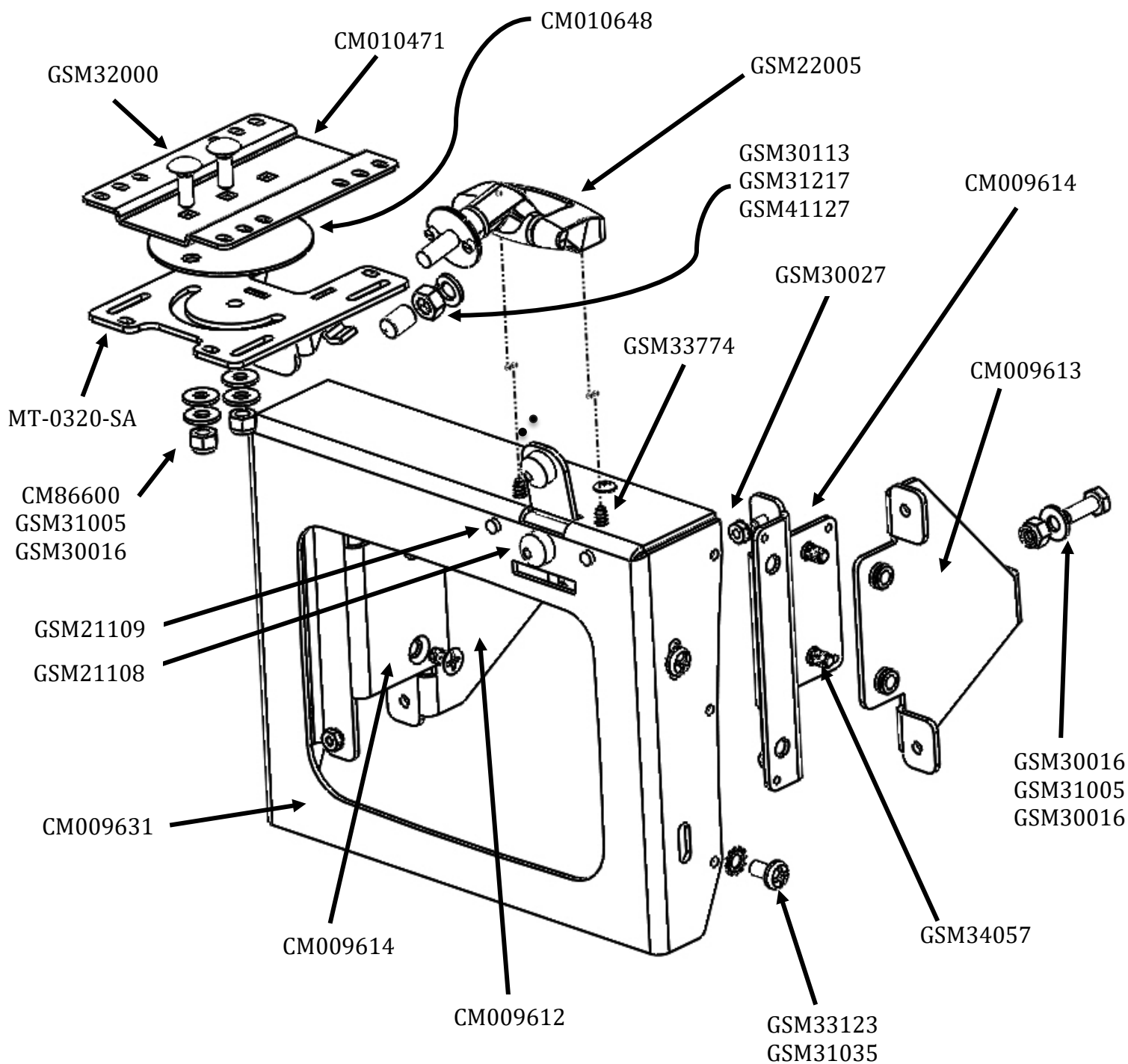



Dodge Ram Pickup dash with Uconnect® 3 Radio with 5-Inch Display prior to installation.



Remove rubber liner in lower right dash pocket and Remove screw. (T20 Torx bit)



Remove rubber liner and remove screws in upper center coin tray. (T20 Torx bit)

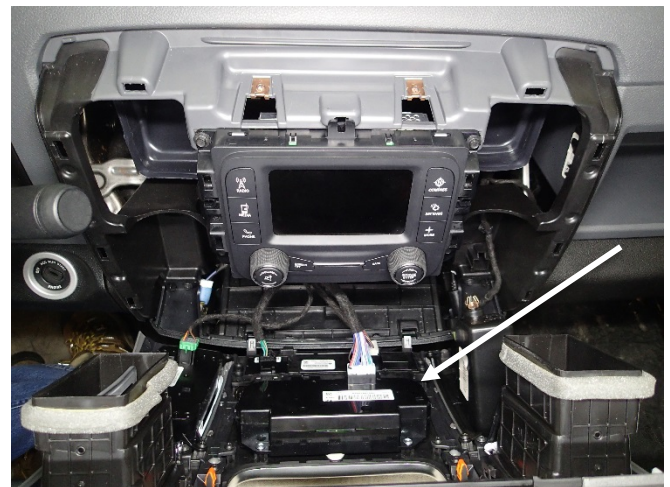

Carefully partially remove center instrument panel. This does not need to be unplugged.

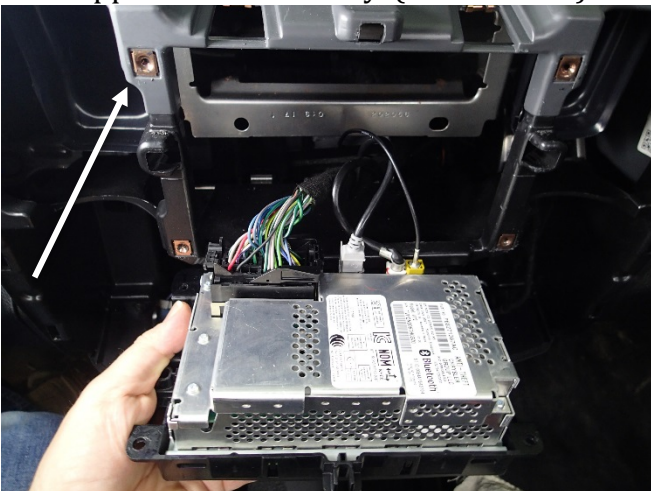

Remove radio mount screws, unplug and remove radio control. (7mm socket)

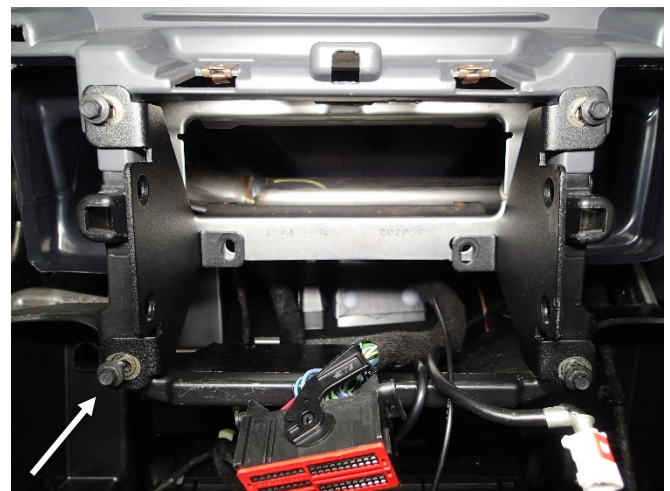

Loosely attach driver and passenger side mount brackets (CM009612 & CM009613) to radio mount holes with OEM radio mount screws.



Attach driver and passenger side mount brackets to inner OEM frame with 1/4"x 3/4" hex head bolts, flat washers and nylock nuts.



Tighten mount bracket hardware and snap center instrument panel back into place with three (3) previously removed OEM screws.. Brackets will come out through sides of radio opening.



Attach side support bracket to driver side mount bracket with 1/4"x 1/2" flat head bolts.
Note: Use a drop of Loctite on each bolt.



Attach side support bracket to passenger side mount bracket with 1/4"x 1/2" flat head bolts.
Note: Use a drop of Loctite on each bolt.



Plug radio back in and attach to support brackets with 8-32 Keps nuts. (11/32" socket)



Place frame & hinge assembly onto support brackets and make sure it fits around radio properly.



Attach frame with 1/4" x 1/2" pan head bolts and star washers. Two each side.



Connect harnesses to the back of the TSD-201 display. It is important to also double wire tie the harnesses to provide sturdy strain relief for the plugs.



Attach pivot / display mount bracket to display with M4 x 0.7 x 10mm Phillips head machine screws, lock washers and flat washers. Display mount hardware is included with TSD-201 hardware kit



Attach bracket with display to the tilt swivel hinge with M8 hex nut and lock washer. Tighten nut and attach vinyl cap on M8 bolt threads. (13mm socket)



Refer to TSD-201 owner's manual for power and computer connection details.
Route wire harness down the side of DMM frame or cut hole through top coin tray for wires if desired.



Installation of C-DMM-2016 with TSD-201 complete.