

INSTALL INSTRUCTIONS

C-DMM-2018 Dash Monitor Mount

Ford 2020-2022 Interceptor Utility

Notes:

1. *The C-DMM-2000 series Dash Monitor Mount brackets are specifically designed to work with Havis, Inc, model # TSD-201 Touch Screen Display.*
2. *The display mount bracket includes a VESA 75 hole pattern that can also be used for some light weight tablet docking station applications under 5 lbs. . Acceptable positioning must be determined by end user.*
3. *The C-DMM-2018 will work with all Havis, Inc. consoles made for the Interceptor Utility.*

TOOLS REQUIRED: *(some tools are not needed for all vehicle installations)*

- Socket set - metric & standard
- Phillips screwdriver

MOUNT BRACKET PARTS and HARDWARE:

QTY:	DESCRIPTION:	PART #:
1	Main dash mount bracket	CM009910
1	Pivot / display mount bracket	MT-0320-SA
1	Dash clamp bracket	CM009911
1	VESA rotator plate	CM010471
1	PVC washer	CM010648
2	1/4" x 3/4" Carriage bolts	GSM32000
2	1/4" Nylock nut	GSM30016
4	1/4" Flat washer	GSM31005
2	Nylon 1/16" spacer washer	CM86600
1	Tilt swivel hinge	GSM22005
1	M8 hex nut SS	GSM30113
1	M8 lock washer SS	GSM31217
2	Machine Screw 10-32 x 1/2"	GSM33118
2	#10 Star washer	GSM31034
1	Vinyl cap (.50" high x .312 - .375 id)	GSM41127
2	M5 x 10mm Thread forming screw	GSM33774
2	Pull through bumper (3mm head)	GSM21109
3	Push in bumper (10mm head)	GSM21108
2	M5 x 30mm Machine screw	GSM33792
2	Plastic spacer	GSM34616
1	Vinyl cap	GSM41123

C-DMM-2018 assembly

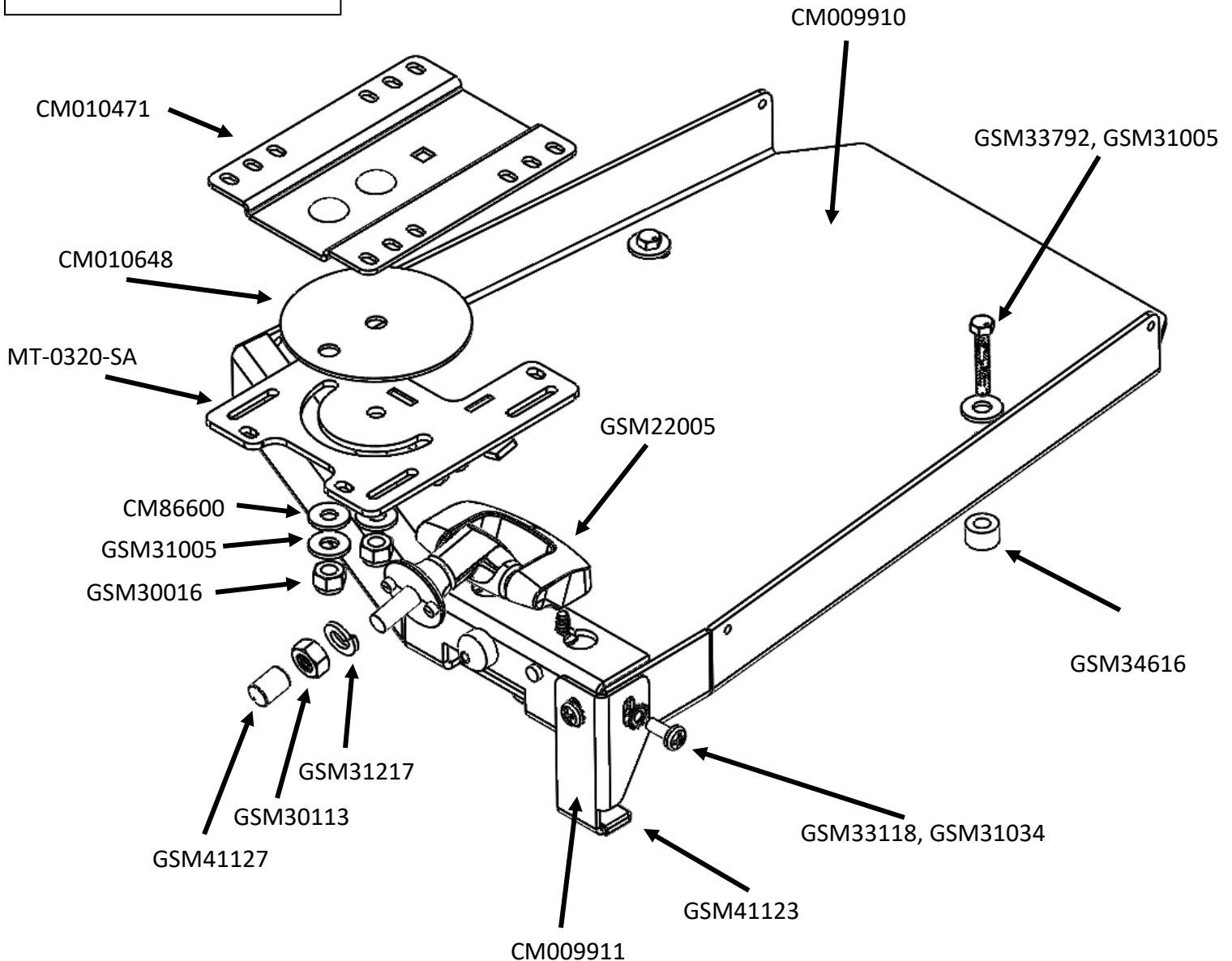

ALWAYS!

- Read all instructions before installing any Havis, Inc products.
- Use hardware provided with install kit



View of Interceptor Utility before installation

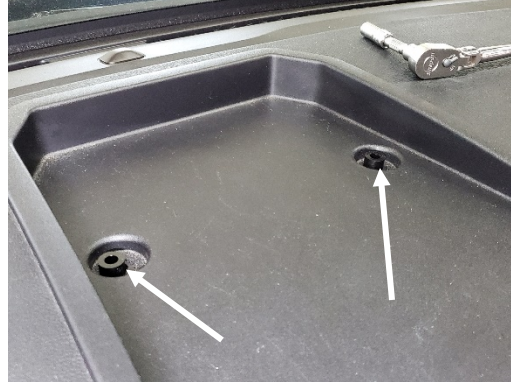

Remove OEM fasteners from upper dash pocket. Place plastic spacers over openings.
7mm socket



Place DMM tray in place and attach using M5 x 30mm bolts and 1/4" washers.
8mm socket



Repeat process for other side.



Attach dash clamp support bracket to Main bracket with 10-32 x 1/2" machine screws and star washers.



Connect harnesses to the back of the TSD-201 display. It is important to also double wire tie the harnesses to provide sturdy strain relief for the plugs.



Attach pivot / display mount bracket to display with M4 x 0.7 x 10mm Phillips head machine screws, lock washers and flat washers. Display mount hardware is included with TSD-201 hardware kit



Attach bracket with display to the tilt swivel hinge with M8 hex nut and lock washer. Tighten nut and attach vinyl cap on M8 bolt threads.



Refer to TSD-201 owner's manual for power and computer connection details.