

INSTALLATION INSTRUCTIONS

C-DMM-3014 Flip up Dash Monitor Mount

2019 - 2022 Ford Ranger Pickup Truck *(All Models)*

TOOLS REQUIRED:

- Ratchet Wrench
- Socket Set
- 7/16" Open End Wrench
- Phillips Screwdriver (short)
- Dash panel removal tool
- Wire strippers/cutters

HARDWARE and PARTS:

<u>QTY</u>	<u>DESCRIPTION</u>	<u>PART#</u>
1	Driver upper mount bracket	CM009702
1	Passenger upper mount bracket	CM009701
1	Passenger lower mount bracket	CM009704
1	Top clamp bracket	CM009703
1	VESA rotator plate	CM010471
2	1/4" x 3/4" Carriage bolts	GSM32000
1	PVC washer	CM010648
2	1/4" Nylock nut	GSM30016-1
2	1/4" Plastic flat washer	CM86600
2	1/4" Steel flat washer	GSM31005
6	10-32 x 1/2" Phillips pan head machine screw	GSM33118
6	#10 flat washer	GSM31003
1	10-32 Keps nut	GSM30028

Notes:

1. The C-DMM-3000 swivel plate accepts C-MM-301 offset bracket used with C-MM-2XX adaptors.
2. C-MM-2XX series adaptor brackets are not needed for most VESA 75 and other Havis Docking Station mounting applications.
3. CM010471 VESA rotator plate gives additional positioning options, but is not required depending on mounting preference.

ALWAYS!

- Read all instructions before installing any Havis, Inc products.
- Use hardware provided with install kit

C-DMM-3014
Assembly

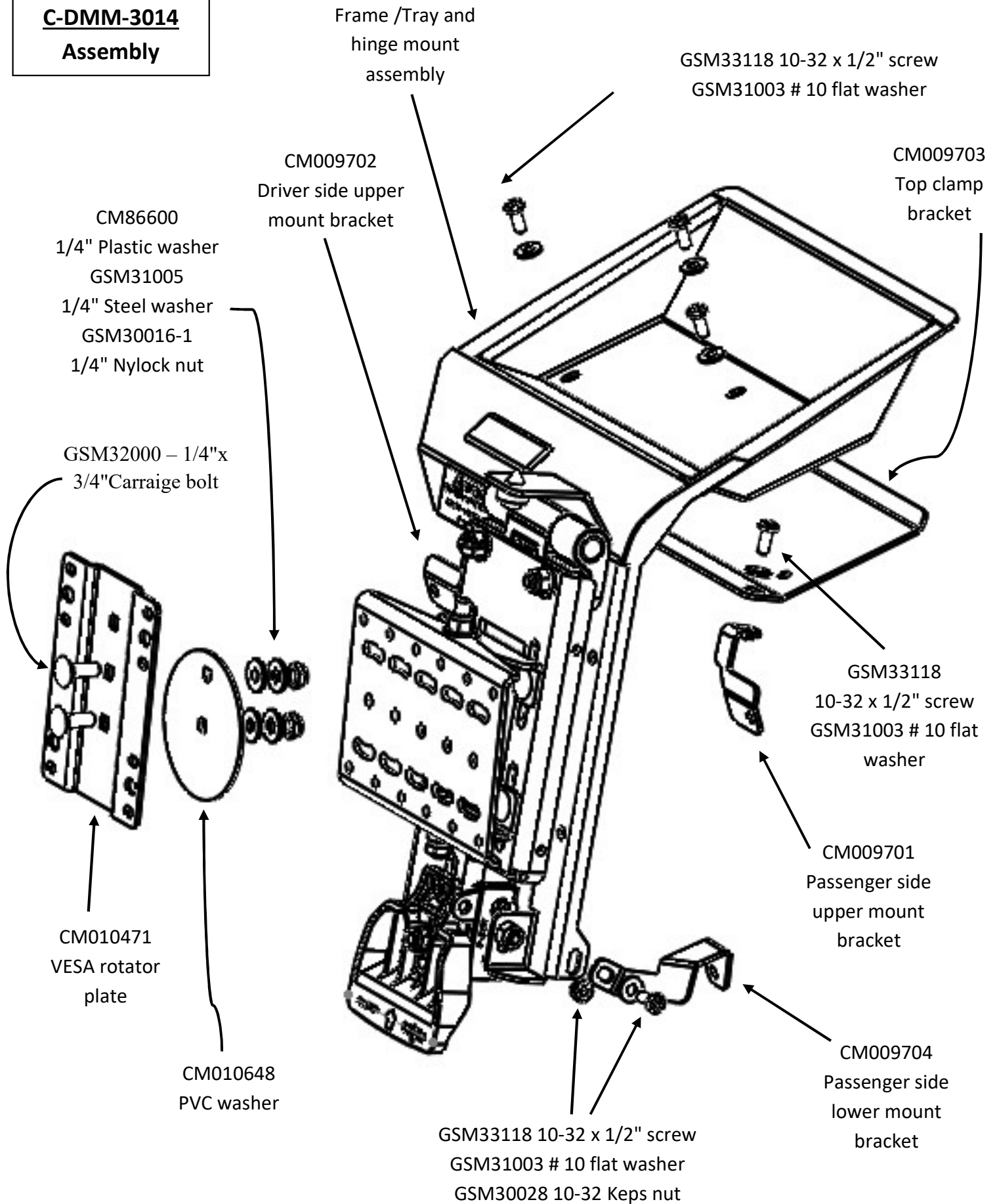



2019 Ford Ranger center instrument panel prior to installation.



Carefully unsnap and remove the center top dash tray with panel removal tool.



Carefully unsnap and remove driver side vent and trim next to steering column.



Carefully unsnap and remove passenger side vent and trim assembly.



Carefully unsnap and remove lower dash trim.



Temporarily remove upper driver side OEM display mount screw (7mm socket)



Temporarily remove upper passenger side OEM display mount screw (7mm socket)



Slide passenger side upper mount bracket (**end with no threaded hole**) down from tray opening and position bracket behind passenger side OEM display mount. Do the same for driver side.



Reattach OEM display and upper brackets with previously removed OEM mount screws. (7mm socket)



Slide top clamp bracket into the tray opening underneath the plastic cross support.

NOTE: The bent flange of bracket must be towards REAR of vehicle.

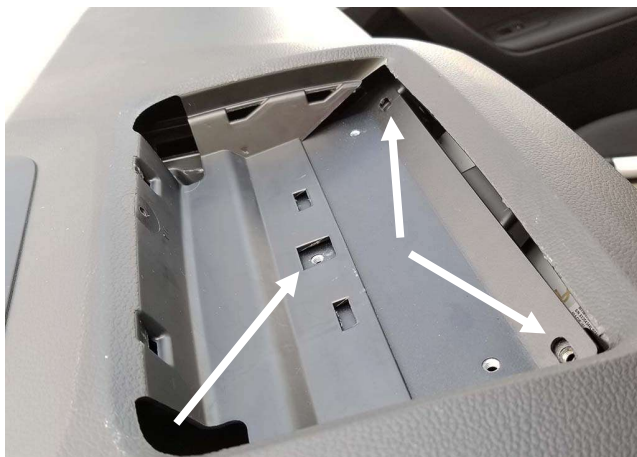

The top clamp bracket slotted holes in bent flange should line up with upper mount bracket threaded holes. The clamp bracket forward threaded hole should line up with the cross support center square hole.



Attach the top clamp bracket to upper mount brackets with 10-32 x 1/2" Phillips machine screws and #10 flat washers.



Remove lower passenger side OEM display mount screw and attach passenger side lower mount bracket with OEM screw. (7mm socket)



Carefully reattach all dash trim panels.



View of passenger side lower mount bracket coming out through small gap underneath vent trim.



Place frame / tray and hinge mount assembly on to dash tray opening and align mount holes with top clamp bracket holes.



Attach frame / tray assembly to top clamp bracket with 10-32 x 1/2" Phillips machine screws and #10 flat washers.



Attach frame / tray assembly to lower bracket with 10-32 x 1/2" Phillips machine screw #10 flat washer and 10-32 nut. Nut goes on the inside of frame.



Main frame assembly is now in place.
Double check all hardware and make sure
trim is properly attached.

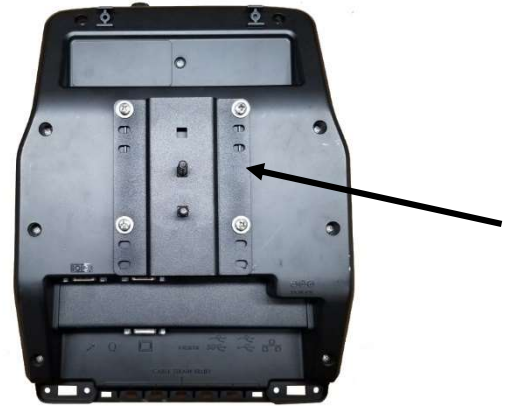

Position VESA plate on back of Device as desired.
Attach VESA plate with carriage bolts to the back
of the dock. The gray PVC washer will go
between this bracket and the DMM swivel plate.



Determine desired position for your specific computer
and attach to DMM swivel plate using 1/4"x 3/4" carriage
bolts, PVC spacer, nylon washers, steel washers, and
nylock nuts. Tighten so that the dock rotates smoothly.



Route wiring along the side of the DMM flip up frame using
existing holes and wire ties.
Test up / down and side to side motion to confirm wires have
adequate slack and strain relief.



Check and adjust positioning as desired.
Test for proper latching in closed position.



Dock the computer and test.
Installation is now complete.