

MD-130 SERIES MODELS

REV.	DESCRIPTION	DATE
6-17	RELEASED TO PRODUCTION	6-17

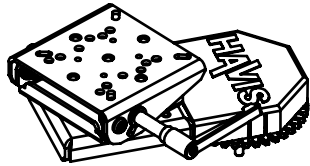

C-MD-131

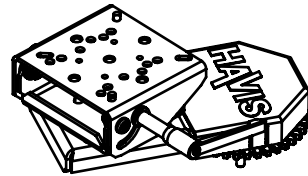

C-MD-132

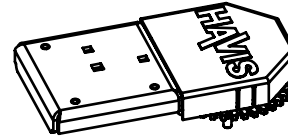

C-MD-133

SURFACE MOUNTING INSTRUCTIONS

MD-130 SERIES MOTION DEVICES CAN BE MOUNTED TO ANY FLAT SURFACE, INCLUDING CONSOLE TOPS AND HDM POLES. IF SURFACE DOES NOT HAVE PREDRILLED HOLES, USE THE DRILL TEMPLATE TO THE RIGHT.

- PLACE MD-130 SERIES ON TOP OF MOUNTING SURFACE, ALIGNING THE (4) PEM STUDS ON THE BASE WITH THE (4) 1/4" HOLES THROUGH MOUNTING SURFACE.
- INSTALL THE (4) HEX NUTS ONTO THE STUDS AS SHOWN IN THE DIAGRAM BELOW.
- TIGHTEN ALL HARDWARE.

DRILL TEMPLATE
(ACTUAL SIZE)

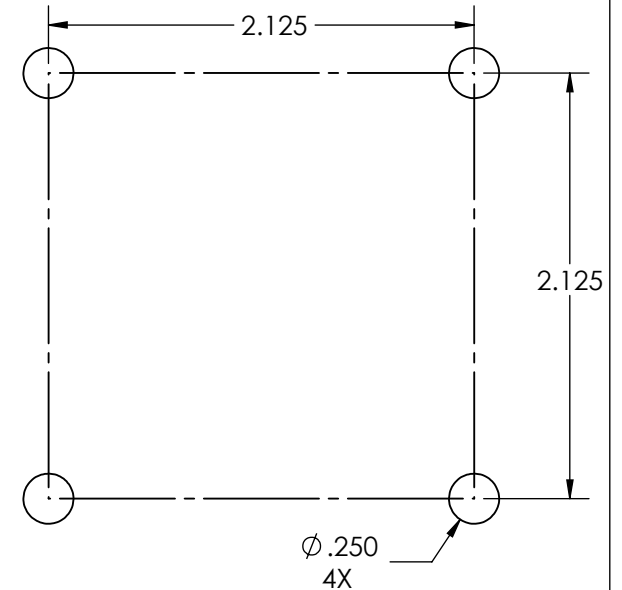

HAVIS HDM-200 SERIES POLE SHOWN (NOT INCLUDED)

1/4-20 HEX NUT
(GSM30023)

1/4-20 PEM STUDS

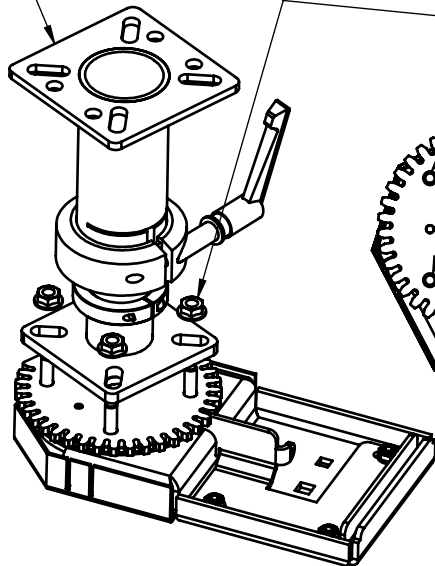

VIEW FROM BOTTOM FOR CLARITY

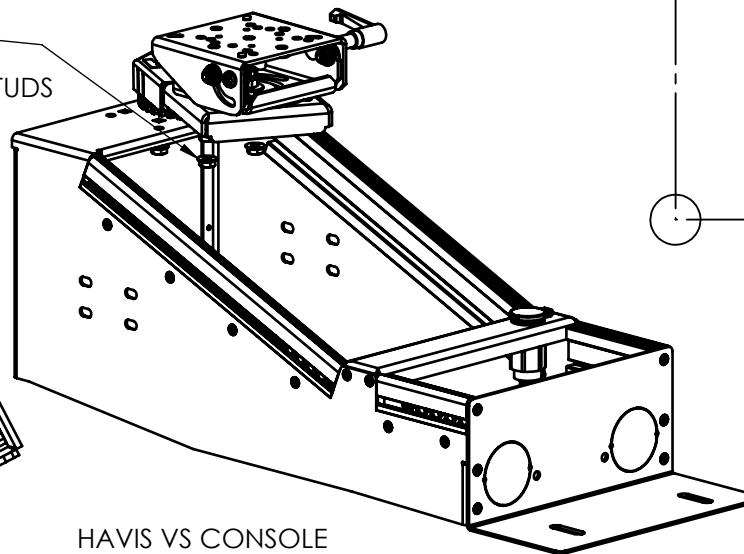

HAVIS VS CONSOLE
SHOWN (NOT INCLUDED)

HAVIS HAVIS, INC.		75 JACKSONVILLE RD. WARMINSTER, PA. 18974 1-800-524-9900
TITLE: MD-130 SERIES INSTRUCTIONS		
DO NOT SCALE DRAWING		
SIZE A	DWG. NO. C-MD-INST-5	REV 6-17
WEIGHT (LB): 6.23	SCALE: 1:0.9586	SHEET 1 OF 3

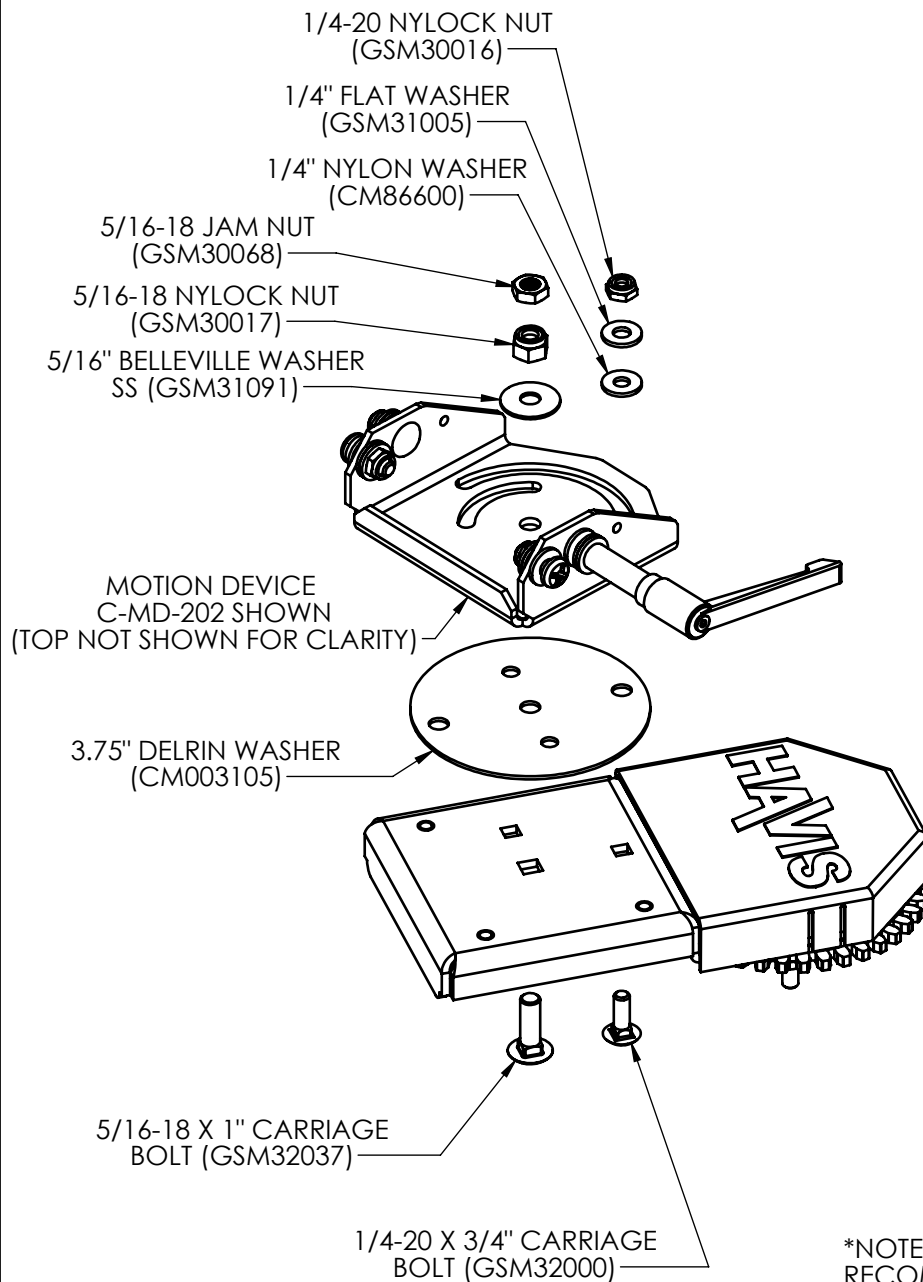

MOTION DEVICE INSTALLATION (C-MD-131, C-MD-132, C-MD-133)

- SELECT DESIRED CARRIAGE BOLT PATTERN FROM THE POSITIONS SHOWN BELOW.
- INSERT CARRIAGE BOLTS FROM BOTTOM THROUGH MOTION DEVICE BASE. USE THE BOLT PATTERN BELOW THAT CORRESPONDS WITH THE DESIRED ROTATION OF DEVICE.
- INSTALL WASHERS, NUTS, AND JAM NUTS FOLLOWING THE ORDER SHOWN IN THE EXPLODED VIEW TO LEFT.
- REFER TO USER ADJUSTMENTS PAGE FOR INFORMATION ON ADJUSTING ROTATIONAL FORCE OF DEVICE.

CARRIAGE BOLT PATTERNS:

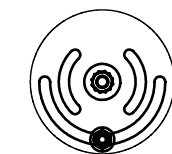

STANDARD
180° ROTATION
(AS SHIPPED)

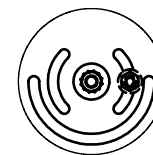

OPTIONAL
90° ROTATION
(USE 1/4"
HARDWARE AS SHOWN)

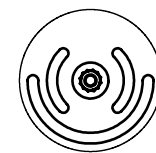

OPTIONAL
*360° ROTATION
(DO NOT USE 1/4" HARDWARE)

*NOTE: OPTIONAL 360° MOUNTING IS NOT RECOMMENDED FOR MOUNTING DEVICES HEAVIER THAN A KEYBOARD.

HAVIS HAVIS, INC. 75 JACKSONVILLE RD. WARMINSTER, PA. 18974 1-800-524-9900		
TITLE: MD-130 SERIES INSTRUCTIONS		
DO NOT SCALE DRAWING		
SIZE A	DWG. NO. C-MD-INST-5	REV 6-17
WEIGHT (LB): 5.35	SCALE: 1:3	SHEET 2 OF 3

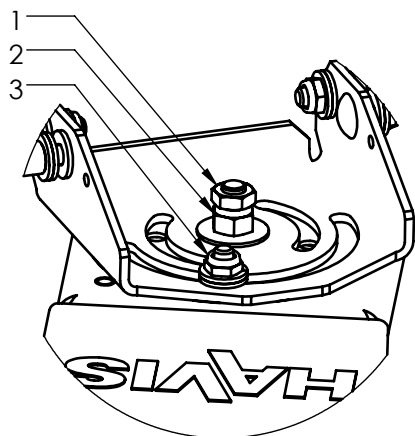
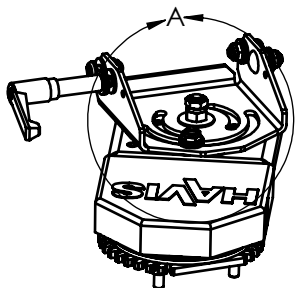

DETAIL A

USER ADJUSTMENTS

MOTION DEVICE ROTATION

NOTE: TILT/SWIVEL MOTION DEVICE SHOWN. OTHER MOTION DEVICES MAY BE SUBSTITUTED.

USING A 1/2" SOCKET, LOOSEN NUT 1 AND ADJUST NUT 2 WITH A 1/2" OPEN END WRENCH AS REQUIRED TO ACHIEVE CUSTOMER DESIRED ROTATIONAL FORCE OF MOTION DEVICE. RETIGHTEN NUT 1 WITH A 1/2" SOCKET WHILE RESTRICTING NUT 2 FROM TURNING WITH A 1/2" OPEN END WRENCH.

FOR MINOR ADJUSTMENT, TIGHTEN OR LOOSEN NUT 3 USING A 7/16" SOCKET.

UNIT ROTATION

REMOVE PLASTIC COVER BY PULLING UPWARDS TO UNSNAP SIDE CLIPS. USING A 1/2" SOCKET AND 1/2" OPEN END WRENCH AS DESCRIBED ABOVE IN "MOTION DEVICE ROTATION" SECTION, ADJUST AS REQUIRED TO ACHIEVE THE DESIRED ROTATION FORCE OF MOTION DEVICE WHEN RELEASE LEVER IS PULLED. REINSTALL PLASTIC COVER BY PUSHING DOWNWARD TO ENGAGE CLIPS.

PLASTIC COVER NOT SHOWN IN THIS VIEW

JAM NUT ASSEMBLY SIMILAR TO ABOVE

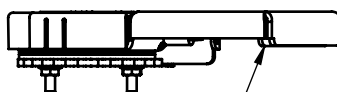
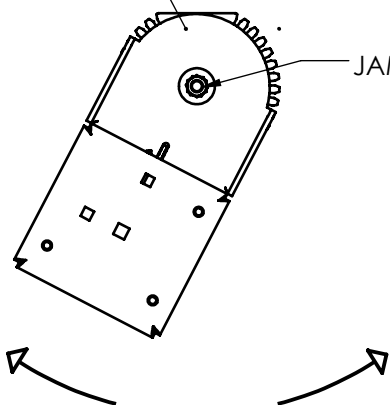

RELEASE LEVER

HAVIS HAVIS, INC.		75 JACKSONVILLE RD. WARMINSTER, PA. 18974 1-800-524-9900
TITLE: MD-130 SERIES INSTRUCTIONS		
DO NOT SCALE DRAWING		
SIZE A	DWG. NO. C-MD-INST-5	REV 6-17
WEIGHT (LB): 3.27	SCALE: 1:5	SHEET 3 OF 3