

ITEM NO.	QTY.	PART NUMBER	DESCRIPTION
1	1	10-005565	WASHER, ARBITRATOR MOUNT
2	2	10-010312	BRKT, CAMERA MOUNT, HEADLINER, OHB BASE INUT
3	1	10-010313	BEAM, CAMERA MOUNT
4	2	GSM33118	SCREW,10-32 X 1/2 PPHMS,ZP
5	4	CM93084	RUBBER BUMPER
6	2	GSM31003	WASHER #10 FLAT BLACK
7	2	GSM31025	WASHER #10 LOCK ZP

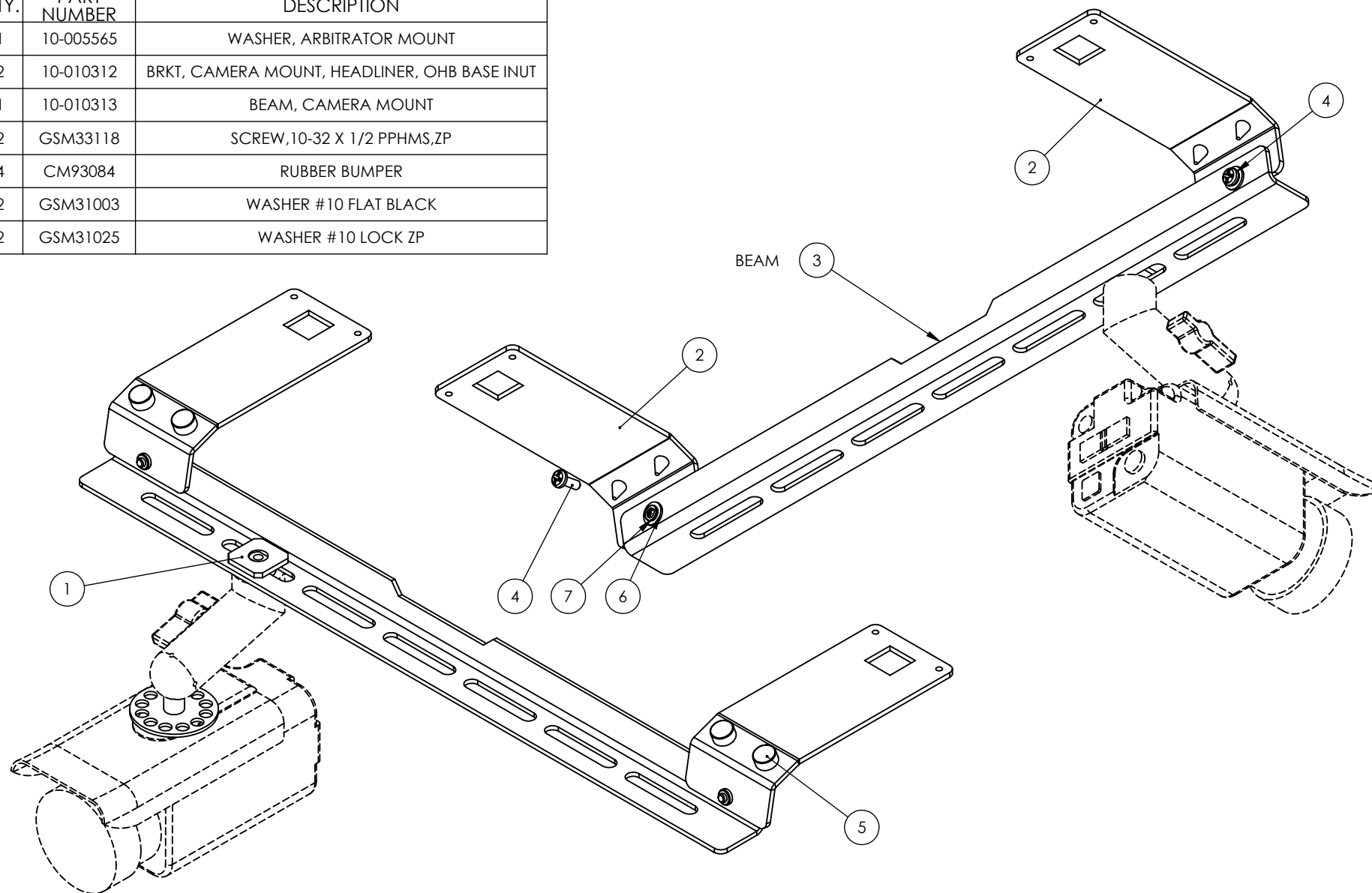

INSTALLATION

1. REMOVE OEM VISOR CLIPS FROM HEADLINER.
2. ATTACH RUBBER BUMPERS TO CAMERA BRACKETS.
3. PLACE CAMERA MOUNT BRACKETS BETWEEN HEADLINER AND ROOF OF VEHICLE, POSITIONING SO THAT THE CENTER SLOTS ALIGN WITH THE LONG TABS AND MOUNTING HOLES ON THE OEM VISOR CLIPS.
4. LOOSELY ATTACH BEAM BETWEEN THE TWO BRACKETS.
5. REINSTALL VISOR CLIPS WITH OEM HARDWARE.
6. TIGHTEN BEAM SCREWS.
7. INSTALL AND SECURE CAMERA IN DESIRED POSITION.

HAVIS HAVIS, INC.		75 JACKSONVILLE RD. WARMINSTER, PA. 18974 1-800-524-9900
TITLE: ARBITRATOR CAMERA MOUNT INSTALLATION, INTERCEPTOR UTILITY 2020		
DO NOT SCALE DRAWING		
SIZE A	DWG. NO. C-OHB-106-INST	REV 1-20
WEIGHT (LB): 3.47	SCALE: 1:3	SHEET 1 OF 1