

INSTALLATION:

1. REMOVE REAR CARGO FLOOR AND SET ASIDE
2. REMOVE 2 BOLTS HOLDING FORWARD CARGO FLOOR
3. LIFT FORWARD CARGO FLOOR AND FOAM, AND SLIP FORWARD BRACKETS UNDER FOAM AS SHOWN. IF INSTALLING ALONG WITH C-TTP-INUT-1, FORWARD BRACKETS SHOULD REST ON TOP OF C-TTP-INUT-1 BRACKET.
4. ALIGN SLOTS IN BASE OF FORWARD BRACKETS WITH BOLTS IN FORWARD CARGO FLOOR AND THREADED INSERTS ON FLOOR OR VEHICLE
5. REINSTALL FORWARD CARGO FLOOR BOLTS.
6. REMOVE 2 PLASTIC CAPS OVER X-BRACE REAR HARDWARE.
7. ONE SIDE AT A TIME, REMOVE REAR X-BRACE HARDWARE POSITION REAR BRACKETS ON TOP OF X-BRACE, AND REINSTALL OEM HARDWARE. TIGHTEN TO VEHICLE MFR RECOMMENDED TORQUE.
8. PLACE BOX ON TOP OF FORWARD BRACKETS AND INSTALL HARDWARE TO AFFIX BOX TO BRACKETS. LEAVE HARDWARE LOOSE.
9. INSTALL SUPPORT BRACES BETWEEN SIDES OF BOX AND REAR BRACKETS.
10. CHECK CENTERING AND POSITION OF BOX. BOX SHOULD BE CENTERED BETWEEN VEHICLE INTERIOR PANELS AND REAR OF BOX SHOULD BE PARALLEL WITH REAR OF FORWARD CARGO FLOOR.
11. WHEN PROPER ALIGNMENT HAS BEEN ACHIEVED, TIGHTEN HARDWARE TO SECURE BOX.
12. MARK AND TRIM PLASTIC CAPS AS NECESSARY TO CLEAR BRACKET AND SUPPORT.
13. REINSTALL PLASTIC CAPS.
14. REINSTALL REAR CARGO FLOOR.

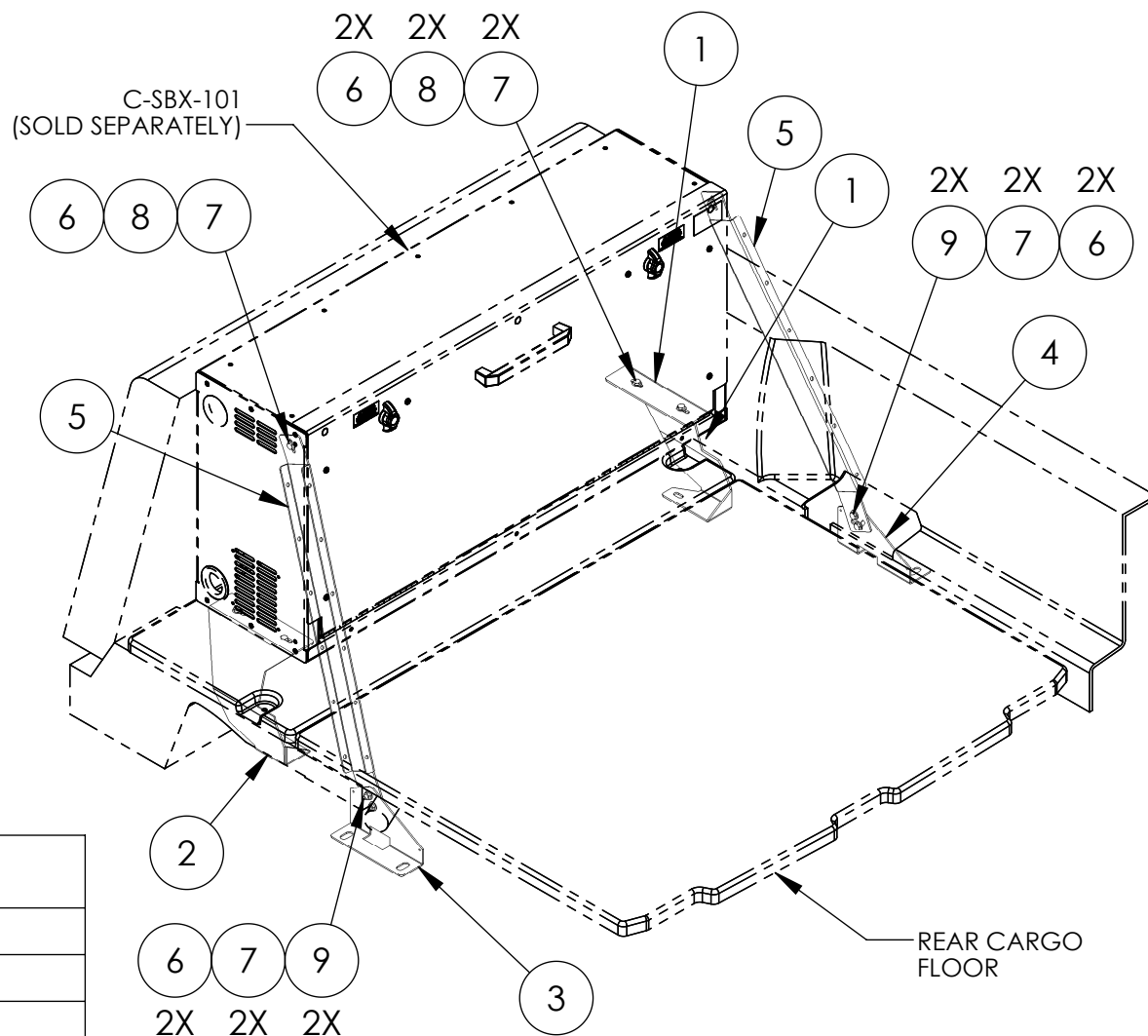

PROJECT #	REV.	DESCRIPTION
1875	10-14	ADDED REV. BLOCK
1986	12-15	CORRECTED BOM

ITEM NO.	QTY	PART NUMBER	DESCRIPTION
1	1	10-005788	BRKT, INUT SBX, FWD, PS
2	1	10-005789	BRKT, INUT SBX, FWD, DS
3	1	10-005790	BRKT, INUT SBX, REAR, DS
4	1	10-005791	BRKT, INUT SBX, REAR, PS
5	2	10-005792	BRKT, INUT SBX, SUPPORT
6	10	GSM30023	NUT 1/4-20 HEX FLANGE SERRATED ZP, BLK
7	10	GSM31005	WASHER, 1/4 FLAT ZP, BLACK
8	6	GSM33000	SCREW 1/4-20 X 1/2 HHCS, BLK, ZP, GRD 5
9	4	GSM33001	SCREW 1/4-20 x 3/4" HHCS ZP BLK

HAVIS, INC. <small>75 JACKSONVILLE RD. WARMINSTER, PA. 18974 1-800-524-9900</small>		
TITLE: INTERCEPTOR UTILITY REAR STORAGE BOX BRACKET INSTALLATION		
DO NOT SCALE DRAWING		
SIZE A	DWG. NO. C-SBX-101-KIT-1-INST	REV 12-15
WEIGHT (LB): 10.89	SCALE: 1:12	SHEET 1 OF 1