

INSTALL INSTRUCTIONS

C-TTP-INUT-200

Hinge Up Equipment Mounting Platform for 2013-2019 Ford Interceptor Utility

TOOLS REQUIRED:

Standard and Metric Socket set Open End Wrench- 7/16" Foam cutting tool

INSTALLATION PARTS and HARDWARE:

QTY	DESCRIPTION	PART #
1	Forward Trim / Filler panel	CM005235
1	Support arm mount bracket Passenger side	CM009341
1	Support arm mount bracket Driver side	CM009342
2	5/16-18x2-1/2"x 1-5/8" U-BOLT	GSM20406
2	"Z" brackets for locks	CM005518
2	Cam locks with Keys	CM86353
1	Side rear support bracket Passenger side	CM006965-PS
1	Side rear support bracket Driver side	CM006965-DS
4	Rubber Bumper (for side rear support brackets)	CM93084
4	1/4" Serrated Nut	GSM30023
11	1/4" Flat washer	GSM31005
5	1/4" Lock washer	GSM31026
7	1/4" x 3/4" Hex bolt	GSM33001
6	5/16" Flat washer	GSM31006
6	5/16" Lock washer	GSM31027
2	6mm x 16mm Hex bolt	GSM33710
2	8mm x 35mm Hex bolt	GSM33723
2	6mm Hex nut	GSM30201
2	Rubber Gasket (11" inch long)	PRM97345
2	200 lb. rated gas spring with ball mount socket end	25367

C-TTP-INUT-200 Bottom Side

Layout of equipment
and drilling of holes
should be done prior to
installation.



Gas springs are
shipped loose
This view shows gas
springs already
attached.

Always!

- Read all instructions before installing any Havis, Inc. products.
- Use hardware provided with install kit



View of Interceptor Utility rear cargo floor.
Remove main floor / spare tire cover.



Remove forward floor cover panel by unbolting two (2) bolts and spacers. (8mm socket)



Remove forward floor cover, forward foam filler block and side foam filler blocks.

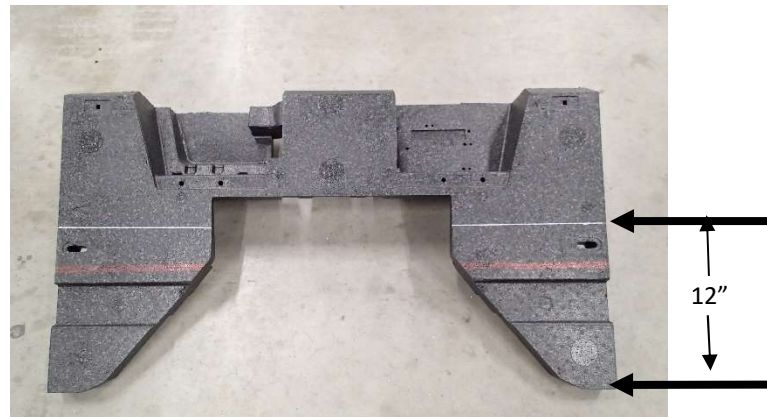

Forward foam block modification.
Measure 12" inches from rear of foam block and draw line to be cut.

Note: Foam is modified so platform mounting can be more secure and to help adapt better to rear partitions.



Cut both sides of foam block as shown.

Rear sections of foam block will not be reused. Forward section of foam block can now be put back into original location.

Note: Electric Steak Knife works well for cutting foam.



With gas springs closed, place the platform assembly into vehicle.



Forward mount bracket holes will line up with OEM holes for cargo floor panel previously removed.



Attach bracket to floor with supplied 8mm x 35mm Hex bolts, 5/16 lock washers and 5/16 flat washers. Forward foam block shown back in original location.



Install forward trim / filler panel CM005235 with three (3) 1/4" x 3/4" hex bolts, lock washers and flat washers.

Note: This filler panel can be modified or not used if necessary for other equipment mounting.



Snap gas spring onto ball mounts. Ball mounts should already be installed and are located on the underside of platform and lower support arms. (one each side)

Note: The large diameter cylinder end attaches to the lower support bracket.



Attach support arm mount brackets to support arms with 1/4" x 3/4" hex bolts, flat washers and serrated nuts.

Clamp bracket to OEM support tube with 2.5" U-Bolts, 5/16" flat washers, lock washers and nuts.

Note: A small piece of the foam block will need to be cut away for bracket clearance.

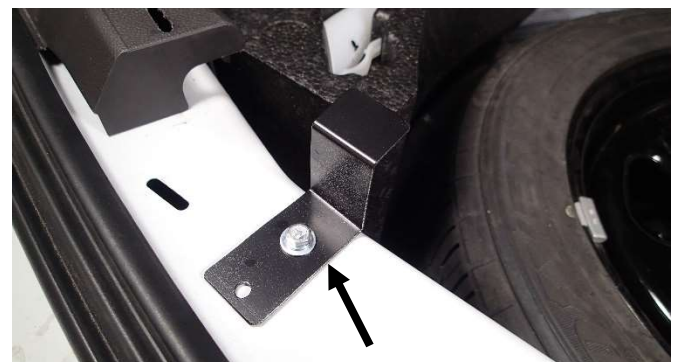

Remove rear hatch lower sill trim.

Attach "Z" bracket for lock assembly to OEM threaded hole with 6mm x 16mm Hex bolt. 1/4" lock washer and flat washer. (One each side)

Replace rear hatch lower sill trim.



Use Key and make sure lock cam lever engages the "Z" bracket to prevent opening of flip up platform. Adjust tab if necessary.



Attach # PRM97345 foam gasket (provided) to underside of rear flange. Gasket will be between flange and door sill. **(split the gasket in half before installing / 11" inch single piece per side)**



Attach side rear support brackets to OEM floor studs (located under rear foam blocks) with 6mm nuts and 1/4" flat washers. **Foam blocks may need to be notched for bracket installation.**



Lid stay bracket locks lid in position when opened. To close lid, pivot bracket to allow gas spring clearance and press down on lid.



View of completed installation with K9-F18 insert and C-SBX-101.

C-TTP-INUT-200 also works with K9-F18-PT insert.



Optional floor mat available. Heavy duty masticated rubber material
Part number - KNM01029-SUV