

TOP ORIENTATION INSTALLATION

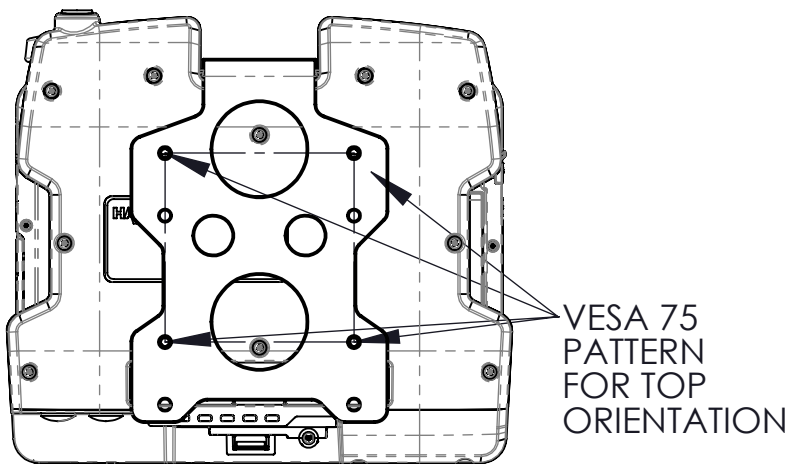

IMAGE 1: TOP ORIENTATION VESA PATTERN

SIDE ORIENTATION INSTALLATION

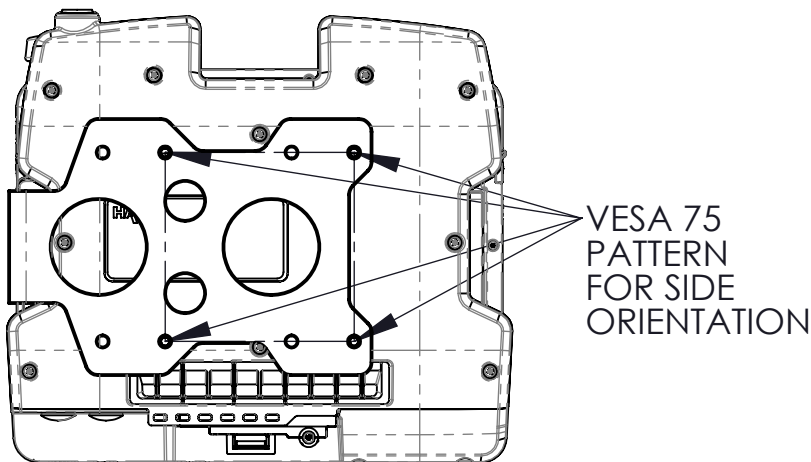

IMAGE 2: SIDE ORIENTATION VESA PATTERN

INSTALLATION INSTRUCTIONS:

Note: Docking Station depicted may not match identically to product purchased. However, all installation instructions are still applicable unless otherwise noted.

1. Position the Barcode Blocker, DS-DA-243 in either the TOP or SIDE orientation which matches the installed position of the Barcode Reader on your Panasonic FZ-L1 tablet.

Note: The VESA 75 hole pattern used in the TOP and Side position are different. Reference Image 1 and 2 respectively, for the Top and Side orientation VESA patterns.

2. Using the hardware supplied with your PAN-1300 Docking Station, secure the Barcode Blocker Bracket between the PAN-1300 Series Docking Station, and the mounting device. Do not over-tighten fasteners.

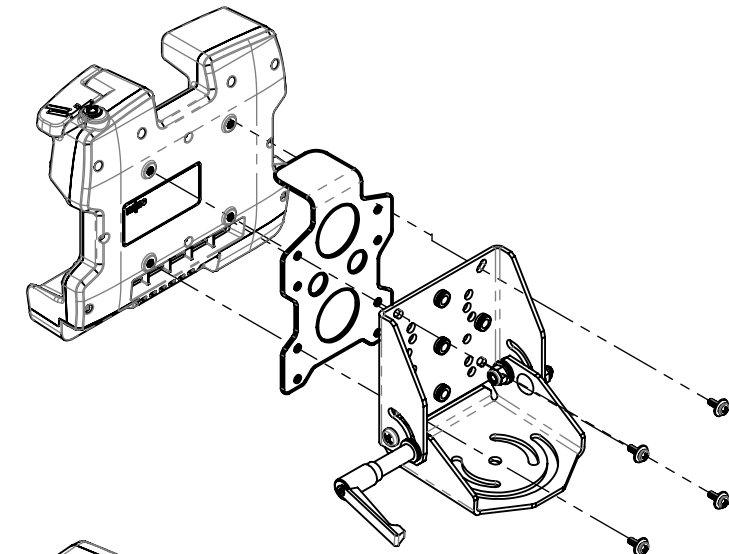

BRACKET
INSTALLED IN
TOP POSITION

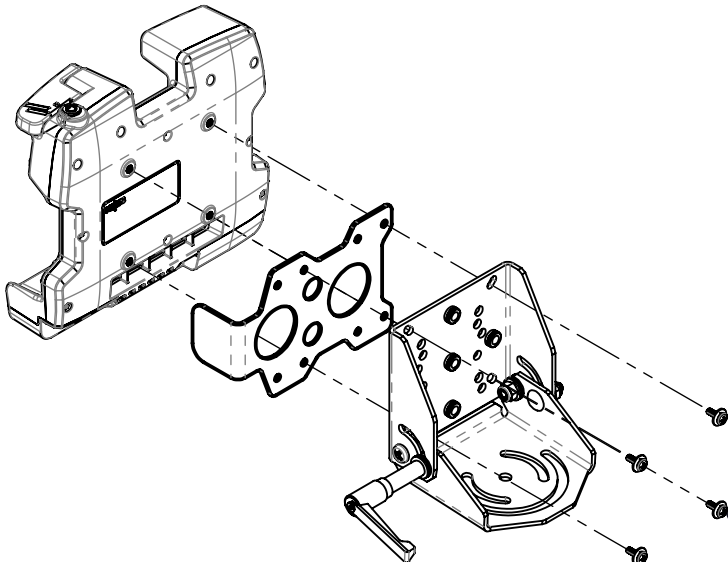

SECURE DS-DA-243 WITH
THE HARDWARE INCLUDED
WITH THE DS-PAN-1300
SERIES DOCKING STATION

BRACKET
INSTALLED IN
SIDE POSITION

DRAWING NUMBER:
DS-DA-243_INST_7-19

WARNING: ALL HAVIS INC. PRODUCTS ARE DESIGNED WITH SAFETY OF USE AND INSTALLATION IN MIND. HOWEVER, IT IS THE SOLE RESPONSIBILITY OF THE OWNER/OPERATOR OF A VEHICLE USING HAVIS INC. MOUNTING AND DOCKING EQUIPMENT, TO INSURE THAT THE EQUIPMENT IS INSTALLED SO THAT IT WILL NOT INTERFERE WITH VEHICLE OPERATION, INTERFERE WITH SAFETY DEVICES, OBSTRUCT VIEW OF DRIVING CONDITIONS, OR IN ANY WAY DEGRADE OCCUPANT SAFETY. IMPROPER INSTALLATION CAN CAUSE SERIOUS INJURY IN THE EVENT OF AN ACCIDENT. INSTALLATION SHOULD ONLY BE PERFORMED BY QUALIFIED PROFESSIONALS. COMPUTERS AND MOTION DEVICES MUST BE MOVED TO AND STOWED/SECURED IN THEIR SAFE DRIVING POSITIONS BEFORE OPERATING VEHICLE.

PRODUCT DESCRIPTION

INSTALLATION INSTRUCTIONS, DS-DA-243,
BARCODE BLOCKER BRACKET.

PRODUCT I.D. DS-DA-243	DATE 07-03-19
PRODUCT NAME BARCODE BLOCKER BRACKET FOR DS-PAN-1300 SERIES	
HAVIS 1-800-524-9900 WWW.HAVIS.COM	WEIGHT: (LBS)
	REV. DATE 07-19