

## INSTALLATION INSTRUCTIONS

1. INSTALL THE LEXAN PLATE FROM INSIDE OF THE KIT.
2. ALIGN ALL MOUNTING HOLES AND USE THE SUPPLIED HARDWARE; CARRIAGE BOLTS, WASHER AND NUTS TO SECURE IT IN PLACE.
3. ALL NUTS SHOULD BE INSTALLED AT OPPOSITE SIDE OF THE LEXAN.

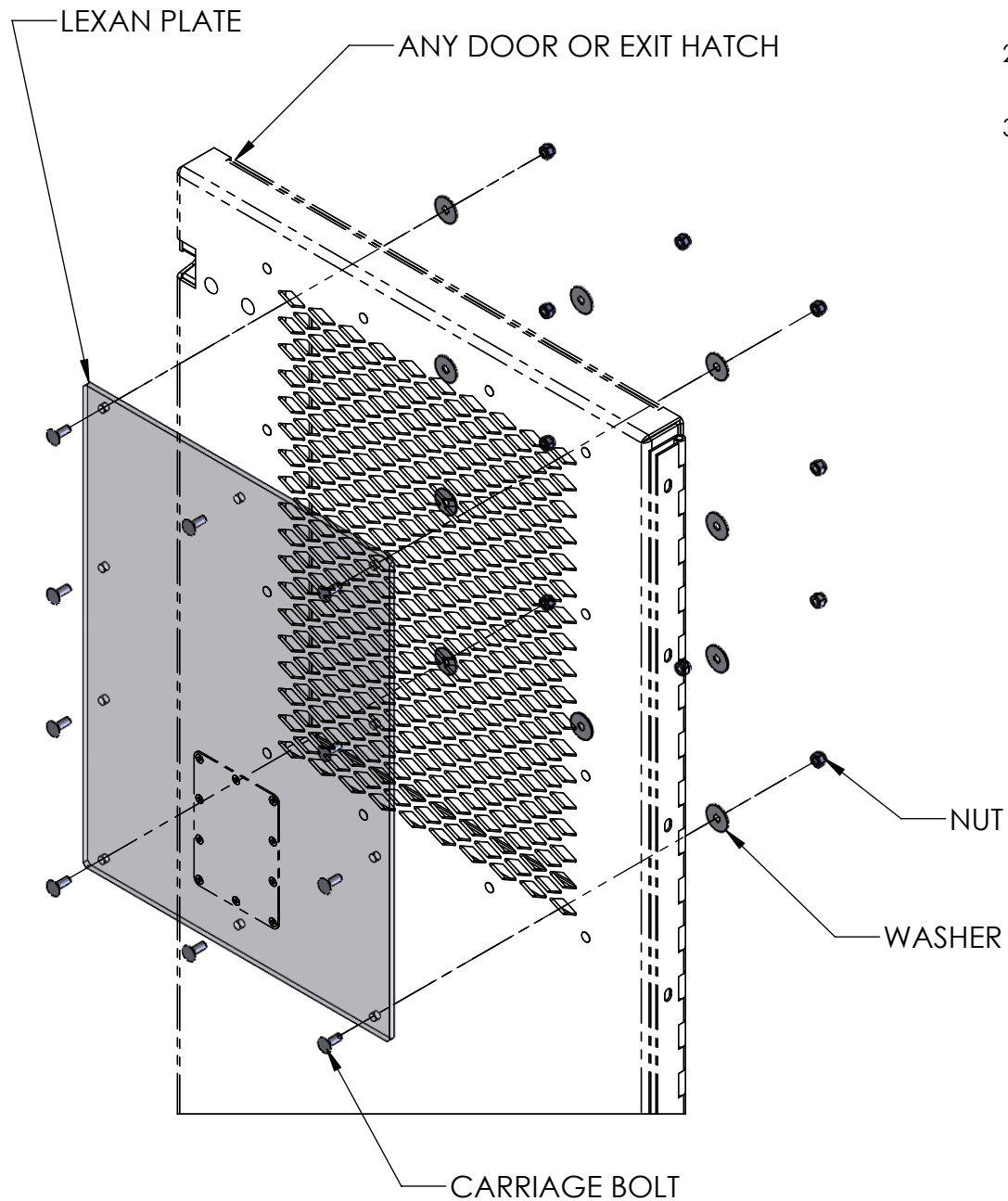

<b>HAVIS</b> HAVIS, INC.		75 JACKSONVILLE RD. WARMINSTER, PA. 18974 1-800-524-9900
TITLE: INSTALL INSTRUCTION		
DO NOT SCALE DRAWING		
SIZE <b>A</b>	DWG. NO. PT-A-913-INST	REV 11/15
WEIGHT (LB): 21.88	SCALE: 1:8	SHEET 1 OF 1