

# INSTALLATION INSTRUCTIONS

## SBX-5004 Standalone mounting base for SBX-1000 series Drawers in 2020 Interceptor Utility

**If using with Pro-Gard rear partition, PROKIT-2 is required.**

**TOOLS REQUIRED:**

Standard socket set

Standard wrench set

**PARTS and MOUNTING HARDWARE:**

<b><u>QTY</u></b>	<b><u>DESCRIPTION</u></b>	<b><u>PART#</u></b>
1	Mounting base	CM010159
1	DS upper mounting bracket	CM010162
1	PS upper mounting bracket	CM010161
1	DS lower mounting bracket	CM009683
1	PS lower mounting bracket	CM009682
2	U-bolt <b>(with nuts)</b>	GSM20406
4	1/4" Serrated nut	GSM30023
4	5/16" x 3/4" Thread forming screw	GSM32038
4	5/16" x 1" bolt	GSM33012
8	5/16" Split lock washer	GSM31027
8	5/16" Flat washer	GSM31006
2	3/8" x 1" Hex bolt	GSM33028
2	3/8" Nylock nut	GSM30018
4	3/8" Flat washer	GSM31144

**Always!**

- Read all instructions before installing any Havis, Inc. products.
- **Check for obstructions (Wires, brake lines, fuel tank, etc.) before drilling any holes!**
  - Use hardware provided with install kit

SBX-5004

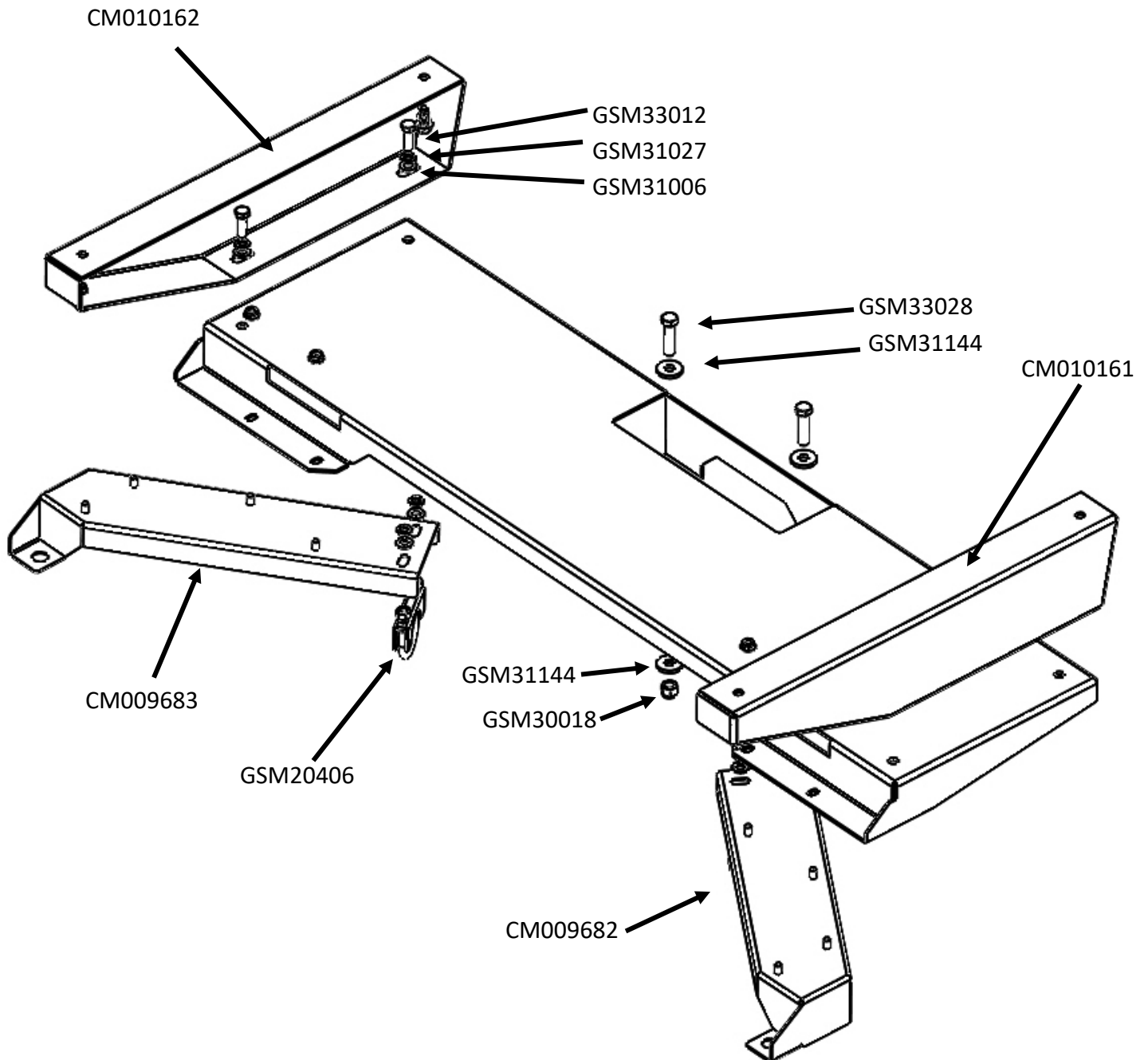

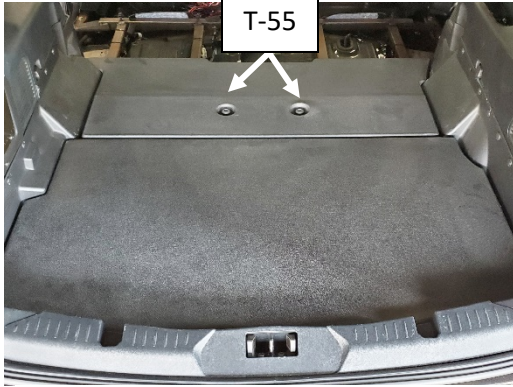

Remove both sections of the OEM trunk floor.

*T-55 Torx socket*



Remove rear bolt from OEM cross brace and install lower mounting bracket re-using OEM bolt.

*Repeat for passenger side*

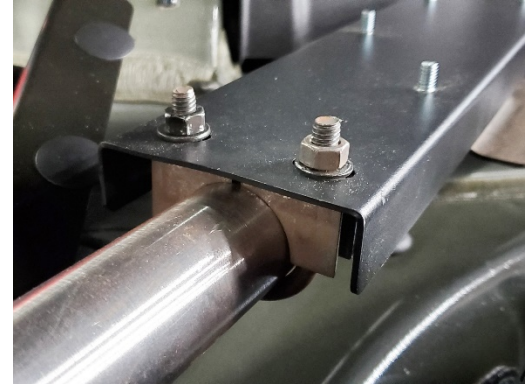

Attach other end of lower support bracket with supplied U-bolt, flat washers, lock washers and nuts.

*Repeat for other side*



Place mounting base in the vehicle and attach to studs using (4) 1/4\"/>

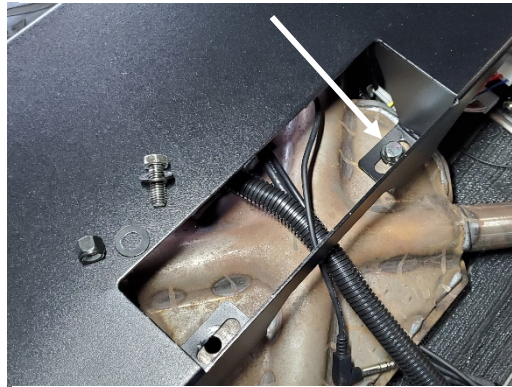

Attach forward section of mounting base to OEM cross brace using (2) 3/8\"/>



Place rear section of factory floor back in vehicle.

***This can also be placed back in vehicle at end of installation if desired.***



Attach upper mounting brackets to the bottom of the SBX box using (4) 5/16\"/>



Place **drawer assembly** into vehicle and line up to the mounting points in the mounting base. Attach using (4) 5/16\"/>



Installation is now complete.