

INSTALLATION INSTRUCTIONS

SBX-5007 mounting base for SBX-1000 series Drawers in 2020 Interceptor Utility with K9-F28-1

TOOLS REQUIRED:

Standard socket set

Standard wrench set

PARTS and MOUNTING HARDWARE:

<u>QTY</u>	<u>DESCRIPTION</u>	<u>PART#</u>
1	Mounting base	13283
1	DS upper mounting bracket	23250
1	PS upper mounting bracket	23251
1	DS lower mounting bracket	13106
1	PS lower mounting bracket	13105
2	SBX Box riser	23448
2	U-bolt (with nuts)	15945
4	1/4" Serrated nut	16013
4	5/16" x 3/4" Thread forming screw	16245
8	5/16" x 1" bolt	16336
8	5/16" Split lock washer	16143
18	5/16" Flat washer	16123
4	5/16" Nylock nut	16010
4	1/4" Flat washer	16154
4	1/4" Phillips head screw	16618
2	3/8" x 1" Hex bolt	16245
2	3/8" Nylock nut	16011
4	3/8" Flat washer	16182

Always!

- Read all instructions before installing any Havis, Inc. products.
- Check for obstructions (Wires, brake lines, fuel tank, etc.) before drilling any holes!
 - Use hardware provided with install kit

SBX-5007

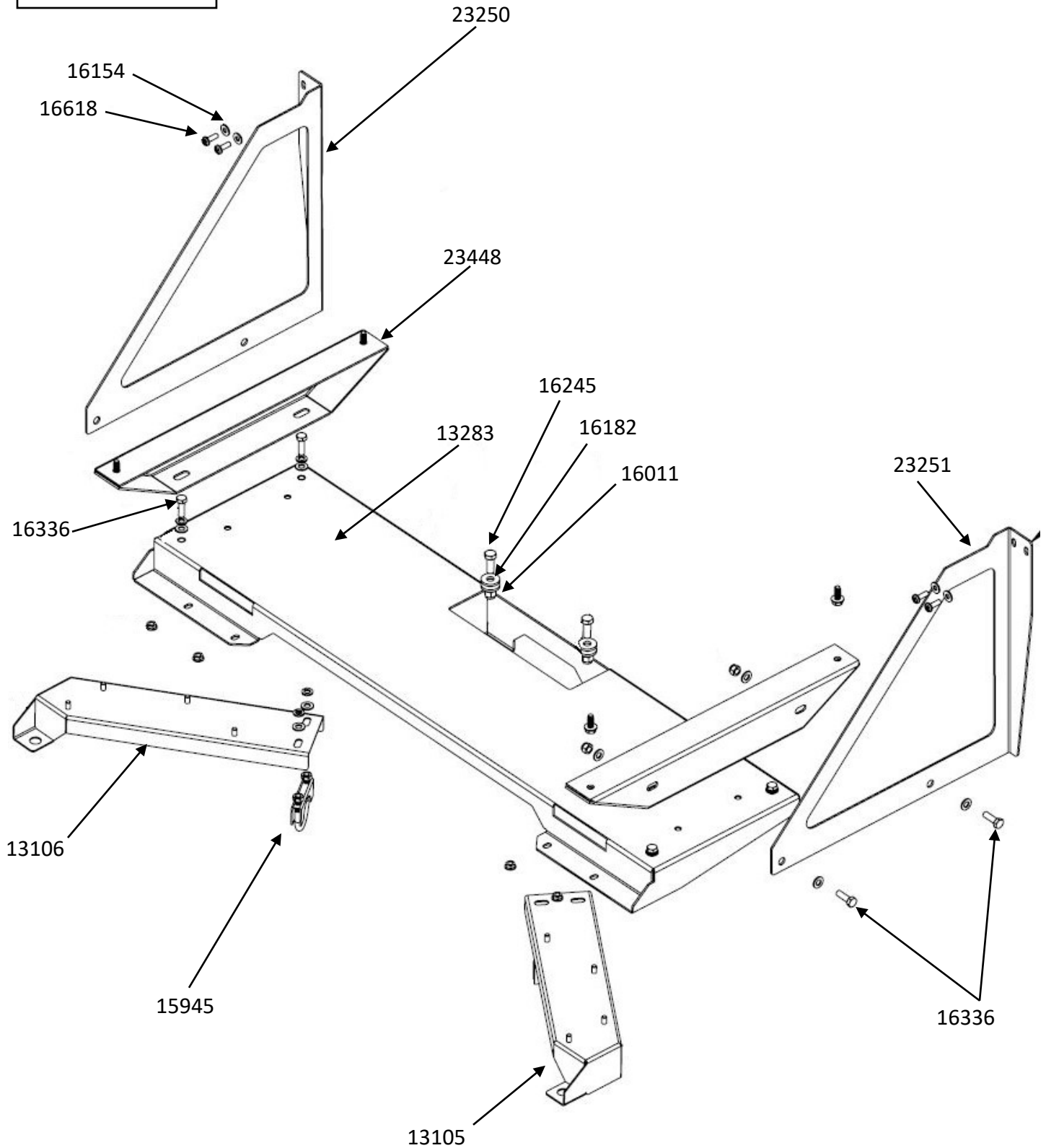

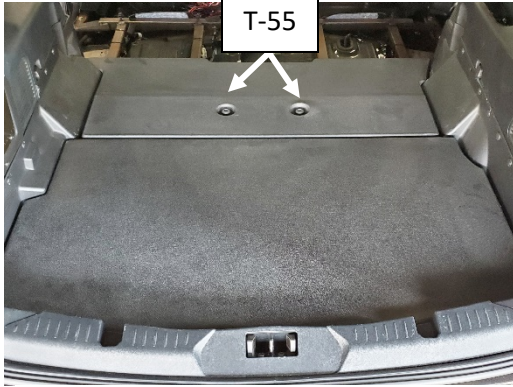

Remove both sections of the OEM trunk floor.

T-55 Torx socket



Remove rear bolt from OEM cross brace and install lower mounting bracket re-using OEM bolt.

Repeat for passenger side

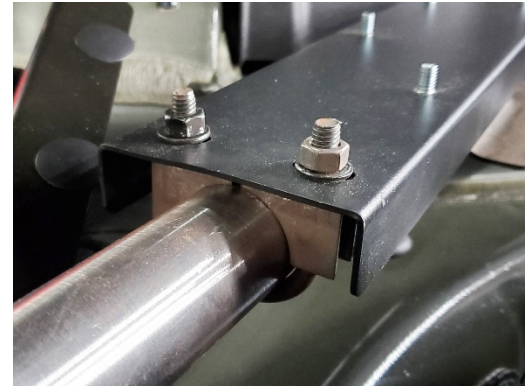

Attach other end of lower support bracket with supplied U-bolt, flat washers, lock washers and nuts.

Repeat for other side



Place mounting base in the vehicle and attach to studs using (4) 1/4" serrated nuts.



Attach forward section of mounting base to OEM cross brace using (2) 3/8" x 1" bolts, washers, and nylock nuts.



Loosely install side, mounting bracket. Attach to rear cross brace of K9 rear wall using 1/4" x 3/4" Phillips pan head bolts and washers.

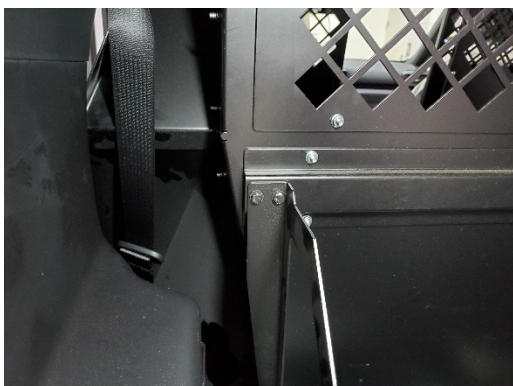

Repeat for other side



Make sure brackets are loose and pushed against the sides of the cargo area.



Install SBX box risers on bottom of SBX-1000 series box.

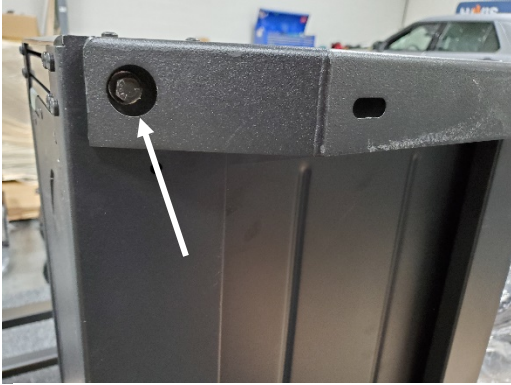

Tighten (4) self-threading 5/16" x 3/4" bolts.



Place SBX box into back of vehicle on top of base plate and between side mounting brackets.

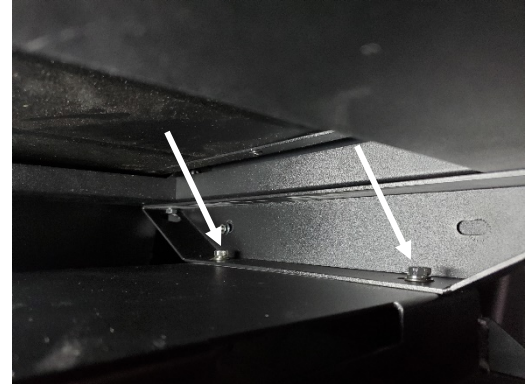

From underside of SBX box, install 5/16" x 1" bolts, split lock washers, and nuts into mounting base.

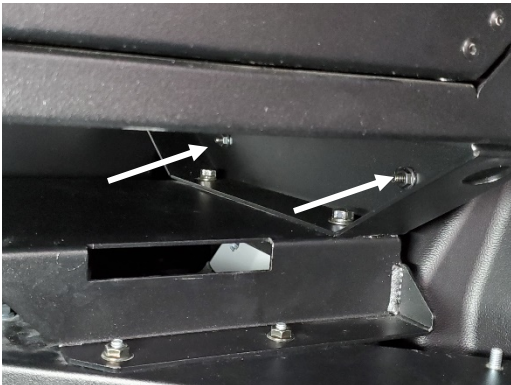

Attach side, mounting brackets to risers using 5/16" x 1" bolts, flat washers, and nylock nuts.

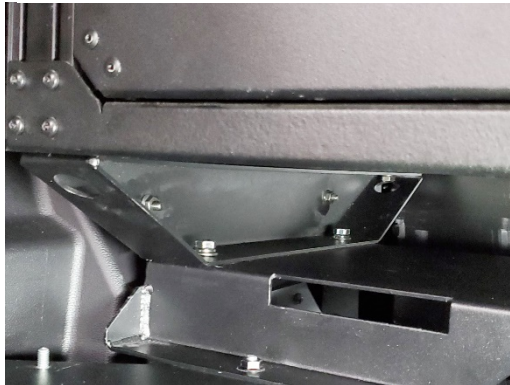

Repeat for other side.



Tighten hardware at rear cross brace of K9 wall.



Repeat for other side.



Place OEM floor in vehicle.



Installation is now complete.