

K9-F28-PT

HAVIS

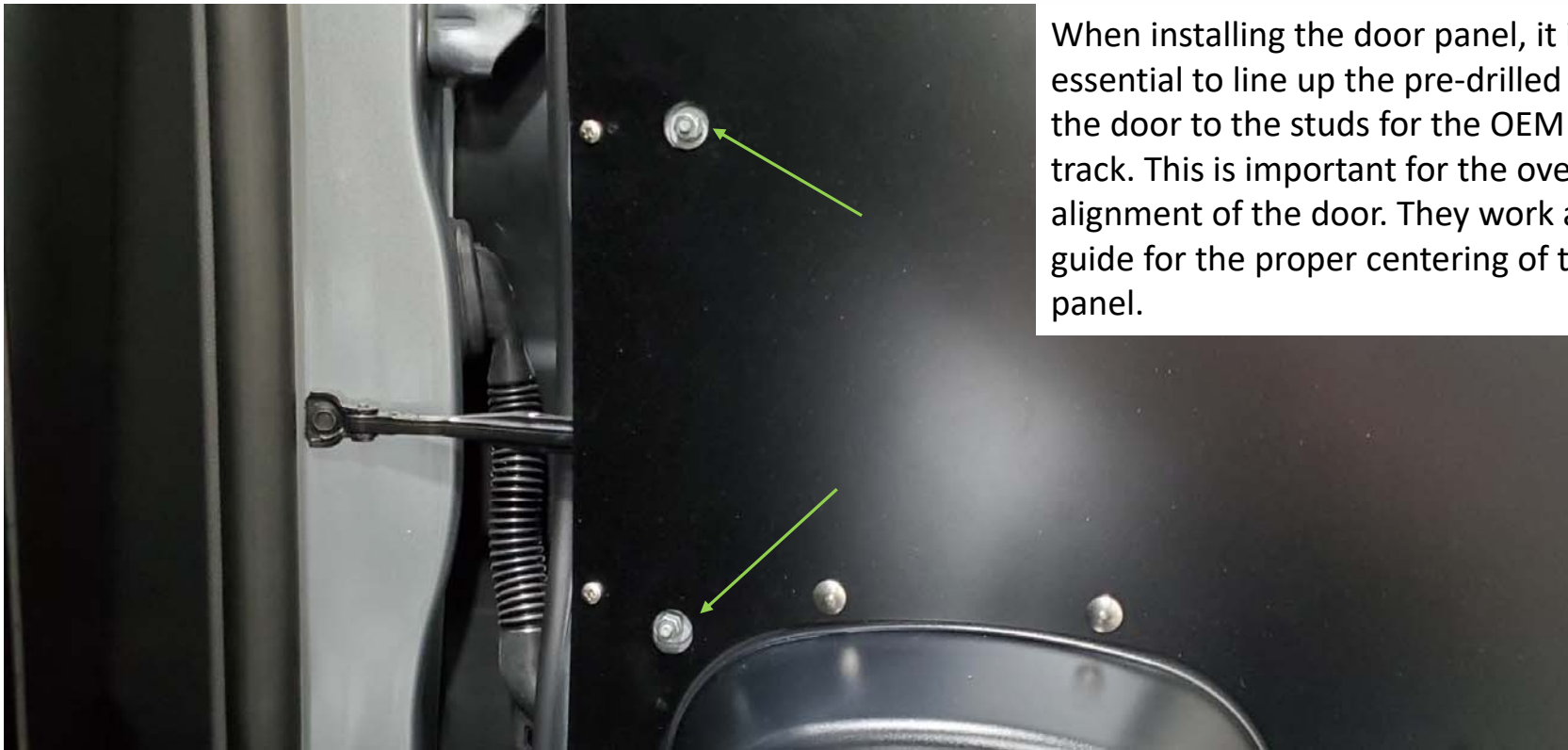

K9-F28-PT



When installing the door panel, it is essential to line up the pre-drilled holes in the door to the studs for the OEM window track. This is important for the overall alignment of the door. They work as a guide for the proper centering of the panel.

K9-F28-PT

The door panel is attached utilizing stainless steel (SS) screws, which can cause threads to strip quickly. An effective remedy is to apply some wax when running in the screws. This will ensure a smooth entry into the door without the risk of damaging the threads.

A good rule of thumb is to pre-drill all holes with a 1/8" drill bit.



K9-F28-PT – Vent and Dome light

On the K9-F28-PT and K9-F28-XL, vents adaptors are located on the top of the insert. These vent adaptors line up with the OEM vents in the ceiling. Be sure to open the vents prior to installing the adaptor.



To ensure a smooth installation, be sure to run the wiring for the dome light(s) prior to installing the insert.

K9-F28-PT – Speaker pod - Polycarbonate



A few questions have been raised regarding the material used in the speaker pod found in our door panels. The Havis speaker pods are manufactured utilizing polycarbonate plastic. Polycarbonate is a highly durable, rugged plastic and is the same material that is utilized for our partitions to ensure officer safety. Our engineers thoroughly torture tested it to make sure it would withstand a K9 environment. .

K9-F28-PT – Speaker pod



A sneak peek behind the OEM door panel reveals the reasoning behind the speaker pods. On the 2020 Interceptor Utility, Ford redesigned its doors to incorporate a protruding speaker pod.

This pod is part of a larger inner door assembly that houses the window motor as well as the window track.

At Havis, we strive to limit the amount of modification made to the vehicle. To accomplish this, we chose to build around the pod, rather than ask an installer to cut off or modify it.

This allows the vehicle to be returned to the original working status when it is decommissioned.



K9-F28-PT – K9-A-201 (Hot-N-Pop)

One of the challenges with installing an K9-A-201 Hot-N-Pop system has always been the placement of the gas shock.

We added provisions into our door panel in the form of predrilled holes to take the guesswork out of bracket placement.



An important reminder to note, when installing the bracket, make sure the ball socket is pointing down. This will ensure smooth operation throughout the opening and closing process.

K9-F28-PT – K9-A-201 (Hot-N-Pop)

The floor has a pass-through for the gas shock already built in.

If this option is not used, a cover plate is provided with the kit.

This is available on both sides of the K9-F28-XL and K9-F28-1 insert.



K9-F28-PT – Hot N Pop

A peek at the front floor bracket under the insert shows the preconfigured mounting location for the gas shock.

Please note it is pivotal to ensure that the ball socket is facing up on the inside bracket. This will ensure that the geometry is accurate for a smooth operation.



K9-F28-PT – K9-A-111 – Ford Ready for the road

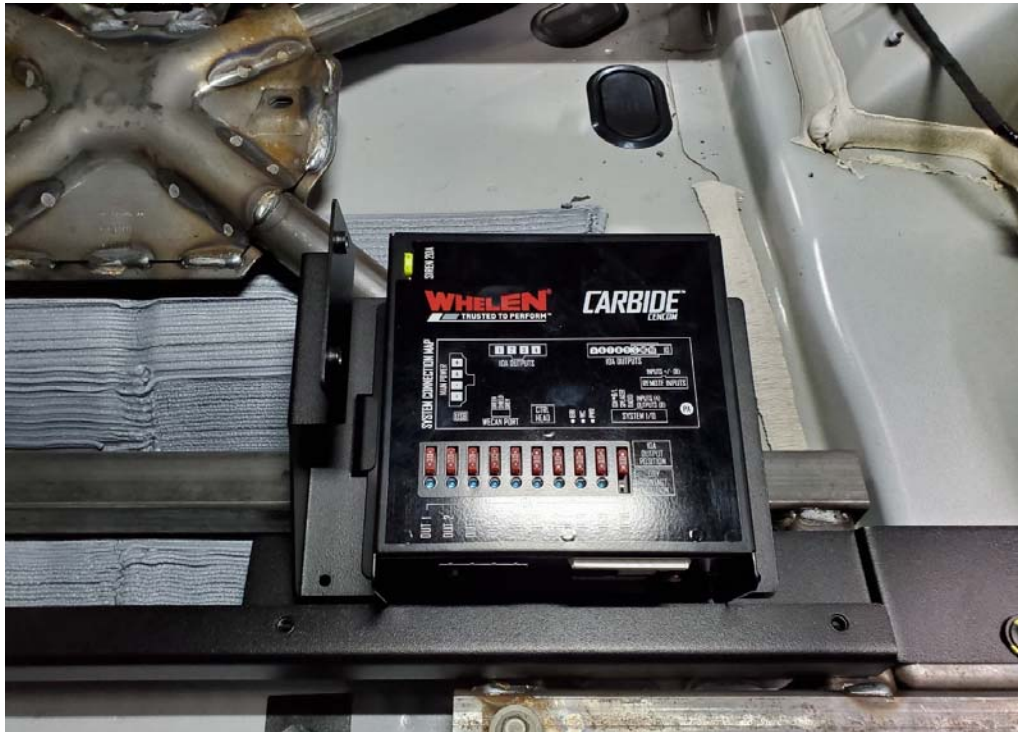

Ford offers a Ready for the Road package that, in some cases, provides a Whelen Cencom system. This device is located on a factory bracket that is attached to the foam in the rear of the vehicle. When the K9-F28-XL and K9-F28-PT s installed, this foam is removed. An optional relocation bracket (K9-A-111) is available to remount the Cencom, and it is a no-drill option that attaches the rear bracket of the K9 insert.

K9-F28-PT – K9-A-111

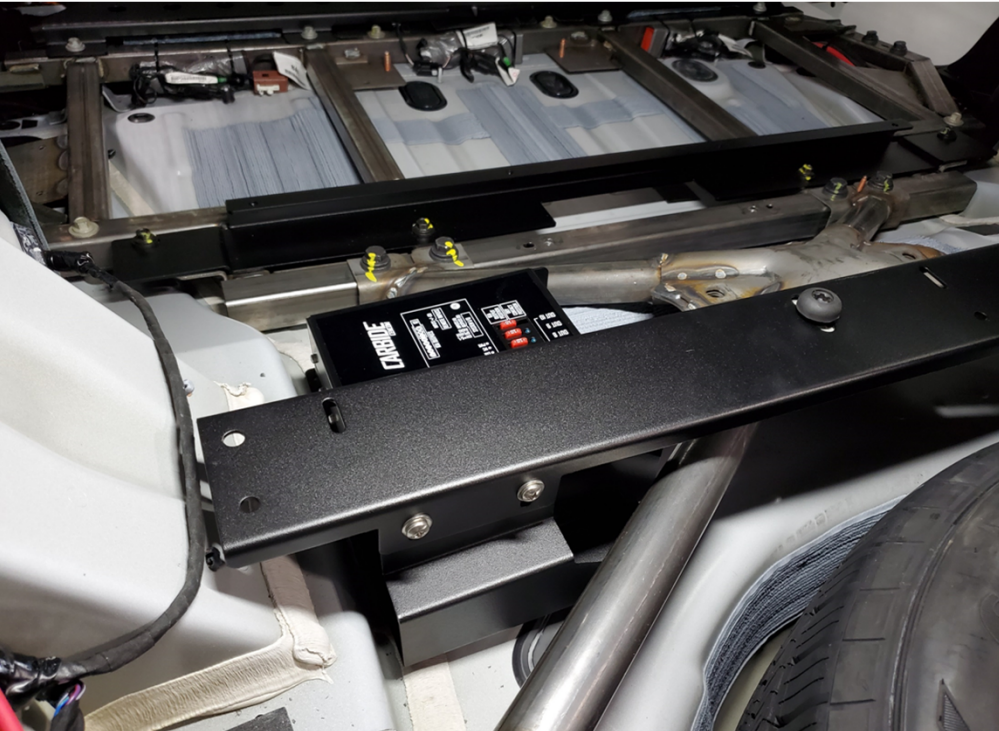

The picture on the left shows the bracket mounted. On the right, we show an access cover that is incorporated into the rear floor section of the K9-F28-XL and K9-F28-PT. This allows access to the factory electronics even after a K9 is installed.

K9-F28-PT – Emergency exit door – Caulking tips



This image above highlights the easy access release knobs for the emergency exit door. The emergency exit door is a feature that was added to all our K9/PT inserts. This feature ensures that there is a secondary form of egress for either side in the case of an emergency.



A question that comes up from time to time is caulked the kit. How much is too much? Not enough? A good rule of thumb is to always caulk around the floor and front and rear bulkhead seams. The goal is to ensure the kit can be hosed out but does not need to be 100% watertight.

Commonly asked questions

- What is the average install time for a standard K9 insert?
 - Around 5-6 hours, depending on the skill level of the installer.
 - For the K9-A-201 (Hot-N-Pop), add about an additional 5 hours..
- What product should I use to clean the mat?
 - A basic soap and water solution is best. Harsh chemicals are not needed.
- What if I have paint or damaged threads in the threaded inserts?
 - The thread pitch is $\frac{1}{4}$ "-20. Running a $\frac{1}{4}$ "-20 tap through them prior to installation is recommended.