

SHOWN INSTALLED
WITH VESA INTERFACE

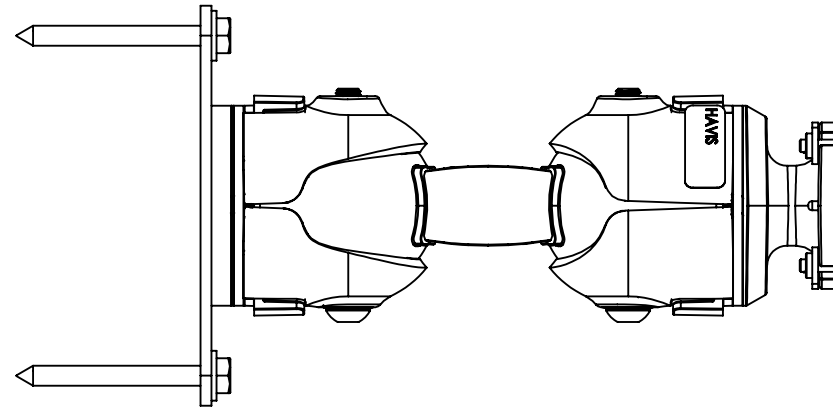

TOOLS NOT PROVIDED:
7/16" WRENCH
#2 PHILLIPS SCREWDRIVER
3/16" DRILL BIT

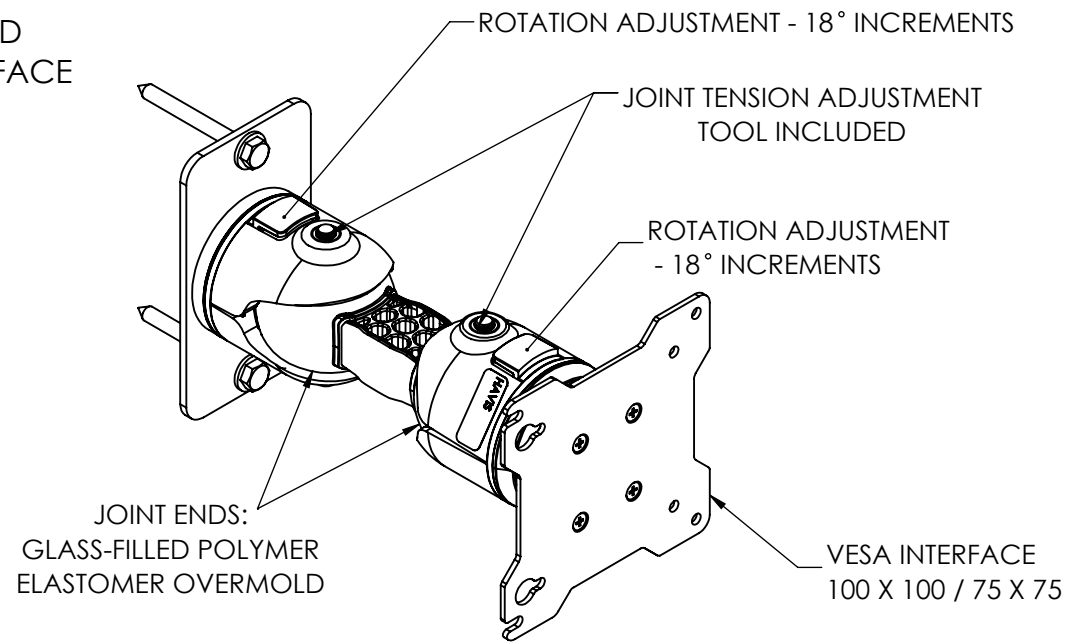
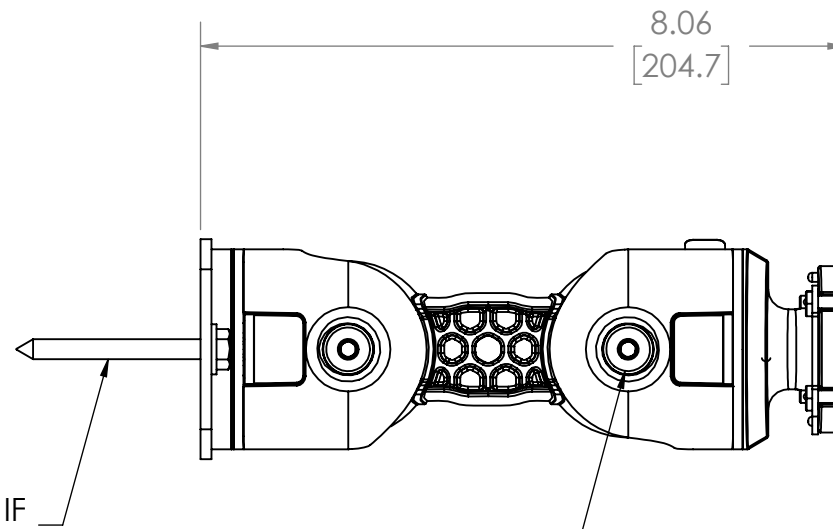
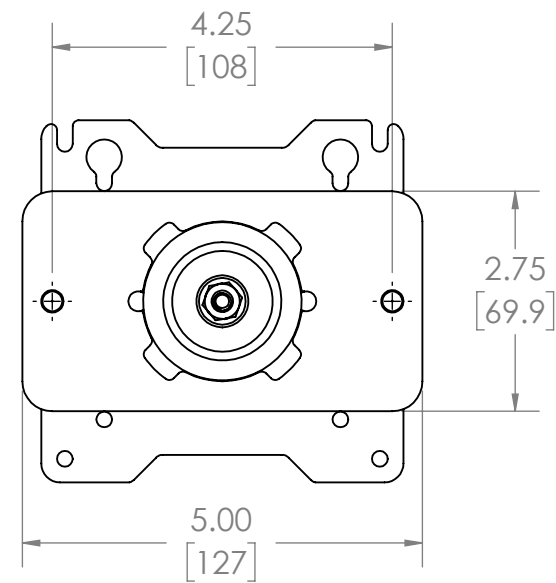

DRILL 3/16" PILOT HOLES IF
INSTALLING IN WOOD STUD

TORQUE AS NECESSARY
UP TO 50 IN-LBS
3/16" HEX KEY (PROVIDED)

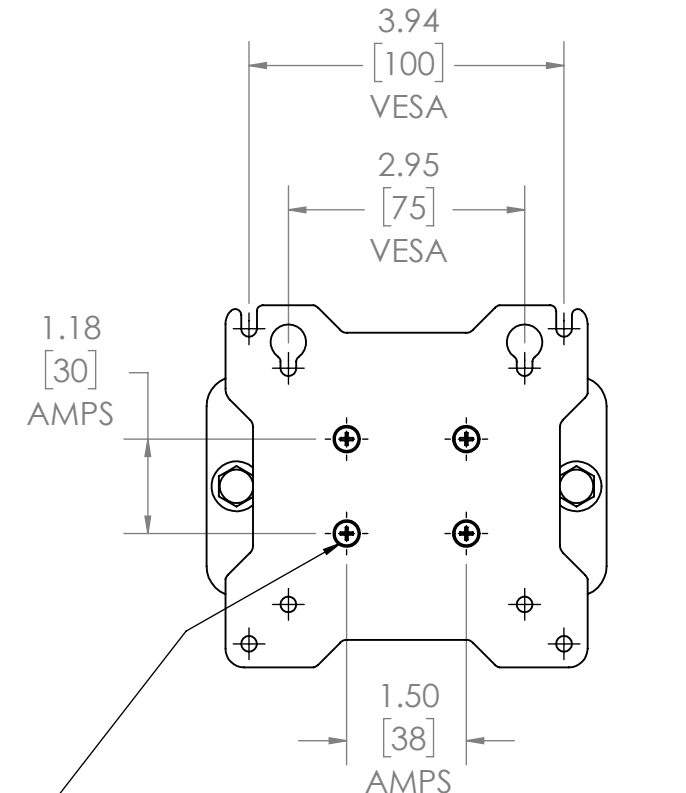

VESA PLATE ATTACHMENT WITH NUT
PLATE (BOTH PROVIDED)
4X M4-.7 X 14MM SCREWS (PROVIDED)
#2 PHILLIPS DRIVE (NOT PROVIDED)

**MAXIMUM LOAD:
STATIC**

25 LBS. [11.3 KG], UP TO 24" DIAGONAL SCREEN

DYNAMIC

MIL-STD-810H VIBRATION*: 10 LBS. [4.5 KG], UP TO 10" DIAGONAL SCREEN

COMBINED WEIGHT OF ACCESSORIES, MOUNTS, DEVICES, ETC. ATTACHED TO ARM
INSTALLER TO VERIFY INTEGRITY OF MOUNTING SURFACE IS SUFFICIENT FOR SUPPORTED LOAD
INSTALLER TO PROVIDE MOUNTING FASTENERS OF SUFFICIENT STRENGTH IF ATTACHING TO SUBSTRATE OTHER THAN WOOD STUD

*PER METHOD 514.8, CATEGORY 24, GENERAL MINIMUM INTEGRITY, FIGURE 514.8E-1

DWG. NO.
MD-503

REV.
A

TITLE

RUGGED WALL MOUNT

DRAWN
J. RAU

DATE
5/2/2022

SHEET 1 OF 1



REVISIONS

REV.	DESCRIPTION	DATE	BY	CHK'D
A	NEW RELEASE	2/10/2023	JTR	JTR

TECHNICAL INFORMATION