



MM-1000 SERIES

MODULAR MOUNT FOR NEW INSTALLATIONS

The challenge for retailers, warehouses and distribution centers when implementing technology is how to maximize limited space to mount that technology, while ensuring it is ergonomic and easy to use. Installed modular mounting solutions are regularly upgraded to utilize new technology, however the user often has no choice on where they can source this upgrade.

The exciting news is that the new MM-1000 Modular Mounting solution from Havis gives the user complete solution options to manage the space at their checkout or workstation and also to upgrade existing installations.

The MM-1000 Modular Mount incorporates a new generation of engineered materials for a durable and strong, yet modern looking POS solution. Designed to be great value, easy to order, install and upgrade.

KEY FEATURES

- Uses the latest Engineered Polyamide Alloy materials for durability and industry leading design for today's markets
- Innovative cable management that is an industry first to hide and protect cables
- Havis Pole allows for full range of device installation heights on all four sides
- Tool-less tilt tension adjustments on your Payment Terminal Mount



MM-1000 FOR NEW INSTALLATIONS

POLE & BASE OPTIONS



16" (406mm)
Round Base



24" (610mm)
Round Base



16" (406mm)
Rectangle Base



24" (610mm)
Rectangle Base

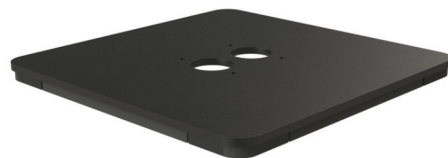

Free Standing Base
Use with 16" (406mm) Round Base Pole only

MONITOR MOUNT OPTIONS



OR



Single Pivot with Channel Mount OR Channel Arm*



OR



Double Pivot with Channel Mount OR Channel Arm*

*Extension Arm is 8" (200mm) Long

OR



Monitor Mount on 16" Folding
Extension Arm

PAYMENT MOUNT + LOCKING OPTIONS



OR



OR



Collar Arm*
(Rotating)

Channel Arm*
(Recommended)

Folding Extension Arm
(16" long)

*Arms are 8" (200mm) Long

FlexiPole Backplate



If locking is required...



SD0005
Latch

OR



KEN00148
Tether

Supports all major payment devices:



PRINTER MOUNT OPTIONS



Small Printer Mount
(Use with Channel Arm* only)



Medium Printer Mount
(Use with Channel Arm* only)



Large Printer Mount
(Use with Channel Arm* only)

*Arms are 8" (200mm) Long



Small Printer Mount on 16"
Folding Extension Arm



Medium Printer Mount on 16"
Folding Extension Arm



Large Printer Mount on 16"
Folding Extension Arm



SCANNER MOUNT OPTION

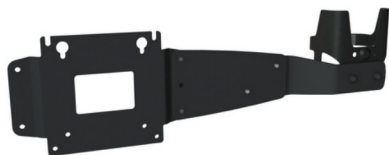

Scanner Mount

Attaches to 75/100MM VESA Monitors from 15" (381mm) to 20" (508mm) wide

KEYBOARD MOUNT OPTION

Contact Havis for customized options

ACCESSORIES



Large Cable Bundle Cover Kit

This kit is ideal under All-In-One Monitors or for other applications where multiple large cables need to be routed down the Havis Pole. It includes enough cable covers to accommodate any Havis Pole and includes a custom base cover with a pass-through opening. This kit accommodates cable bundles up to 1" (25mm) in diameter.

EXAMPLE CONFIGURATIONS



Single Monitor Mount



Monitor Mount with Printer & Payment Mounts on 16" (400mm) Folding Arms





Dual Monitor Mount with Payment & Printer Mounts on 8" (200mm) Arms

MM-1000 FOR NEW INSTALLATIONS

PART NUMBERS AND DETAILS

MM-10-116		
	Description	16" (406mm) Tall Pole with Round Base. 1.75" (45mm) Diameter
	Shipping Dimensions	4.82" L X 4.81" W X 21.25" D
	Shipping Weight (lbs/kg)	2.50/1.13
	Note:	Free Standing Base option can be used with the 16" (406mm) Pole

MM-10-124		
	Description	24" (610mm) Tall Pole with Round Base. 1.75" (45mm) Diameter
	Shipping Dimensions	4.82" L X 4.81" W X 29.25" D
	Shipping Weight (lbs/kg)	3.50/1.59
	Note:	Not for use with Free Standing Base option

MM-10-101		
	Description	16" (406mm) Tall Pole with Rectangular Base. 1.75" (45mm) Diameter
	Shipping Dimensions	6.75" L X 2.63" W X 16.5" D
	Shipping Weight (lbs/kg)	2.75/1.25
	Note:	Not for use with Free Standing Base option

MM-10-102		
	Description	24" (610mm) Tall Pole with Rectangular Base. 1.75" (45mm) Diameter
	Shipping Dimensions	6.75" L X 2.63" W X 24.5" D
	Shipping Weight (lbs/kg)	3.80/1.73
	Note:	Not for use with Free Standing Base option



MM-1000 FOR NEW INSTALLATIONS

PART NUMBERS AND DETAILS

MM-10-199

	Description	Free Standing Base
	Shipping Dimensions	14" L X 14" W X 2" D
	Shipping Weight (lbs/kg)	10.1/4.6
	Note:	For use with MM-10-116 only. Do not use for Monitor Mounts on 8" Arms nor Printer and Payment Mounts on Folding Arm Extensions.

MM-10-202 (FOR PAYMENT ONLY)

	Description	Collar Arm 8" (200mm) for use with existing 45mm Diameter Poles
	Shipping Dimensions	5.13" L X 3.62" W X 8.0" D
	Shipping Weight (lbs/kg)	3.00/1.36
	Note:	Use for positioning Payment Terminal Mount away from your existing pole and adding side-to-side movement. Rotates up to 320°

MM-10-203

	Description	Channel Mount for use with Havis MM-10-1XX Poles only
	Shipping Dimensions	4.56" L X 4.56" W X 3.56" D
	Shipping Weight (lbs/kg)	0.36/0.16
	Note:	Use for attaching Single or Double Pivot Monitor Mount close to Havis Pole

MM-10-204

	Description	Channel Arm 8" (200mm) for use with Havis MM-10-1XX Poles only
	Shipping Dimensions	5.13" L X 3.62" W X 8.0" D
	Shipping Weight (lbs/kg)	0.73/0.33
	Note:	Use for positioning Payment Terminal and Printer Mounts away from existing pole. May also be used to extend Monitor Mount away from Pole. Required for all Payment and Printer Mounts



MM-1000 FOR NEW INSTALLATIONS

PART NUMBERS AND DETAILS

MM-10-301

	Description	Monitor Mount - Single Pivot (Up/Down) for 75/100MM VESA Monitors
	Shipping Dimensions	4.56" L X 4.56" W X 3.56" D
	Shipping Weight (lbs/kg)	0.89/0.40
	Note:	Max Monitor Weight: 15lbs. +/- 68° Tilt*

MM-10-302

	Description	Monitor Mount - Double Pivot (Up/Down, Left/Right) for 75/100MM VESA Monitors
	Shipping Dimensions	4.56" L X 4.56" W X 5.56" D
	Shipping Weight (lbs/kg)	1.16/0.53
	Note:	Max Monitor Weight: 15lbs. Up to 330° Rotation. -32°/+90° Tilt*

MM-10-320

	Description	Monitor Mount on 16" Folding Extension Arm
	Shipping Dimensions	20" L X 4" W x 4" D
	Shipping Weight (lbs/kg)	4.00/1.8
	Note:	Max Monitor Weight: 10lbs. Up to 180° Rotation. 140° Tilt* Do not use with Free Standing base option

MM-10-401

	Description	Payment Terminal Mount - Compatible with any FlexiPole Backplate
	Shipping Dimensions	5.06" L X 4.62" W X 8.06" D
	Shipping Weight (lbs/kg)	0.76/0.34
	Note:	To mount a Havis Stand Metal Conversion - use MM-10-402 and contact Havis Sales for appropriate Conversion Part Number FlexiPole Backplate required to complete this product Up to 180° Rotation. -21°/+180° Tilt*



MM-1000 FOR NEW INSTALLATIONS

PART NUMBERS AND DETAILS

MM-10-420

	Description	Payment Terminal Mount on 16" Folding Extension Arm
	Shipping Dimensions	10" L x 6" W x 8" D
	Shipping Weight (lbs/kg)	4.00/1.8
	Note:	Up to 135° payment device tilt and 180° rotation Do not use with Free Standing base option

MM-10-601

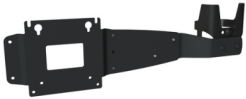
	Description	Scanner Mount for Handheld Scanners
	Shipping Dimensions	5.18" L X 4.50" W X 10.38" D
	Shipping Weight (lbs/kg)	3.14/1.42
	Note:	Works with VESA Monitors from 15" (381mm) to 20" (508mm) W

MM-10-501

	Description	Small Printer Mount - Up to 180° Rotation
	Shipping Dimensions	7.13" L X 7.13" W X 3.88" D
	Shipping Weight (lbs/kg)	1.19/0.54
	Note:	For Printers with bases up to 5.7" (145mm) W x 6" (153mm) D

MM-10-505

	Description	Medium Printer Mount - Up to 180° Rotation
	Shipping Dimensions	9" L X 7" W X 3" D
	Shipping Weight (lbs/kg)	2.00/0.91
	Note:	For Printers with bases up to 7.9" (201mm) W x 5.9" (151mm) D

*tilt/rotation limits are subject to monitor size and position on pole



MM-1000 FOR NEW INSTALLATIONS

PART NUMBERS AND DETAILS

MM-10-502

	Description	Large Printer Mount - Up to 180° Rotation
	Shipping Dimensions	12.63" L X 8.13" W X 3.88" D
	Shipping Weight (lbs/kg)	2.61/1.18
	Note:	For Printers with bases up to 7.8" (198mm) W x 11.26" (286mm) D

MM-10-520

	Description	Printer Mount - Includes 16" Folding Extension Arm & Small Tray - Provides 360° Printer Rotation
	Shipping Dimensions	12" L X 6" W X 10" D
	Shipping Weight (lbs/kg)	6.00/2.7
	Note:	For Printers with bases up to 5.7" (144mm) W x 6" (152mm) D Do not use with Free Standing base option

MM-10-521

	Description	Printer Mount - Includes 16" Folding Extension Arm & Medium Tray - Provides 360° Printer Rotation
	Shipping Dimensions	12" L X 6" W X 10" D
	Shipping Weight (lbs/kg)	7.00/3.2
	Note:	For Printers with bases up to 7.9" (200mm) W x 5.9" (149) D Do not use with Free Standing base option

MM-10-522

	Description	Printer Mount - Includes 16" Folding Extension Arm & Large Tray - Provides 360° Printer Rotation 180° Rotation
	Shipping Dimensions	14" L X 6" W X 10" D
	Shipping Weight (lbs/kg)	8.00/3.6
	Note:	For Printers with bases up to 7.8" (198mm) W x 11.26" (286mm) D Do not use with Free Standing base option



MM-1000 FOR NEW INSTALLATIONS

PART NUMBERS AND DETAILS

MM-10-901		
	Description	Large Cable Bundle Cover Kit
	Shipping Dimensions	12" L X 4" W X 4" D
	Shipping Weight (lbs/kg)	0.50/0.23
	Note:	Use with Havis MM-10-1XX Poles only. Works for any length pole.



MM-1000 FOR NEW INSTALLATIONS

PRODUCT DIMENSIONS

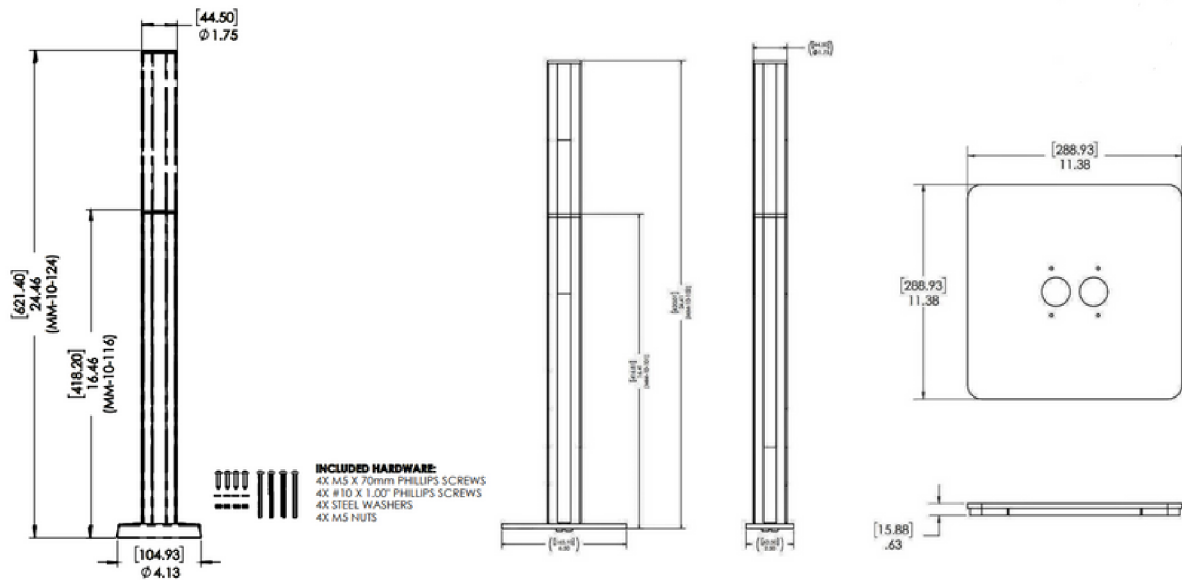

Pole & Round Base
16" or 24"

Pole & Rectangular Base
16" or 24"

Free Standing Base Option
For use with 16" Round Base only

Single Pivot Monitor Arm

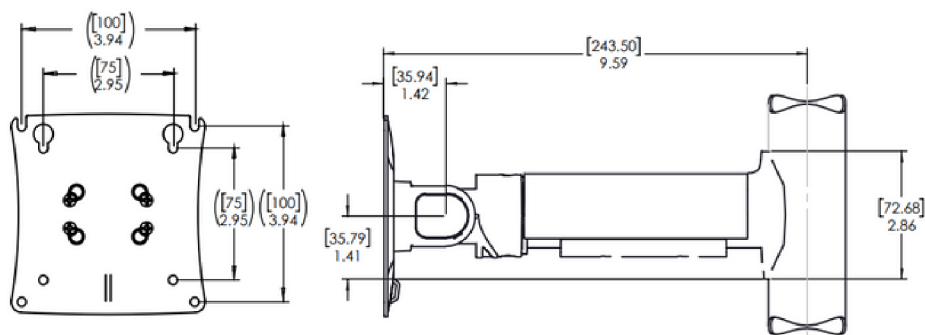

Double Pivot Monitor Arm

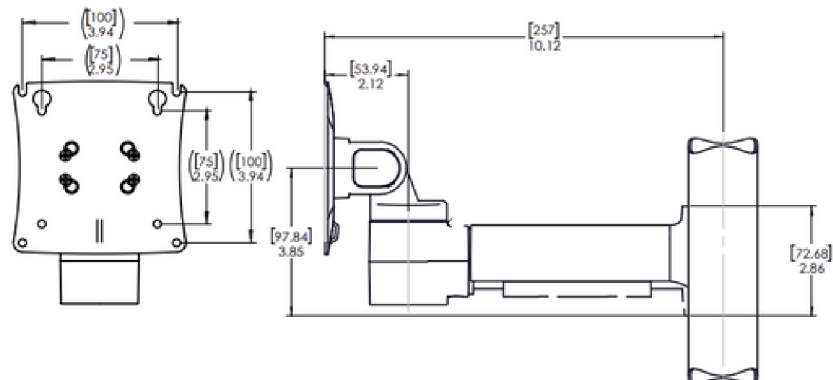



MM-1000 FOR NEW INSTALLATIONS

PRODUCT DIMENSIONS

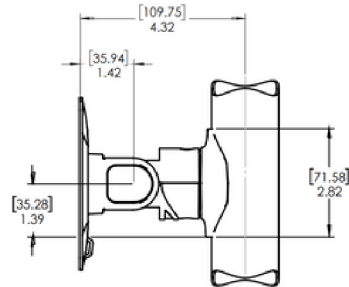
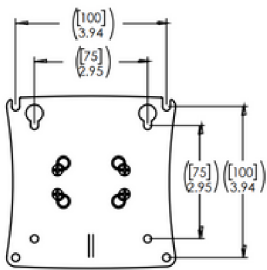

Single Pivot Monitor Mount

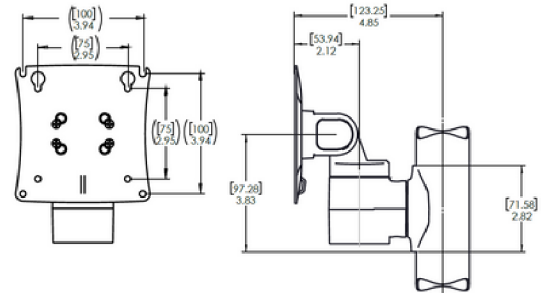

Double Pivot Monitor Mount

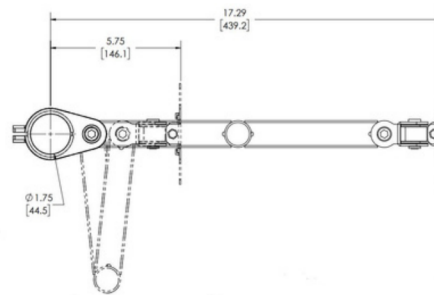

Monitor Mount on 16" Folding Extension Arm

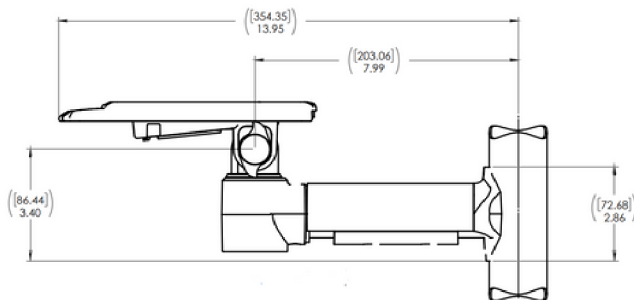

Payment Terminal Mount
with MM-10-204

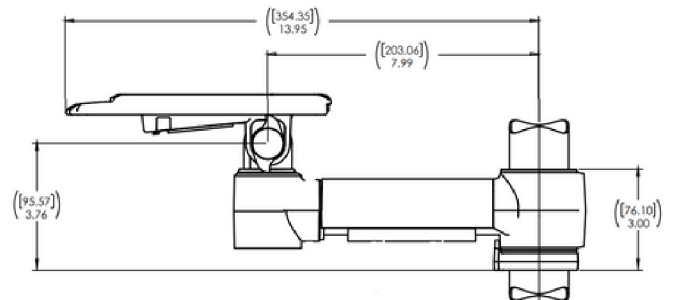

Payment Terminal Mount
with MM-10-202

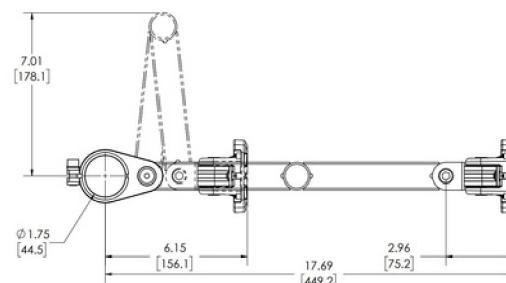

Payment Terminal Mount on 16" Folding Extension Arm



MM-1000 FOR NEW INSTALLATIONS

PRODUCT DIMENSIONS

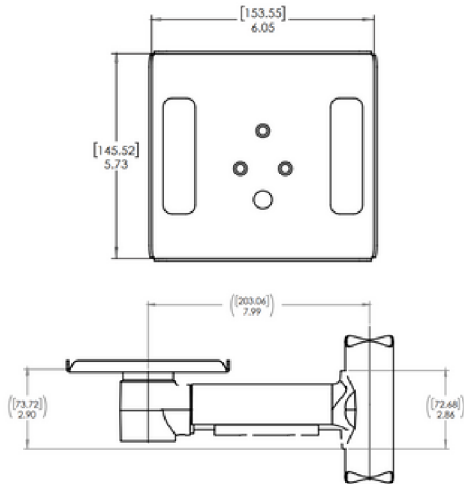

Small Printer Mount

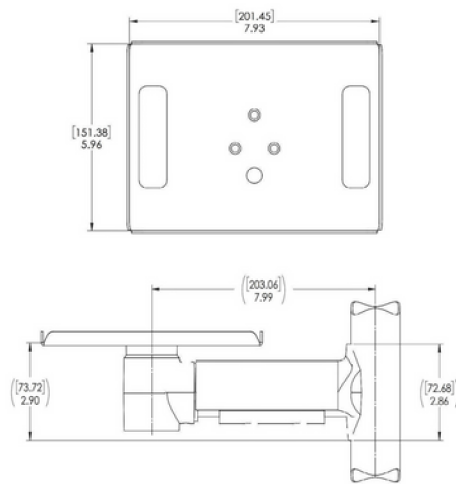

Medium Printer Mount

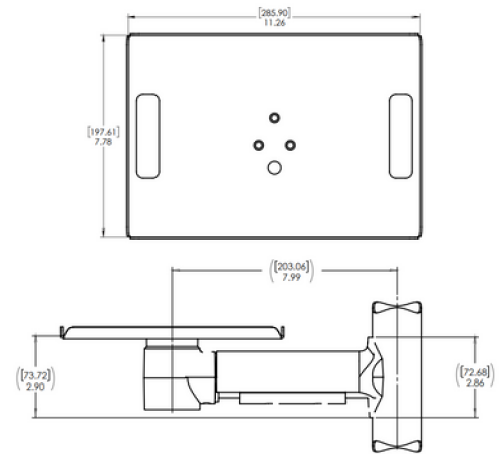

Large Printer Mount

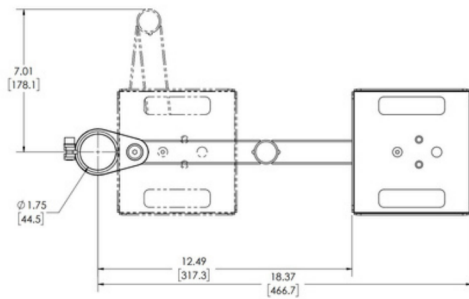

Printer Mount - 16" Folding
Extension Arm - Small Tray

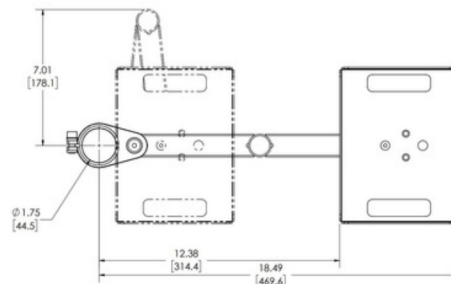

Printer Mount - 16" Folding
Extension Arm - Medium Tray

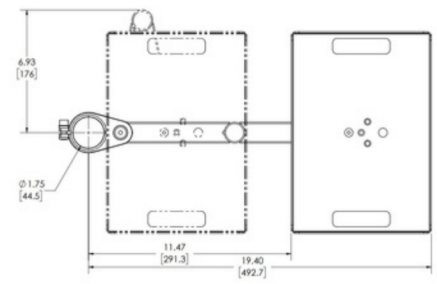

Printer Mount - 16" Folding
Extension Arm - Large Tray

MM-1000 FOR NEW INSTALLATIONS

PRODUCT DIMENSIONS

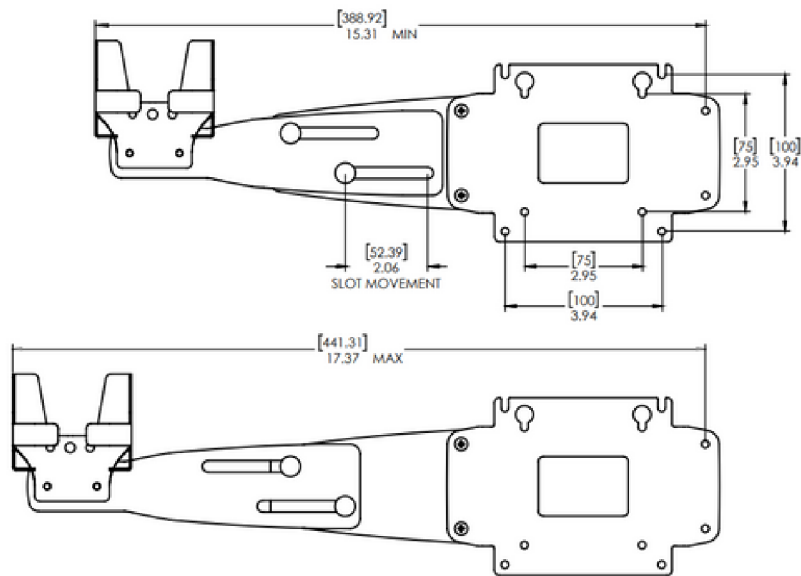

Scanner Mount

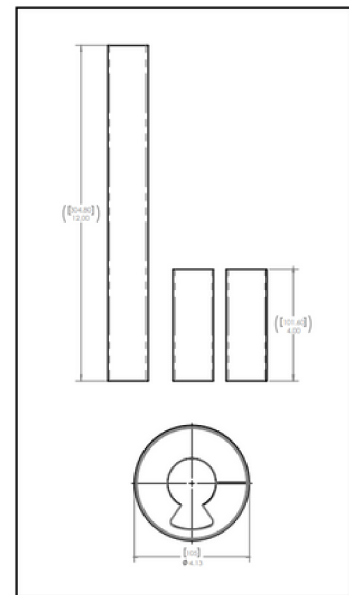

Large Cable Bundle Kit



16" POLE SAMPLE CONFIGURATION #1

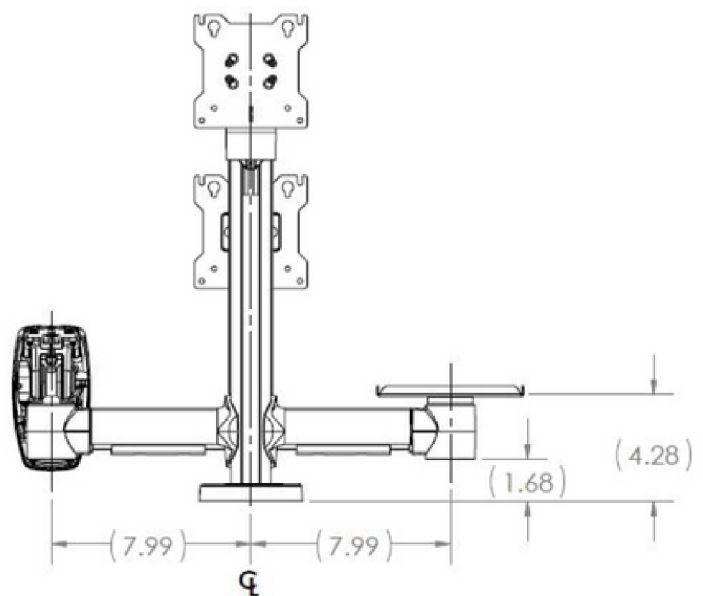
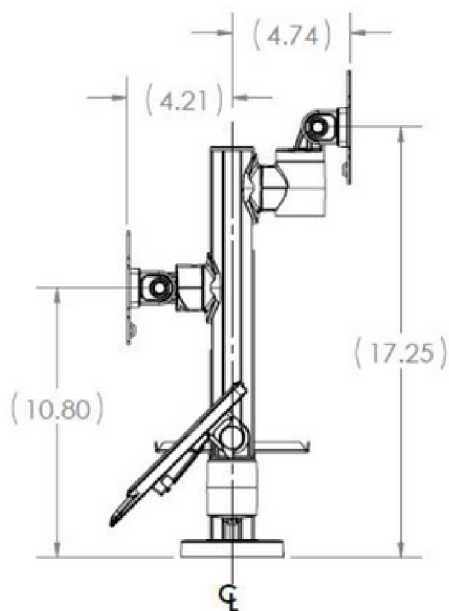
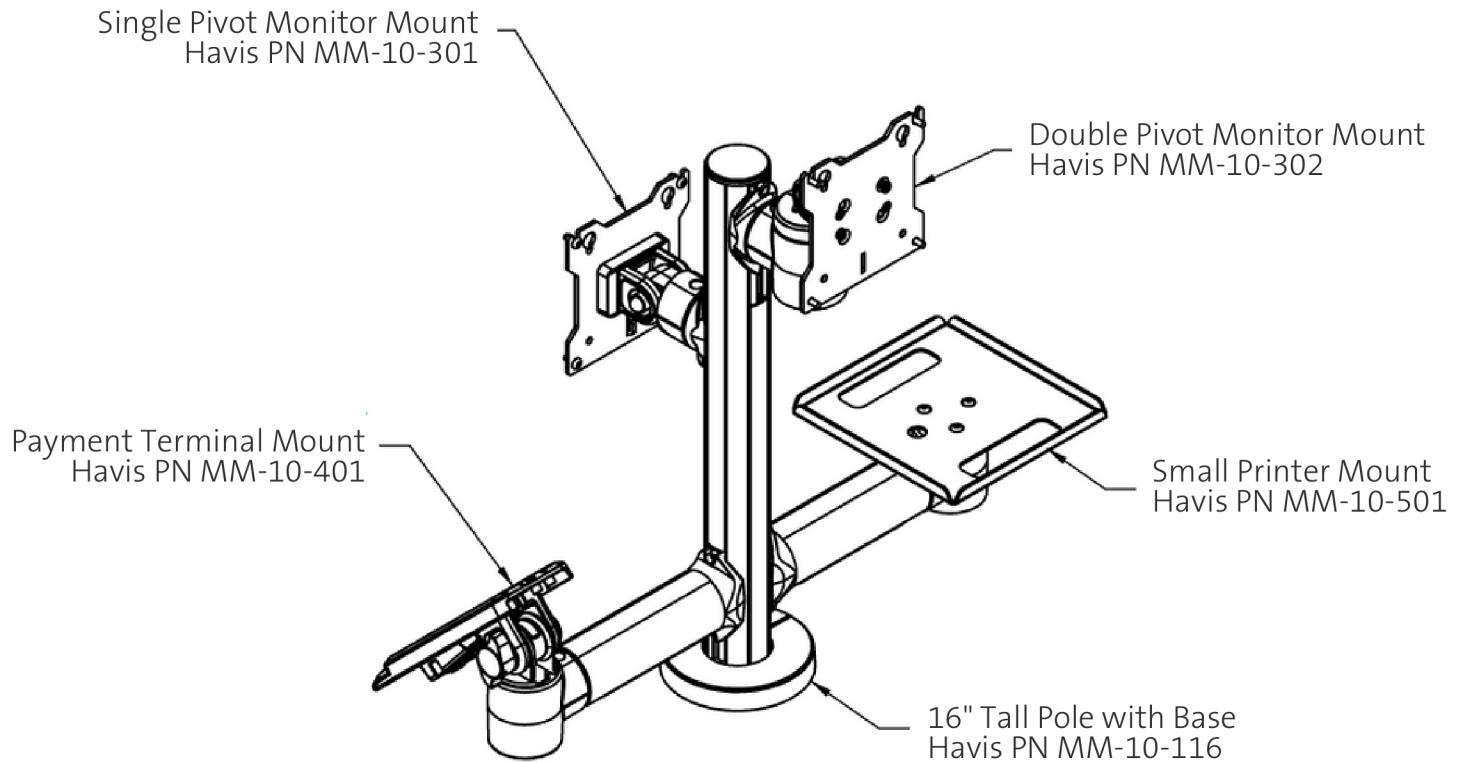



16" POLE SAMPLE CONFIGURATION #2

Printer Mount with 16" Folding
Extension Arm & Medium Tray
Havis PN MM-10-521

16" Tall Pole with Base
Havis PN MM-10-116

Payment Terminal Mount
on 16" Extension Arm
Havis PN MM-10-420

Single Pivot Monitor Mount
Havis PN MM-10-301

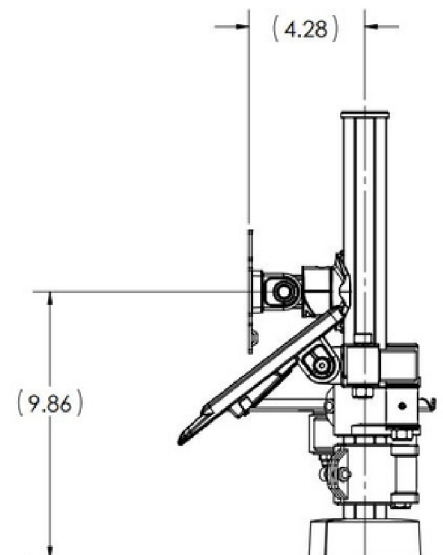
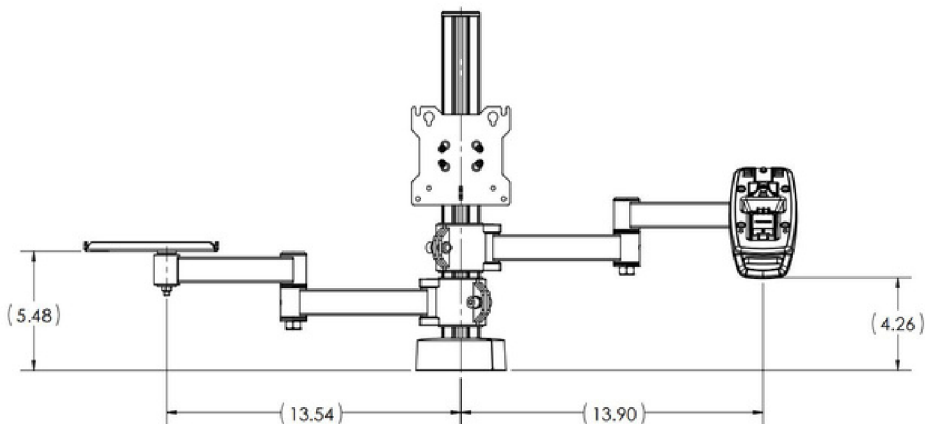
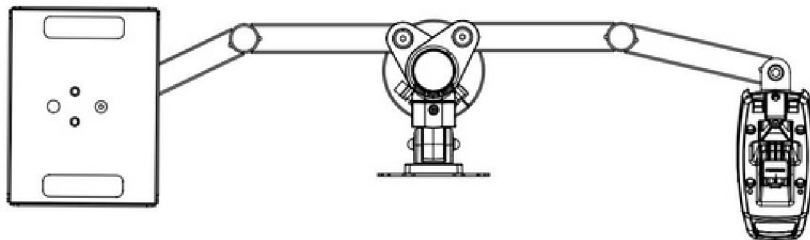

24" SAMPLE CONFIGURATION

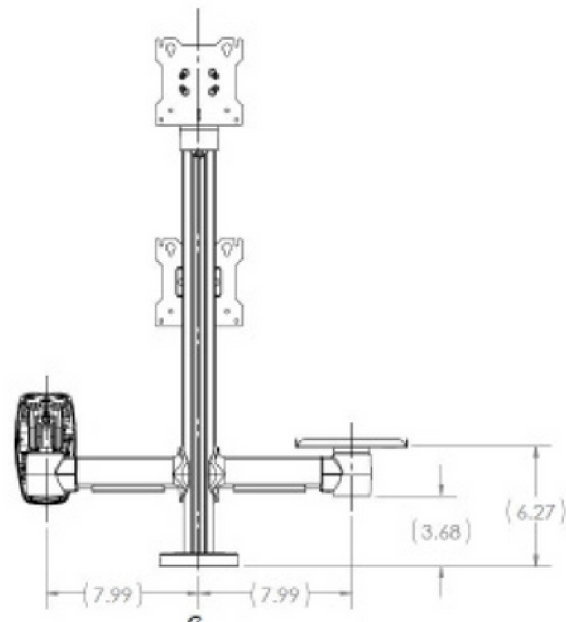
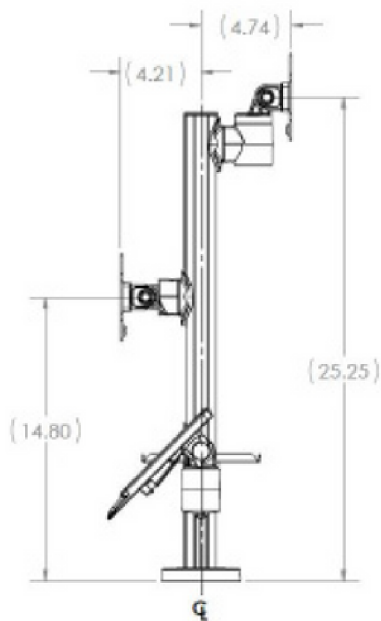
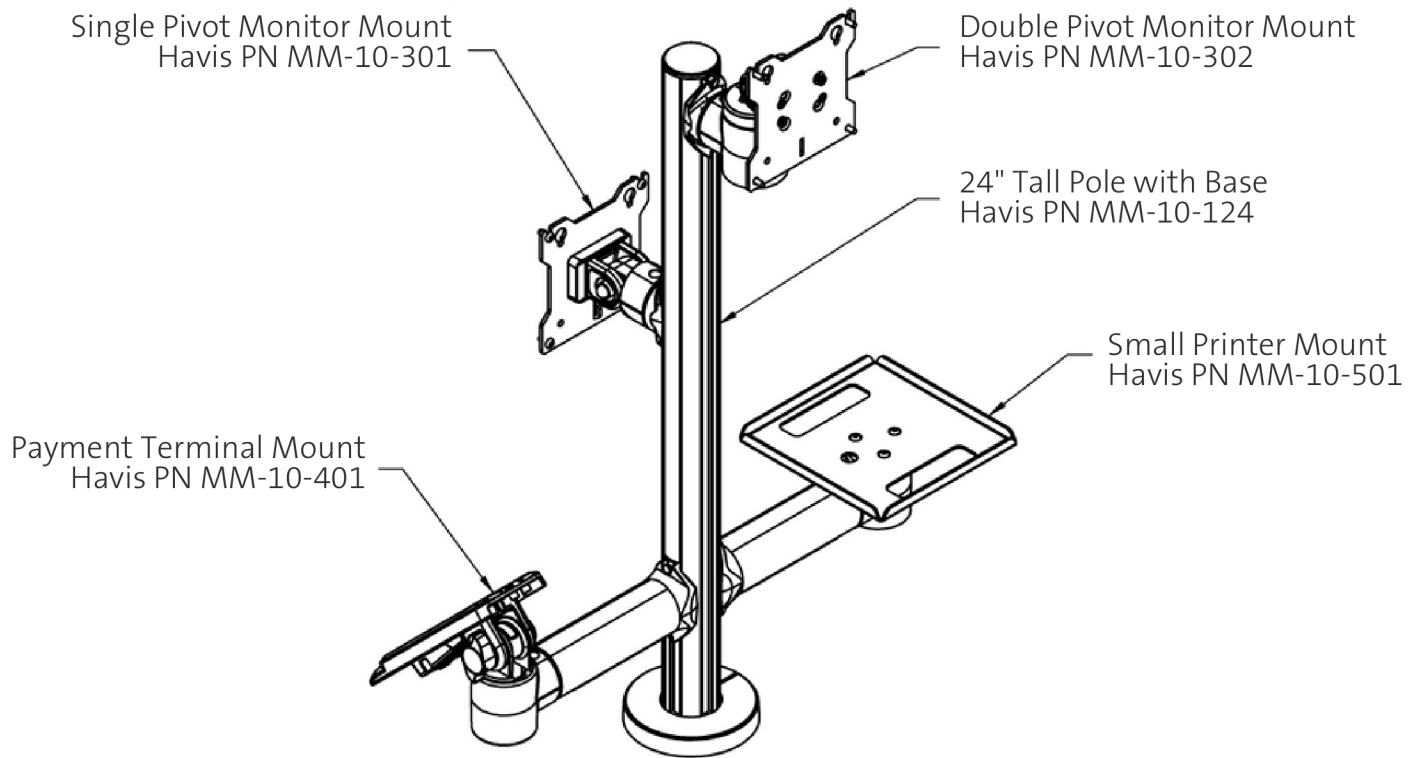

MM-10-116 & MM-10-124 POLE & ROUND BASE DRILL GUIDES

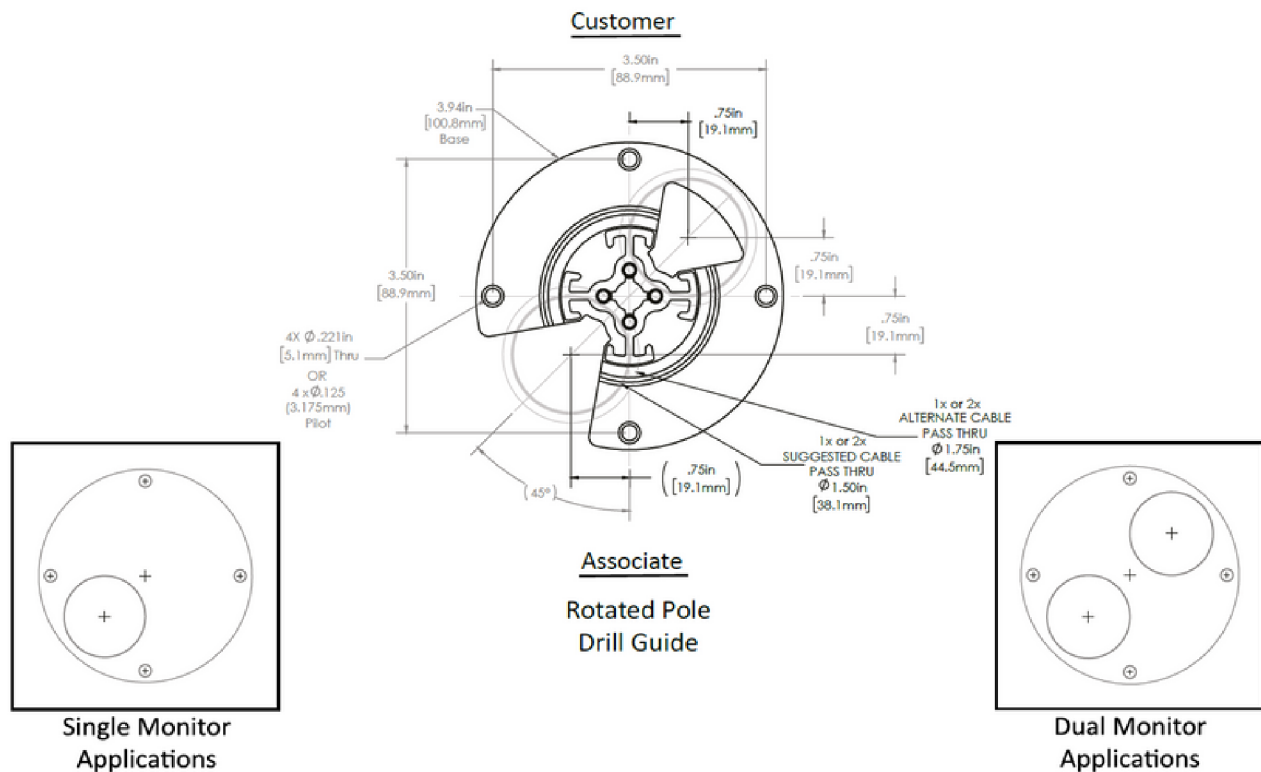
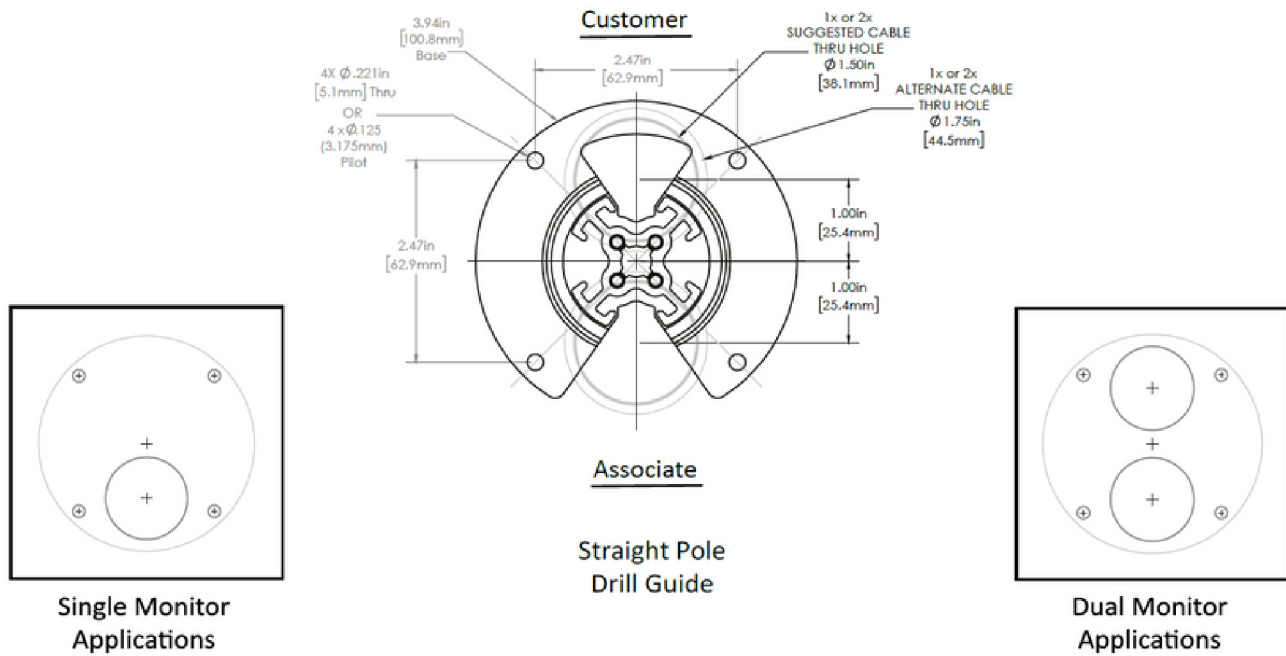

MM-10-116 & MM-10-124 POLE & RECTANGLE BASE DRILL GUIDES

