

INSTALLATION INSTRUCTIONS

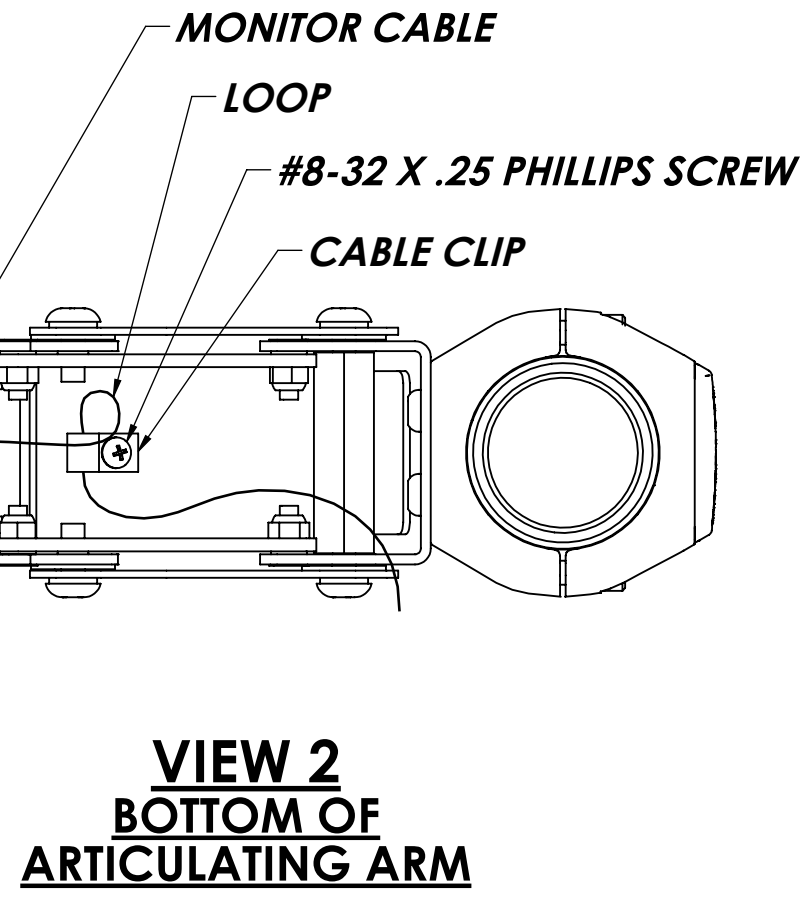
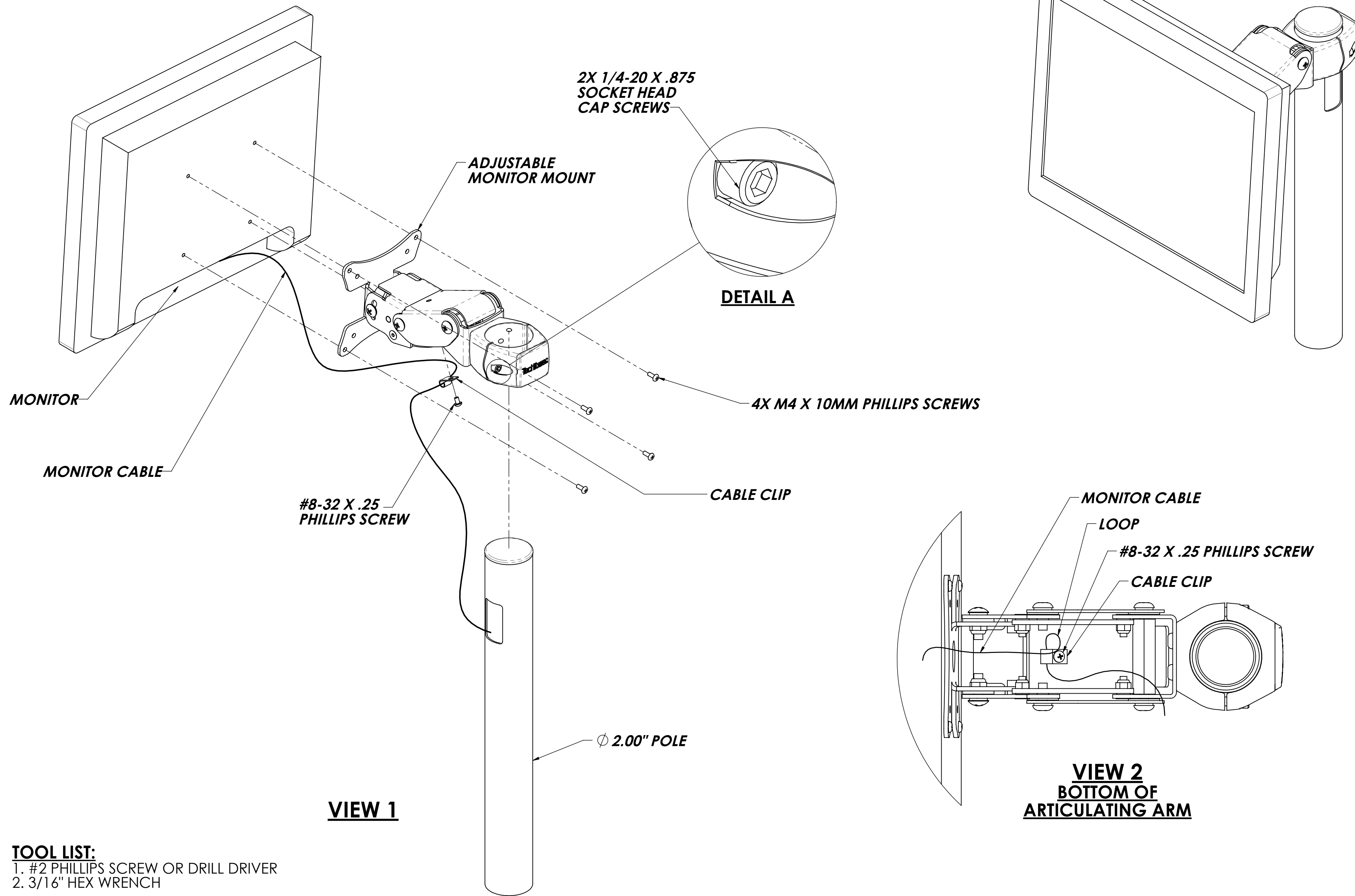

VIEW 1

**VIEW 2
BOTTOM OF
ARTICULATING ARM**

TOOL LIST:

1. #2 PHILLIPS SCREW OR DRILL DRIVER
2. 3/16" HEX WRENCH

ASSEMBLY STEPS:

1. SLIDE THE **ADJUSTABLE MONITOR MOUNT** ONTO THE \varnothing 2.00" **POLE** AND TIGHTEN **2X 1/4-20 X .875 SOCKET HEAD CAPS SCREWS** AS SHOWN IN **DETAIL A**.
2. INSTALL THE **MONITOR** TO THE **ADJUSTABLE MONITOR MOUNT** USING THE **4X M4 X 10MM PHILLIPS SCREWS** AS SHOWN IN **VIEW 1**.
3. WITH THE **ADJUSTABLE MONITOR MOUNT** IN THE **DOWN POSITION**, ROUTE THE **MONITOR CABLE LOOP** AS SHOWN IN **VIEW 2**. THEN SECURE THE **MONITOR CABLE** USING THE **CABLE CLIP** AND **#8-32 X .25 PHILLIPS SCREW** AS SHOWN IN **VIEW 2**.

THE INFORMATION CONTAINED IN THE DRAWING IS THE SOLE PROPERTY OF HAVIS, INC. AND REPRODUCTION IN PART OR IN WHOLE WITHOUT THE WRITTEN PERMISSION OF HAVIS, INC. IS PROHIBITED.

DIMS. AND TOLERANCES PER ASME Y14.5 - 1994
UNLESS OTHERWISE SPECIFIED DIMENSIONS ARE IN INCHES TOLERANCES ARE:
FRACTIONAL ± 1/32
2 PLC. DEC. ± .03
3 PLC. DEC. ± .010
ANGULAR ± 0°30'

REV.	DESCRIPTION	DATE	BY	CHK'D
F		01/31/14	JEB	SY
J. SORENSON		2/2/2011		
		Havis, Inc. 14451 Ewing Ave. Burnsville, MN 55306		
TITLE: INSTALLATION INSTRUCTIONS, MONITOR ARM, ARTICULATING HEIGHT, NON ROTATING, FIXED POLE CLAMP INCLUDED				
SIZE	DWG. NO.	REV.	F	
C	367-2008-40		SHEET 1 OF 1	