

REVISION G CHANGES = **G**

(10 CHANGES NOTED ON DRAWING)

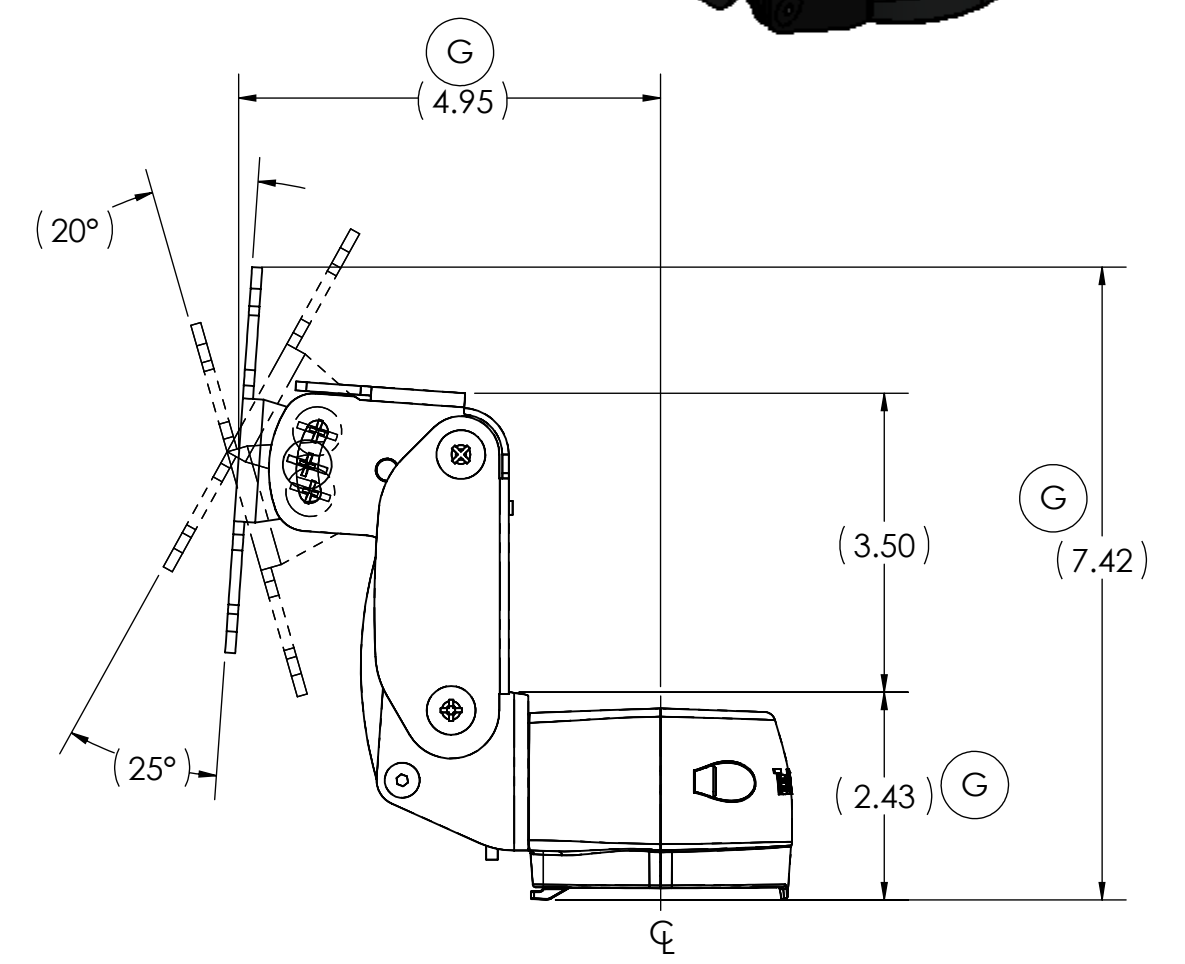
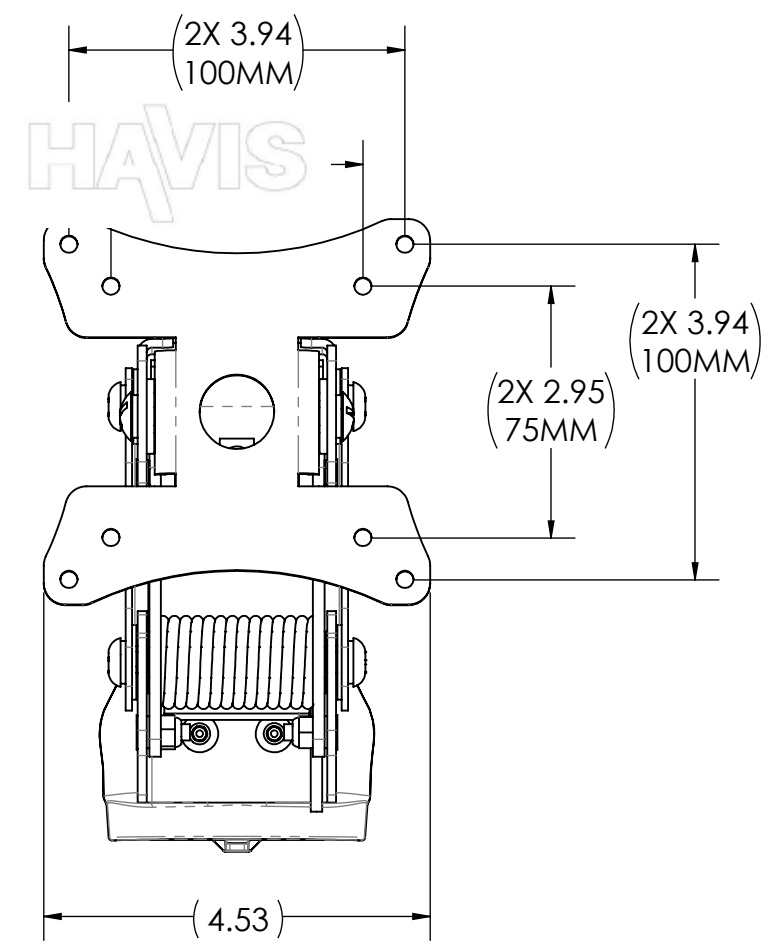
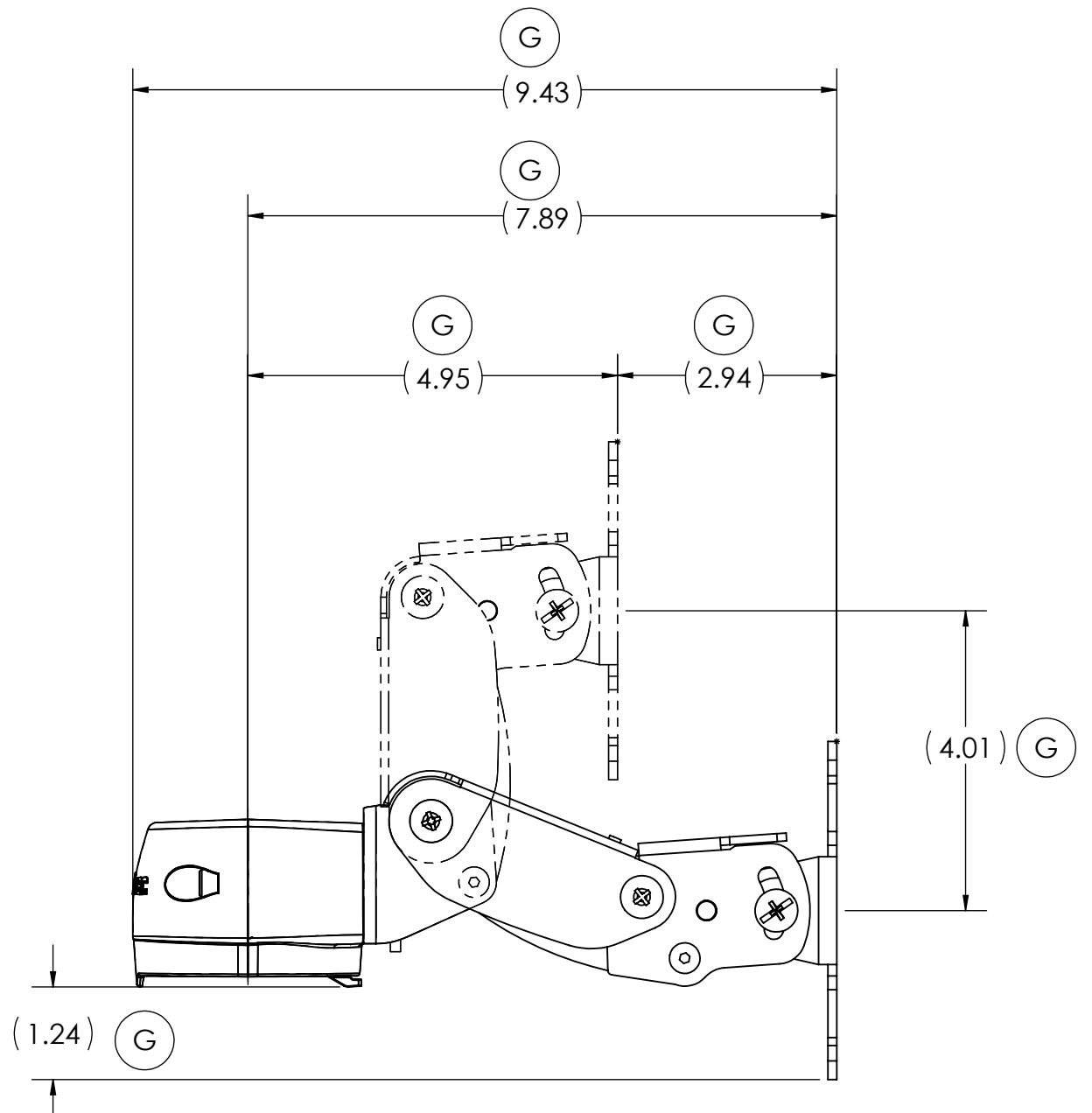
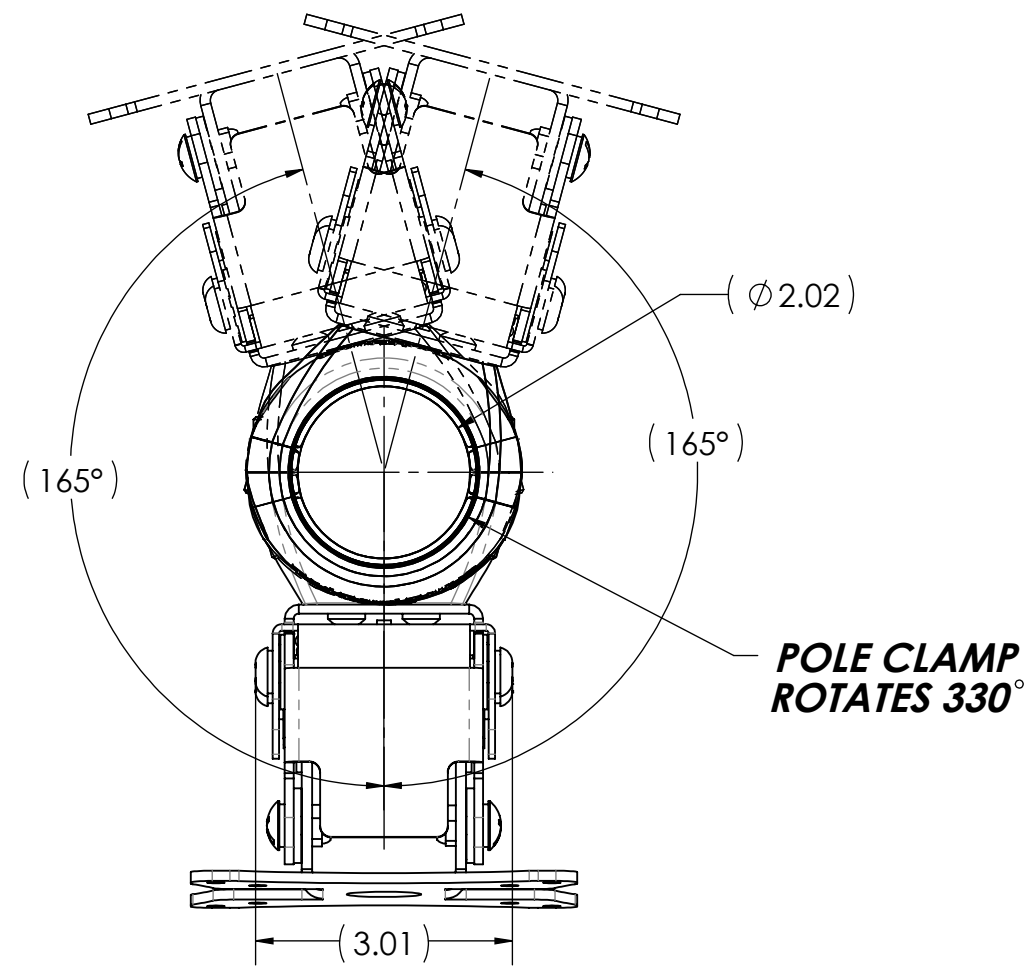
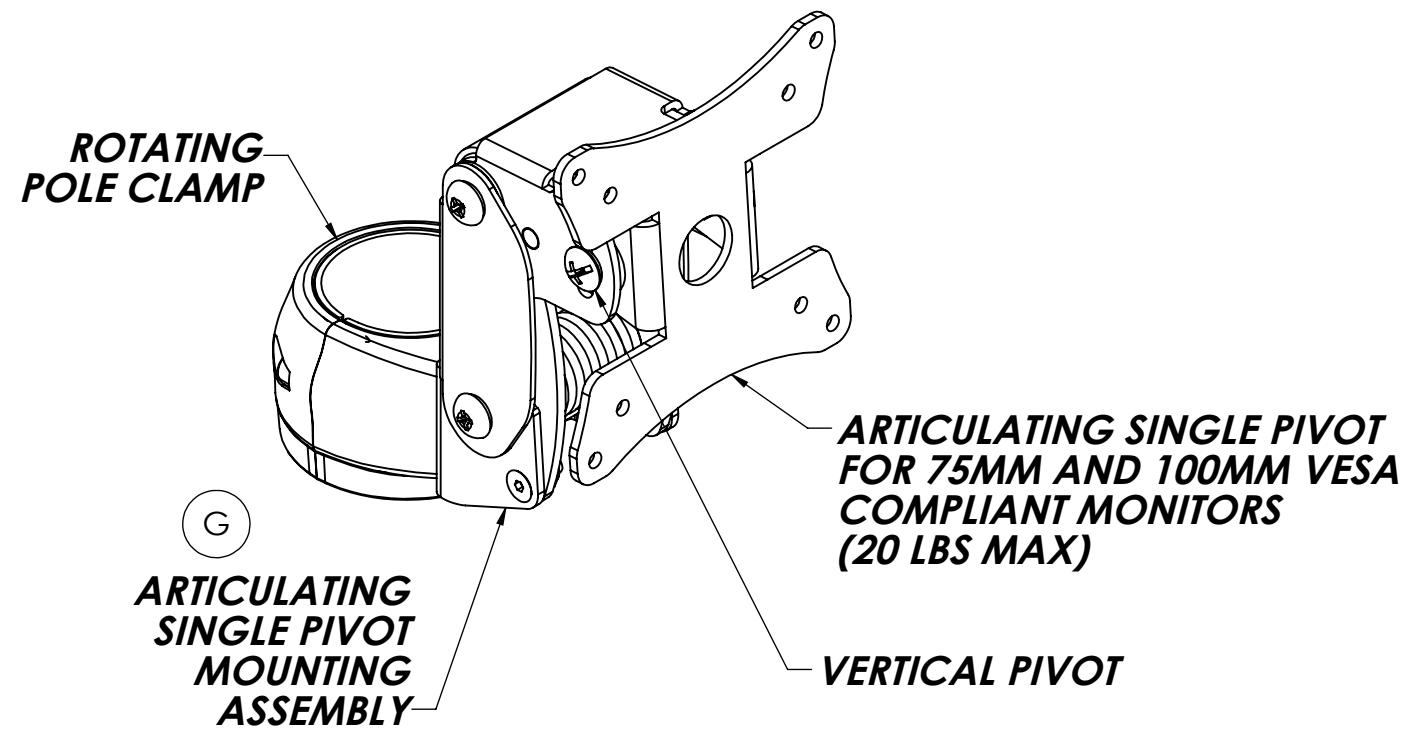

REV.	DESCRIPTION	DATE	BY	CHK'D
G	REVISED ARTICULATING SINGLE PIVOT MOUNTING ASSEMBLY TO ELIMINATE PARTS NOT USED WITH NEW ROTATING CLAMP DESIGN. DIM 1.24 WAS 1.38, 4.95 WAS 5.20, 2.94 WAS 2.82, 7.89 WAS 8.02, 9.43 WAS 9.56, 2.43 WAS 2.30, 7.42 WAS 7.28, ADDED DIMS 4.01, 4.95	09/23/14	JEB	RKT
F	REVISED ARTICULATING SINGLE PIVOT MOUNTING BRACKET TO FIT NEW ROTATING CLAMP DESIGN. DIM 1.38 WAS 1.50, 2.30 WAS 2.18, 7.28 WAS 7.04	02/04/14	JEB	SY
E-MOD	REVISED ARTICULATING SINGLE PIVOT MOUNTING BRACKET TO FIT NEW ROTATING CLAMP DESIGN. DIM 9.56 WAS 9.99, 8.02 WAS 8.31, 5.20 WAS 5.49, 1.50 WAS 1.59, 7.04 WAS 6.95, 165° WAS 90°, 330° ROTATION WAS 180°	01/21/14	JEB	SY
E	REVISED ENS1936A AND ENS1936D, ADDED 2X 1/4-20 X .75 PTHMS SHOULDER GRADE 5, 2X 1/4-20 NYLOCK NUTS WERE 2X TOPLOCK NUTS	01/23/12	JVT	

THE INFORMATION CONTAINED IN THIS DRAWING IS THE SOLE PROPERTY OF HAVIS AND REPRODUCTION IN PART OR IN WHOLE WITHOUT THE WRITTEN PERMISSION OF HAVIS IS PROHIBITED.

HAVIS

CUSTOMER VERIFICATION AND AUTHORIZATION

DRAWN	J. SORENSON	HAVIS	
DATE	02/02/11		
CUSTOMER APPROVAL (SIGNATURE REQUIRED):		TITLE	TECHTOWER, ARTICULATING ARM, SINGLE PIVOT, ROTATING POLE CLAMP
DATE		SIZE	C
		DWG. NO.	367-2008-45
		REV. G	SHEET 1 OF 1