

INSTALLATION INSTRUCTIONS

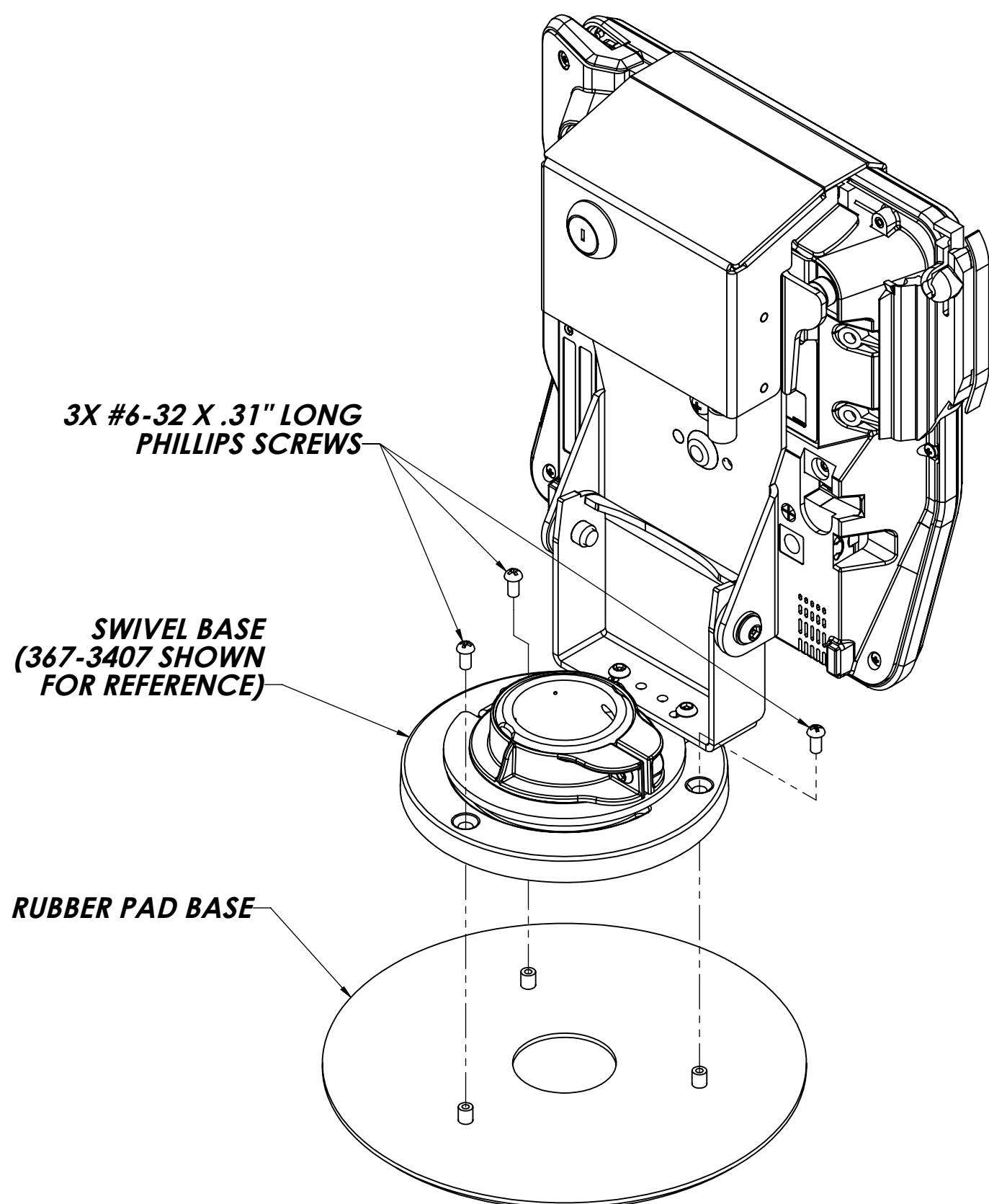

ENS SWIVEL STAND ASSEMBLY

CUSTOMER'S EXISTING GENESIS STAND (367-3433 SHOWN FOR REFERENCE) SWIVEL STAND TO ALIGN SCREWS TO MOUNTING HOLES IN GLUE PAD BASE

TO REMOVE COVER, PULL FROM THIS GROOVE

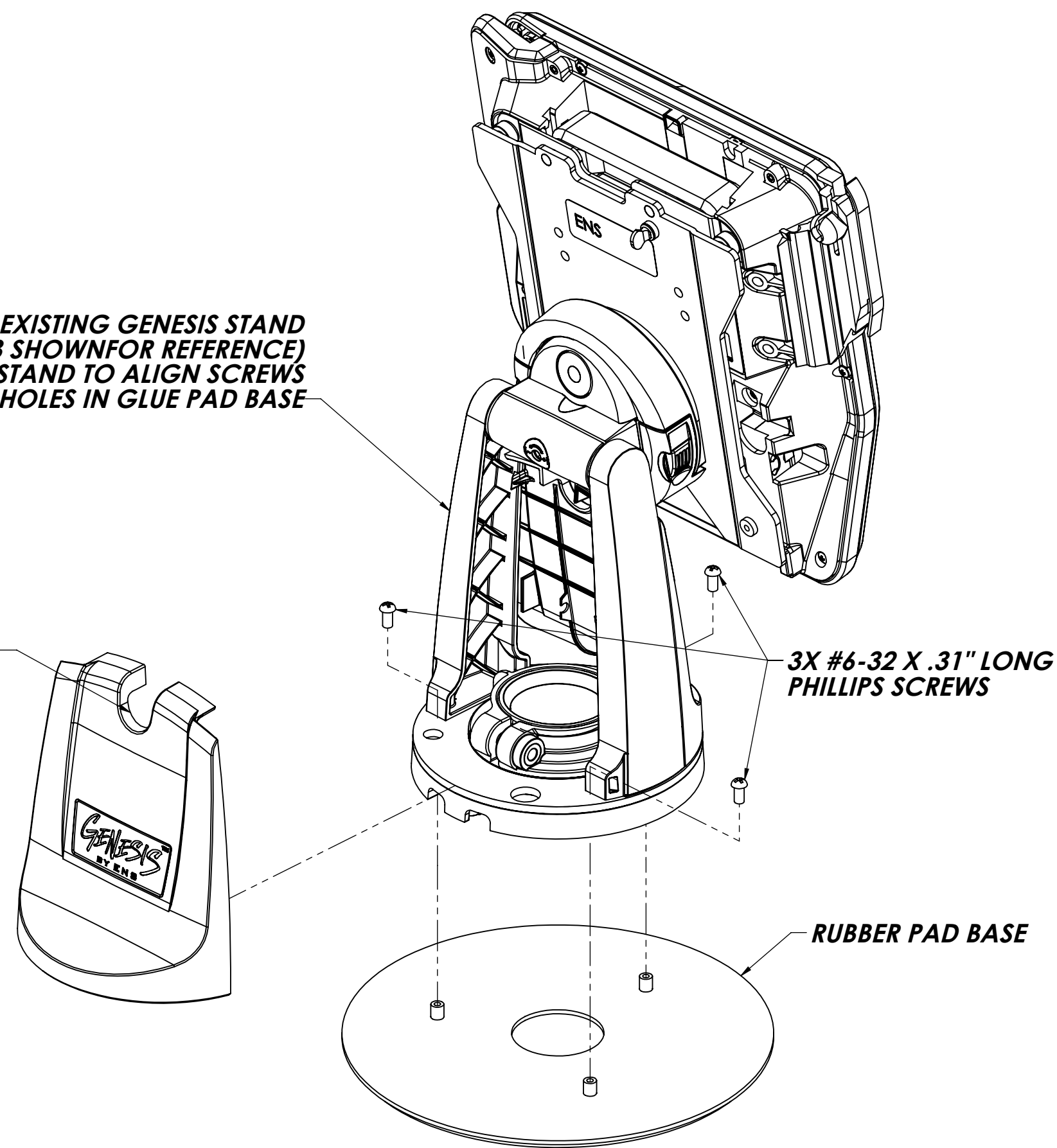

ENS GENESIS STAND ASSEMBLY

TOOLS LIST:

1. #2 PHILLIPS SCREW DRIVER

ASSEMBLY STEPS:

1. ASSEMBLE **RUBBER PAD BASE** TO **CUSTOMER'S ENS SWIVEL OR GENESIS STAND** USING **3X #6-32 X .31" LONG PHILLIPS SCREWS** AS SHOWN.
2. REFER TO INSTRUCTIONS INCLUDED WITH **SWIVEL OR GENESIS STAND** TO FINISH CREDIT CARD MACHINE / TABLET INSTALLATION.

	B		9/22/05	JGC	AZM
REV.		DESCRIPTION	DATE	BY	CHK'D
DIMS. AND TOLERANCES PER ASME Y14.5 - 1994		<p style="margin: 0;">TITLE CUSTOMER INSTRUCTIONS, 7.00" DIAMETER METAL BASE, WITH RUBBER PAD</p>			
UNLESS OTHERWISE SPECIFIED DIMENSIONS ARE IN INCHES TOLERANCES ARE:					
FRACTIONAL	± 1/32				
2 PLC. DEC.	± .03				
3 PLC. DEC.	± .010				
ANGULAR	± 0°30'				
DRAWN J. CHRISTOPHERSON					
DATE 7/19/2005					
CHECKED					
DATE					
DO NOT SCALE DRAWING					
MATERIAL					
FINISH					
SIZE	C	DWG. NO.	367-0731-R		REV. B
					SHEET 1 OF 1

THE INFORMATION CONTAINED IN THIS DRAWING IS THE SOLE PROPERTY OF HAVIS AND REPRODUCTION IN PART OR IN WHOLE WITHOUT THE WRITTEN PERMISSION OF HAVIS IS PROHIBITED.