

INSTALLATION INSTRUCTIONS

TOOLS LIST:

1. #2 PHILLIPS SCREW OR DRILL DRIVER
2. 3/16" HEX WRENCH

ASSEMBLY STEPS:

1. SLIDE THE **MONITOR DOUBLE PIVOT ASSEMBLY** ONTO THE **POLE** AND HOLD AT THE DESIRED HEIGHT.
2. TIGHTEN THE **2X 1/4-20 SOCKET HEAD SCREWS** TO SECURE THE **MONITOR PIVOT ASSEMBLY** TO THE **POLE**.
3. ASSEMBLE THE **UPPER 2X M4 X 10MM LONG PHILLIPS SCREWS** INTO TOP HOLES OF **MONITOR** LEAVING ABOUT 1/8" OF SPACE BETWEEN THE BACK OF THE **MONITOR** AND THE SCREW HEAD, THEN PLACE THE **MONITOR** ONTO **MONITOR BRACKET** USING EITHER THE **VESA 100MM SLOT** OR **VESA 75MM KEYHOLE** PATTERN. SEE: **DETAIL A**
4. WITH THE **MONITOR** RESTING ON THE **MONITOR PIVOT ASSEMBLY** INSTALL THE **LOWER 2X M4 X 10MM LONG PHILLIPS SCREWS** AND TIGHTEN BOTH THE **UPPER 2X M4 X 10MM LONG PHILLIPS SCREWS** AND **LOWER 2X M4 X 10MM LONG PHILLIPS SCREWS** TO SECURE THE **MONITOR**.
5. **OPTIONAL:** LOOP THE **6" BLACK CABLE TIE** THROUGH THE **MONITOR BRACKET BRIDGE LANCE**. MAKE SURE **MONITOR CABLES** ARE INSIDE THE LOOP AND SECURE BY PULLING **6" BLACK CABLE TIE** TIGHT AS SHOWN IN **DETAIL B**.

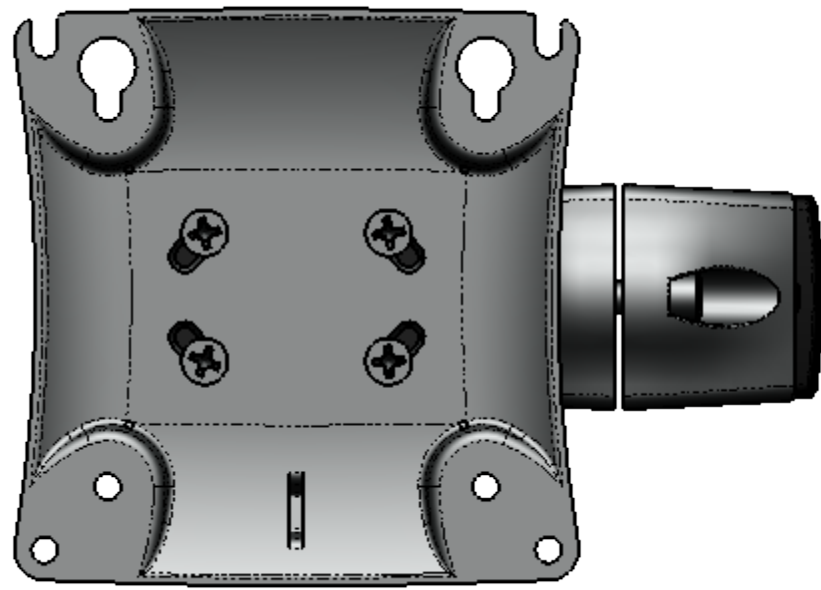
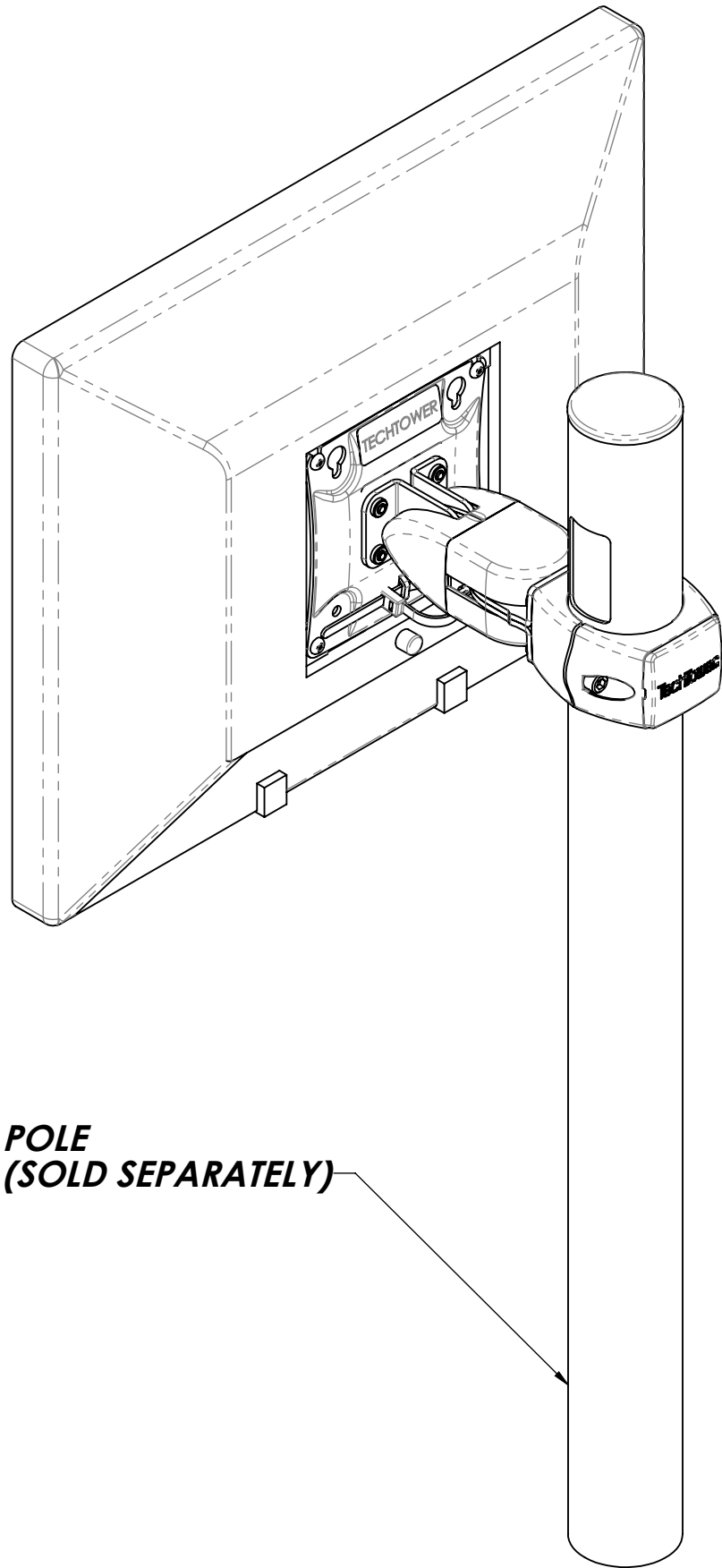
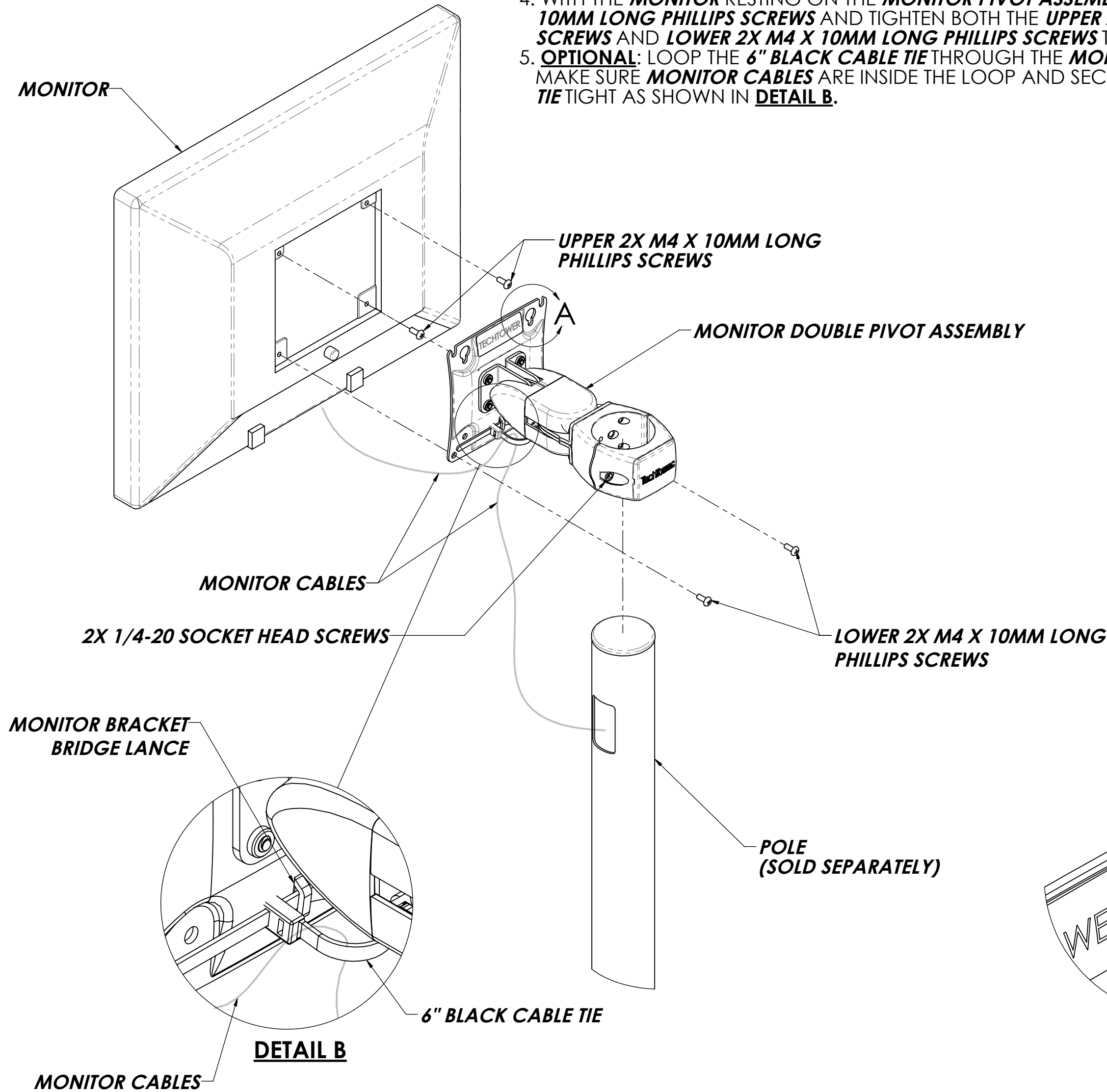

**FRONT VIEW OF
MONITOR MOUNTING BRACKET**

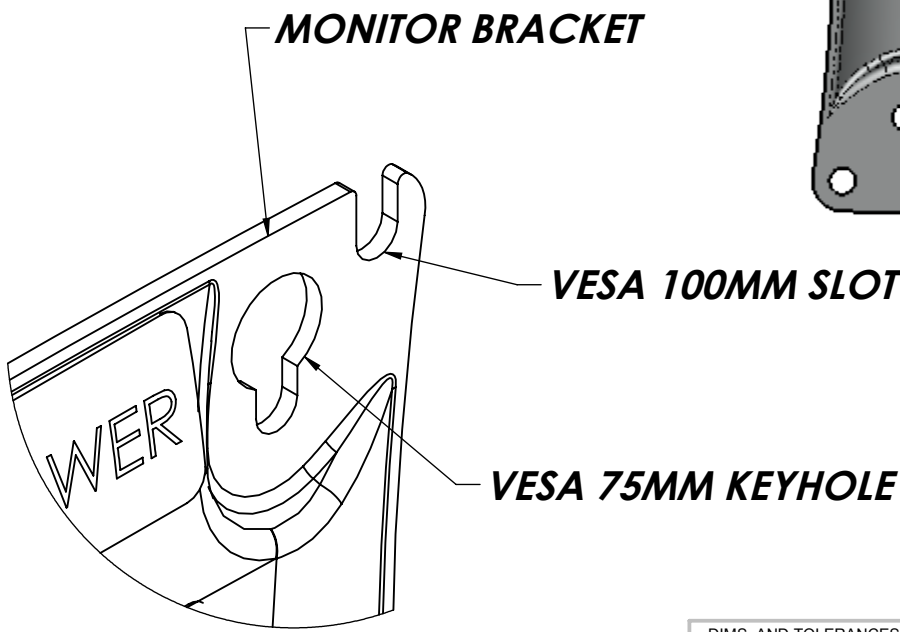

DETAIL A

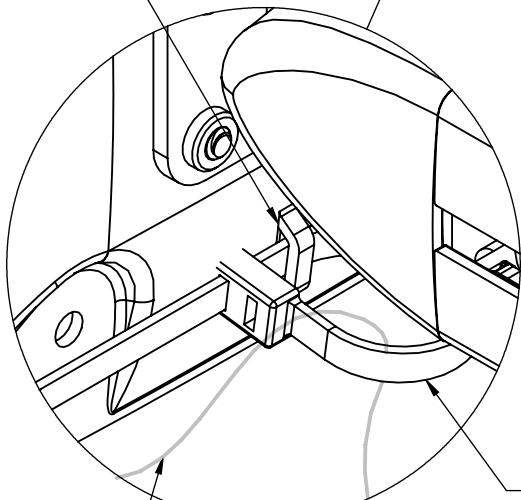

DETAIL B

THE INFORMATION CONTAINED IN THIS DRAWING IS THE SOLE PROPERTY OF HAVIS AND REPRODUCTION IN PART OR IN WHOLE WITHOUT THE WRITTEN PERMISSION OF HAVIS IS PROHIBITED.

DIMS. AND TOLERANCES PER ASME Y14.5 - 1994
UNLESS OTHERWISE SPECIFIED DIMENSIONS ARE IN INCHES TOLERANCES ARE:
FRACTIONAL ± 1/32
2 PLC. DEC. ± .03
3 PLC. DEC. ± .010
ANGULAR ± 0°30'

A			09/23/15	JEB
REV.		DESCRIPTION	DATE	BY
CHK'D				
DRAWN	J. BROWN	<div>HAVIS</div>		
DATE	9/23/2015			
CHECKED				
DATE				
DO NOT SCALE DRAWING		TITLE TECHTOWER, CUSTOMER INSTRUCTIONS, DOUBLE PIVOT, FLAT PANEL MONITOR MOUNT, FIXED POLE CLAMP		
MATERIAL	N/A			
FINISH	N/A			
SIZE	C	DWG. NO.	367-4008-21	REV. A
				SHEET 1 OF 1