

INSTALLATION INSTRUCTIONS

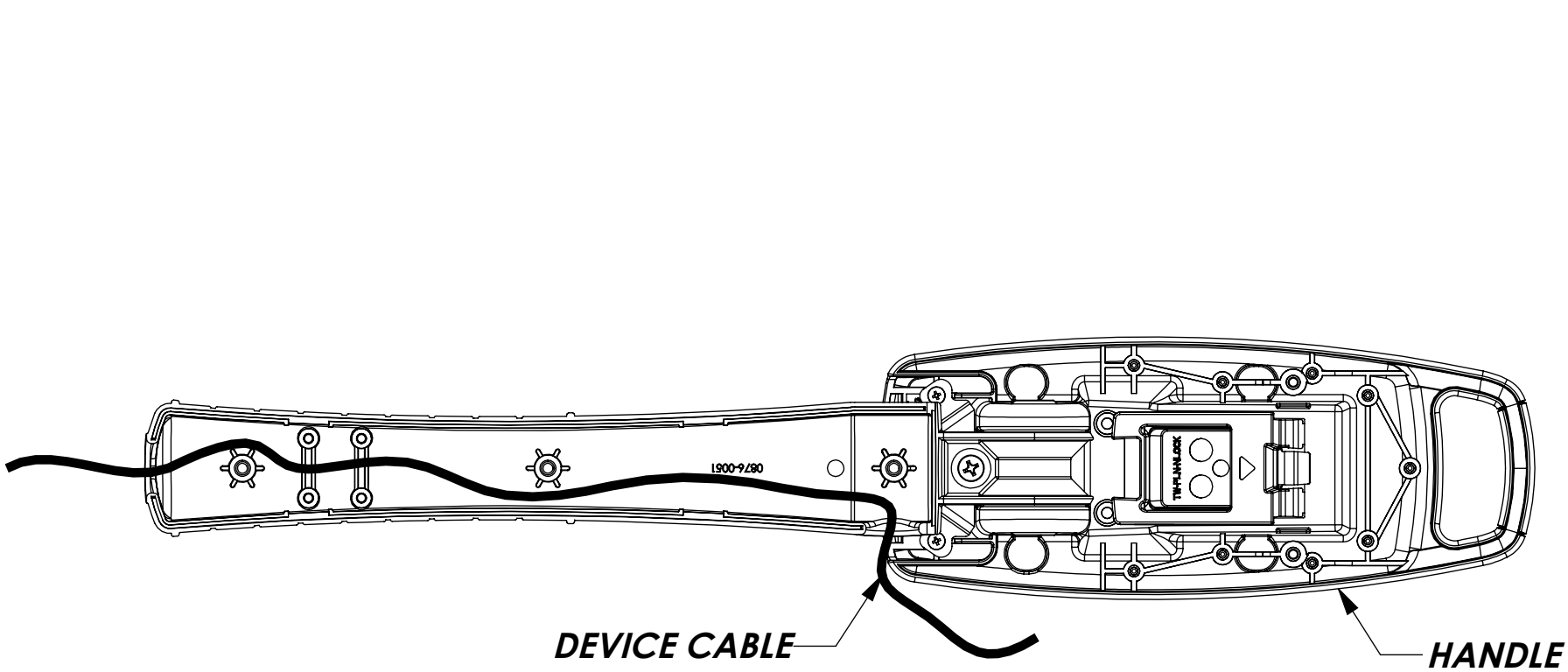

ASSEMBLY STEPS 1-2

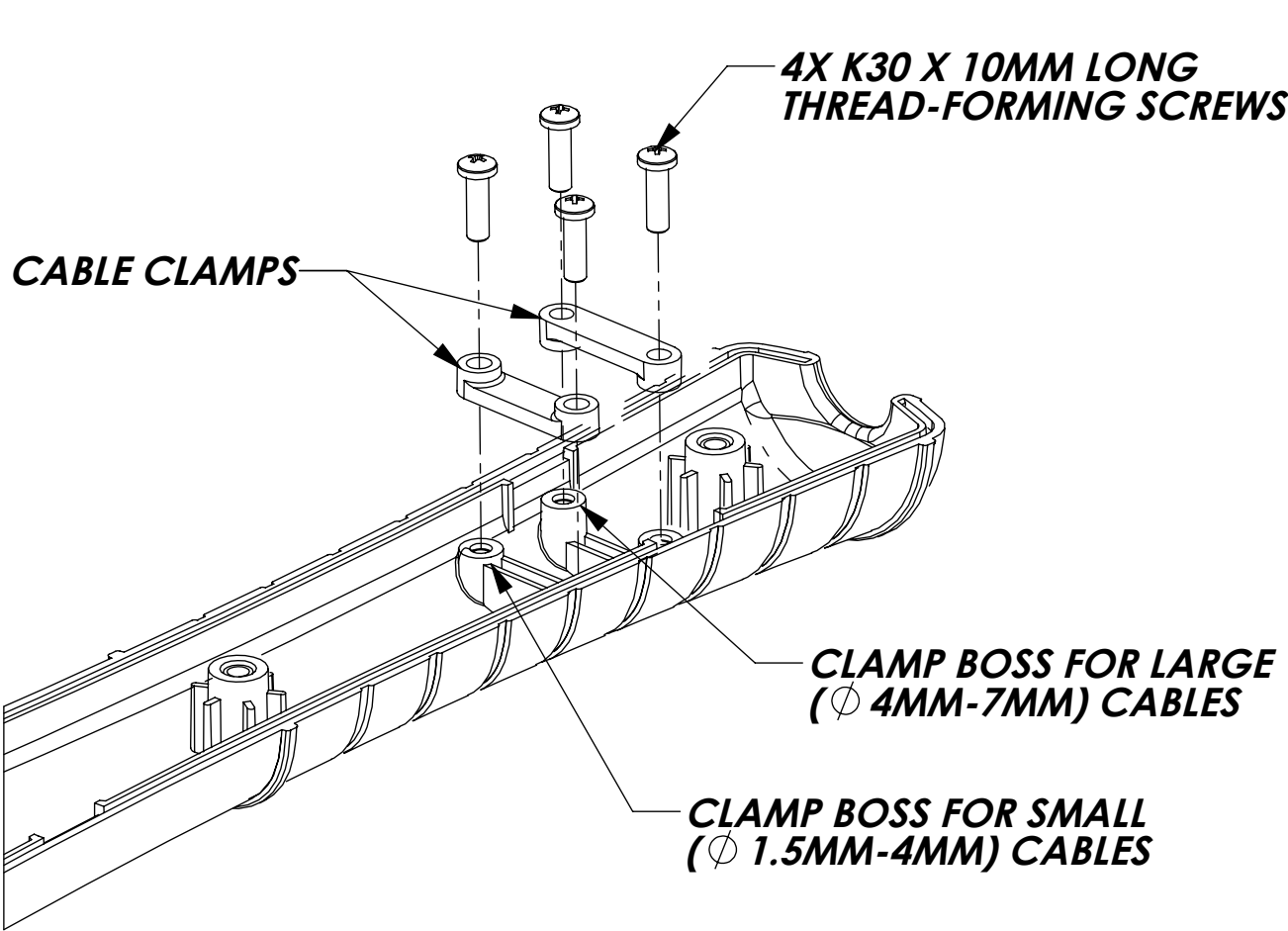

ASSEMBLY STEP 3

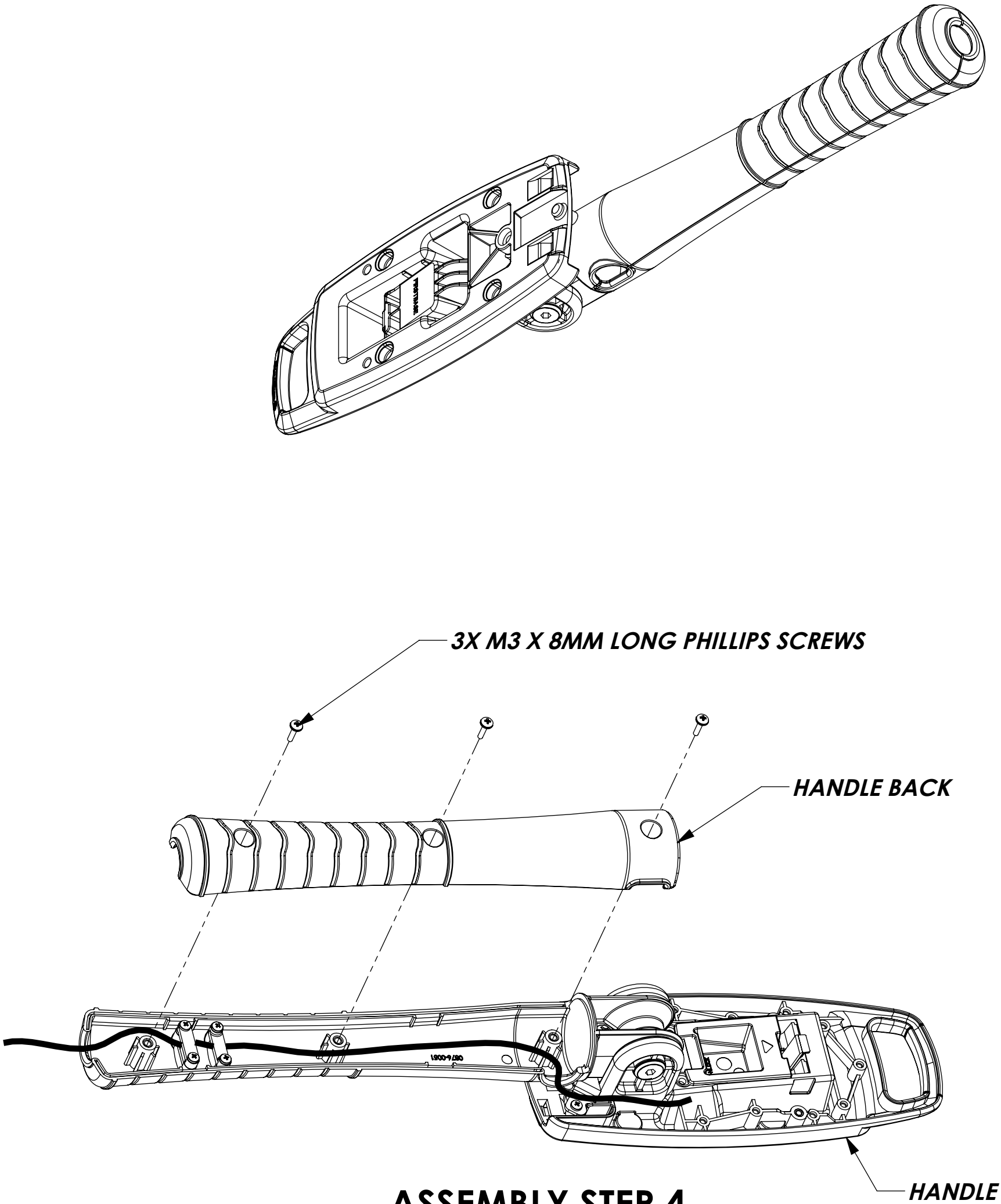

ASSEMBLY STEP 4

- TOOL LIST:
- 1. PZ1 POZI DRIVE SCREW DRIVER
  - 2. #2 SCREW DRIVER

- ASSEMBLY STEPS:
- 1. TO FIT THE BACKPLATE TO THE PAYMENT TERMINAL/PIN PAD, REFERENCE THE BACKPLATE INSTALLATION GUIDE SPECIFIC TO YOUR DEVICE (SOLD SEPARATELY).
  - 2. ROUTE THE **DEVICE CABLE** THROUGH THE **HANDLE** AND AROUND SCREW BOSSES AS SHOWN. ENSURE THE **DEVICE CABLE** IS NOT TOO TIGHT AND HAS SLACK THROUGHOUT.
  - 3. ASSEMBLE **CABLE CLAMPS** TO THE **HANDLE** USING **4X K30 X 10MM LONG THREAD-FORMING SCREWS** AS SHOWN. USE ONE OR BOTH **CABLE CLAMPS** DEPENDING UPON CABLING. **CABLE CLAMPS** MAY BE INSTALLED IN EITHER ORIENTATION SHOWN AS NEEDED. HAND TIGHTEN SCREWS ONLY, ENSURE NOT TO DAMAGE THE CABLE.
  - 4. ASSEMBLE **HANDLE BACK** TO **HANDLE** ASSEMBLY USING **3X M3 X 8MM LONG PHILLIPS SCREWS** AS SHOWN.

THE INFORMATION CONTAINED IN THIS DRAWING IS THE SOLE PROPERTY OF HAVIS AND REPRODUCTION IN PART OR IN WHOLE WITHOUT THE WRITTEN PERMISSION OF HAVIS IS PROHIBITED.

DIMS. AND TOLERANCES PER ASME Y14.5 - 1994  
UNLESS OTHERWISE SPECIFIED  
DIMENSIONS ARE IN INCHES  
TOLERANCES ARE:

FRACTIONAL	± 1/32
2 PLC. DEC.	± .03
3 PLC. DEC.	± .010
ANGULAR	± 0°30'

B	RELEASED FOR PROTOTYPE	03/27/20	ARS	AN
REV.	DESCRIPTION	DATE	BY	CHK'D
DRAWN	A. NORLING	<div>HAVIS</div> <div>TITLE</div> <div>CUSTOMER INSTALLATION, FLEXIPOLE DRIVE-THRU HANDLE</div>		
DATE	03/27/2020			
CHECKED				
DATE				
DO NOT SCALE DRAWING				
MATERIAL				
FINISH		SIZE	DWG. NO.	REV. B
	C	ASSD0121A		SHEET 1 OF 1